

TOOLS FOR ASSEMBLY

9/16" Socket Wrench
 5/8" Open/Box End Wrench
 Carpenter's Square

Parts List

- 1~ 2 ea Base Angle
- 2~ 2 ea Top Angle
- 3~ 2 ea Ungrounded Channel
- 4~ 24 ea 3/8-16 Hex Head Bolts
- 5~ 48 ea 3/8, Paint-cutting Washer
- 6~ 24 ea 3/8-16 Hex Nut
- 7~ 4 ea 1/4-20 Hex Nut
- 8~ 1 ea Base Extension Pan
- 9~ 1 ea Top Extension Pan
- 10~ 2 EA Grounded Channel*
 *Detail E&F

1. Lay two channels (1 grounded & 1 ungrounded) flat on floor, with flanges facing each other.
2. Lay one base angle and one top angle on channels as shown above and hand-start bolts. See Detail A & B. Do not tighten bolts.

3. Repeat steps 1&2 to assemble the other set, while orienting the grounded channels to be diagonally opposite (cadicornered) from each other.

CPI CHATSWORTH PRODUCTS, INC.

800-834-4969 techsupport@chatsworth.com www.chatsworth.com

QUADRARACK, 4 POST STD,
 GROUNDED
 19X29"X7'H

THIS DRAWING CONTAINS PROPRIETARY AND CONFIDENTIAL INFORMATION AND IS PROTECTED BY U.S. AND INTERNATIONAL LAW. UNAUTHORIZED REPRODUCTION, DISCLOSURE OR USE OF THE DRAWING OR THE INFORMATION THEREIN IS EXPRESSLY FORBIDDEN EXCEPT AS AGREED TO IN WRITING BY CHATSWORTH PRODUCTS, INC.

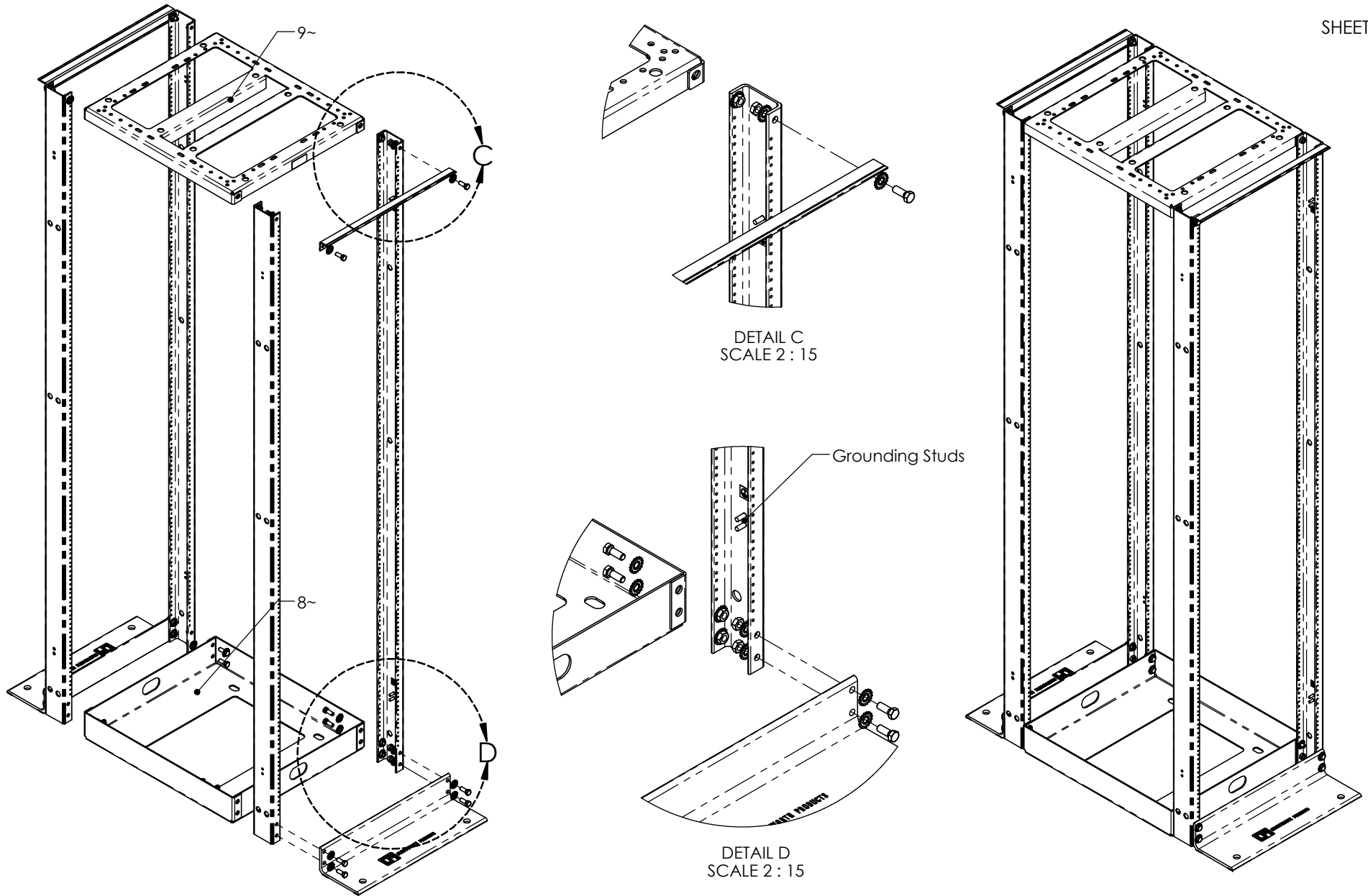

4. Lay both sets flat on floor, about 23" apart.
5. Position one base extension pan, one top extension pan and two horizontal braces.
6. Using Detail C & D to assemble server frame. Hand start bolts, but do not fully tighten yet.
7. Raise the frame.

8. Using a square, align the channels, top angles, and base angles to square. Tighten all bolts securely.
9. Completed server frame may be installed onto floor attachments forward, center or to the rear using an existing base angle.

10. Ground studs are provided in two locations on one of the supports. Optional ground jumper (CPI p/n 40159-008) may be installed in the upper location to exit the top of the rack or the lower location to exit the bottom. Refer to the installation instructions in the ground jumper kit.