

## GENERAL SAFETY GUIDELINES

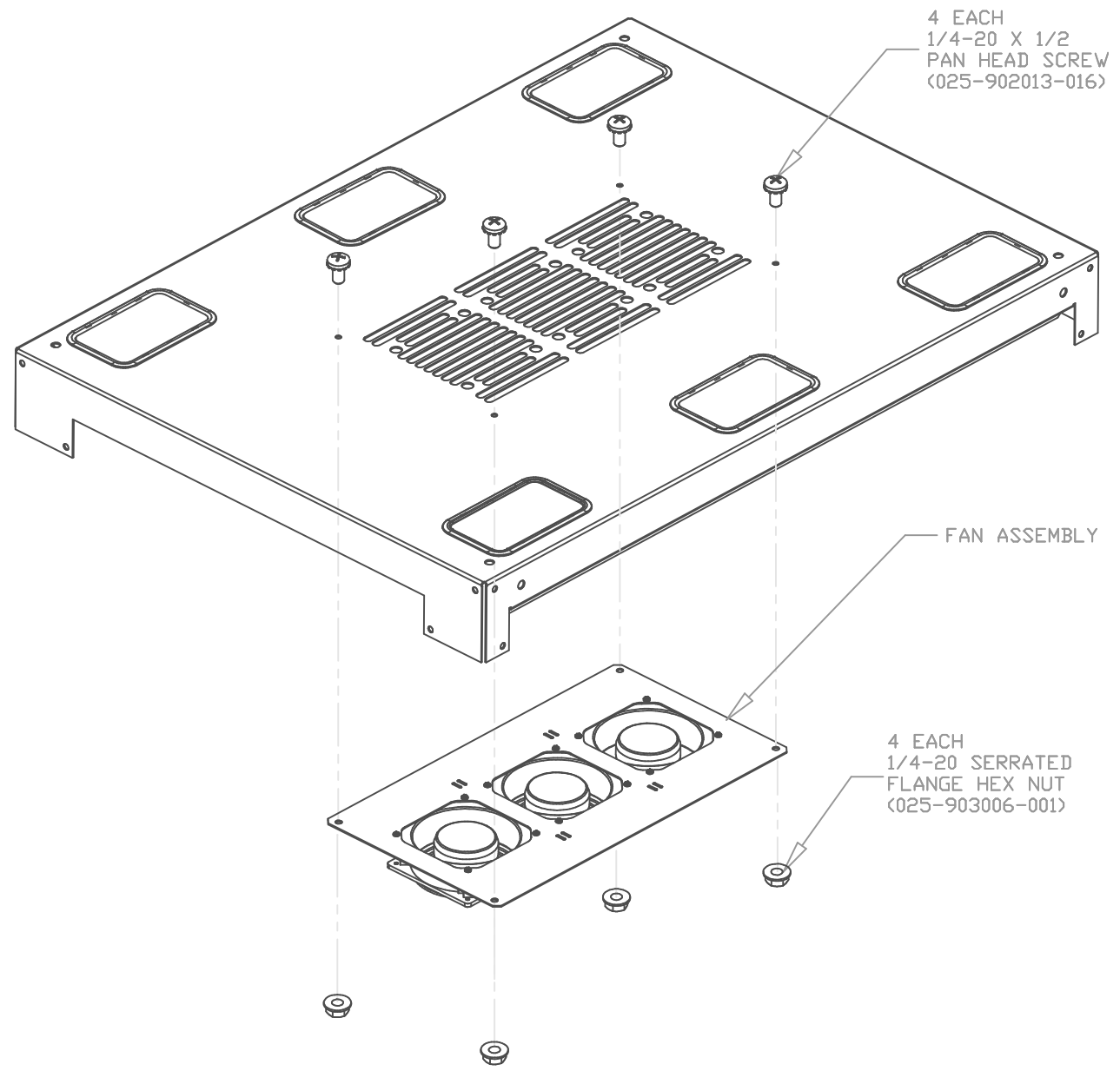

ALWAYS PERSONALLY ENSURE THAT ELECTRICAL POWER HAS BEEN DISCONNECTED BEFORE WORKING ON OR INSTALLING A COMPONENT.

DO NOT PERFORM ANY ACTION THAT MAY CREATE A POTENTIAL HAZARD TO OTHERS OR MAKE EQUIPMENT UNSAFE.

CHECK THE WORK AREA FOR ANY POTENTIAL HAZARDS AND RESOLVE THEM BEFORE BEGINNING ANY WORK.

DO NOT ATTEMPT TO LIFT OBJECTS THAT ARE TOO HEAVY TO BE LIFTED SAFELY BY YOURSELF.

KEEP WALK AREAS CLEAR OF TOOLS AND ASSEMBLY COMPONENTS.

NEVER WORK ALONE WHEN POTENTIALLY HAZARDOUS CONDITIONS EXIST.

DO NOT WEAR LOOSE CLOTHING, JEWELRY, OR ANY OTHER ITEMS THAT MIGHT GET CAUGHT IN THE ASSEMBLY. SECURE ANY DANGLING CLOTHING ACCESSORIES, SUCH AS TIES, SCARVES, OR SLEEVES.

NEVER INSTALL DAMAGED EQUIPMENT.

NOTE: HARDWARE NOT TO SCALE AND FRAMEWORK REMOVED, FOR CLARITY.

 <b>CHATSWORTH PRODUCTS, INC.</b>
<p>INSTALLATION INSTRUCTIONS T-SERIES FAN KIT</p>
<p>THIS DRAWING CONTAINS INFORMATION PROPRIETARY TO CHATSWORTH PRODUCTS, INC. ANY REPRODUCTION DISCLOSURE OR USE OF THIS DRAWING IS EXPRESSLY FORBIDDEN EXCEPT AS AGREED TO IN WRITING BY CHATSWORTH PRODUCTS, INC.</p>