

PACKAGED HARDWARE



CAP SCREW
1/4-20 X 1



LOCK-WASHER
1/4" SPLIT

(16 EACH)

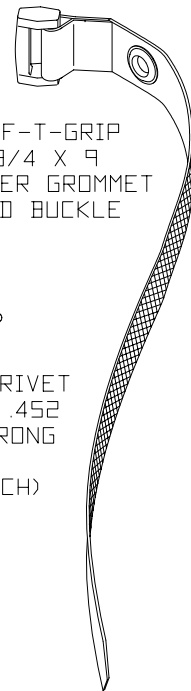

SAF-T-GRIP
3/4 X 9
CENTER GROMMET
AND BUCKLE



NYLON RIVET
.218 X .452
TWO PRONG

(6 EACH)

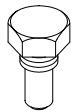

PIVOT BOLT



WASHER
3/8, FLAT

(2 EACH)

NOTE: IT IS ADVISED
THAT WALL-MOUNTED
EQUIPMENT RACKS
BE MOUNTED TO A 3/4"
PLYWOOD BACKBOARD,
SECURELY FASTENED
TO THE WALL STUDS.

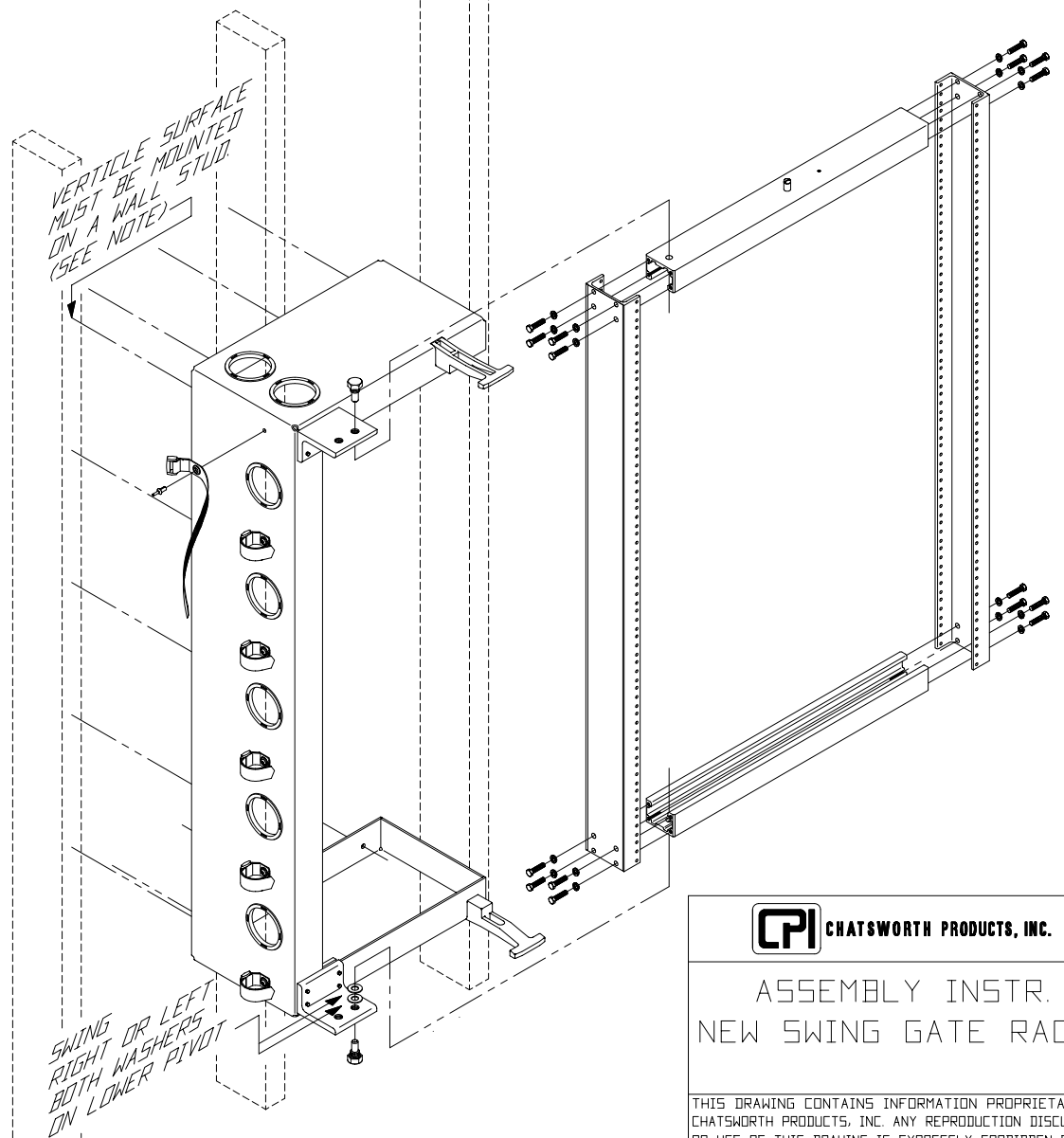

CPI CHATSWORTH PRODUCTS, INC.

ASSEMBLY INSTR.
NEW SWING GATE RACK

THIS DRAWING CONTAINS INFORMATION PROPRIETARY TO CHATSWORTH PRODUCTS, INC. ANY REPRODUCTION, DISCLOSURE OR USE OF THIS DRAWING IS EXPRESSLY FORBIDDEN EXCEPT AS AGREED TO IN WRITING BY CHATSWORTH PRODUCTS, INC.