

Product Cut Sheet

AISLE CONTAINMENT CABINET TO FLOOR SEAL KIT FOR F-SERIES TERAFRAME® GEN 3 CABINET, GF-SERIES GLOBALFRAME® GEN 2 CABINET AND N-SERIES TERAFRAME® GEN 3 NETWORK CABINET

Aisle Containment Cabinet To Floor Seal Kits are used at the bottom of cabinets to seal the space between the bottom of the cabinet and the floor when leveling feet or casters are in use. Eliminating this source of bypass airflow is essential due to the high pressure typically experienced in this area.

- Compatible with F-Series TeraFrame® Gen 3 Cabinets, GF-Series GlobalFrame® Gen 2 Cabinets and N-Series TeraFrame® Gen 3 Cabinets (Cabinets have half-height side panels and top panels with covered cable openings in each corner.)
- Blocks bypass airflow underneath cabinets to prevent leakage from the contained aisle
- Fits snug against cabinets and the floor
- Includes sheet steel covers
- Front and Side Seals are ordered separately
- Use one front seal kit on each cabinet; select to match the overall width of the cabinet
- Use one side seal kit on each cabinet row; select to match the depth of the cabinet/frame

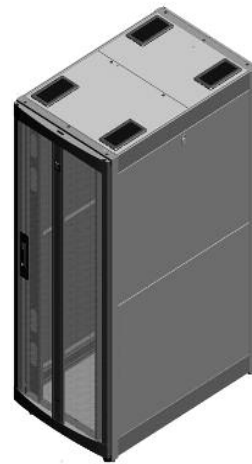

F-Series TeraFrame Gen 3 Cabinet



GF-Series GlobalFrame Gen 2 Cabinet

Aisle Containment Cabinet To Floor Seal Kit for F-Series TeraFrame® Gen 3 Cabinet and GF-Series GlobalFrame® Gen 2 Cabinet		
Part Number & Finish		Description
Black	Glacier White	
Front Seal Kits		
39208-700	39208-E00	Front Seal, For 23.6"W (600 mm) Cabinet
39208-701	39208-E01	Front Seal, For 27.6"W (700 mm) Cabinet
39208-703	39208-E03	Front Seal, For 29.5"W (750 mm) Cabinet
39208-702	39208-E02	Front Seal, For 31.5"W (800 mm) Cabinet
39208-704	39208-E04	Front Seal, For 40.0"W (1016 mm) Cabinet
Side Seal Kits		
39209-700	39209-E00	Side Seal, For 31.5"D (800 mm) frame
39209-701	39209-E01	Side Seal, For 32.5"D (825 mm) frame
39209-702	39209-E02	Side Seal, For 33.5"D (850 mm) frame
39209-703	39209-E03	Side Seal, For 34.4"D (875 mm) frame
39209-704	39209-E04	Side Seal, For 35.4"D (900 mm) frame
39209-705	39209-E05	Side Seal, For 36.4"D (925 mm) frame
39209-706	39209-E06	Side Seal, For 37.4"D (950 mm) frame
39209-707	39209-E07	Side Seal, For 38.4"D (975 mm) frame
39209-708	39209-E08	Side Seal, For 39.4"D (1000 mm) frame
39209-709	39209-E09	Side Seal, For 40.4"D (1025 mm) frame
39209-710	39209-E10	Side Seal, For 41.3"D (1050 mm) frame
39209-711	39209-E11	Side Seal, For 42.3"D (1075 mm) frame
39209-712	39209-E12	Side Seal, For 43.3"D (1100 mm) frame
39209-713	39209-E13	Side Seal, For 44.3"D (1125 mm) frame
39209-714	39209-E14	Side Seal, For 45.3"D (1150 mm) frame
39209-715	39209-E15	Side Seal, For 46.3"D (1175 mm) frame
39209-716	39209-E16	Side Seal, For 47.2"D (1200 mm) frame

Only use P/Ns 39209-X00, -X08, -X10, -X12 and -X16 with GF-Series Cabinets.

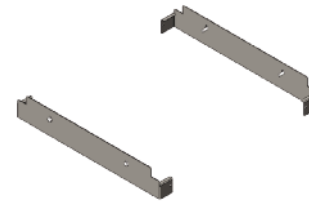

Aisle Containment Cabinet to Floor Front Seal Kit



Aisle Containment Cabinet to Floor Side Seal Kit

800-834-4969 in US & Canada • www.chatsworth.com



CHATSWORTH PRODUCTS

While every effort has been made to ensure the accuracy of all information, CPI does not accept liability for any errors or omissions and reserves the right to change information and descriptions of listed services and products.

©2014 Chatsworth Products, Inc. All rights reserved. Chatsworth Products, CPI, CPI Passive Cooling, eConnect, MegaFrame, Saf-T-Grip, Seismic Frame, SlimFrame, TeraFrame, GlobalFrame, Cube-IT Plus, Evolution, OnTrac, QuadraRack and Velocity are federally registered trademarks of Chatsworth Products. Simply Efficient is a trademark of Chatsworth Products. All other trademarks belong to their respective companies. Rev.2 03/14