

Product Cut Sheet

AISLE CONTAINMENT UNIVERSAL BULB SEAL FOR BUILD TO SPEC KIT

Edge seal used with the Build To Spec Kit Hot Aisle Containment (HAC) Solution to create drop panels over cabinets.

- Attaches to Polycarbonate Panel providing an edge seal for duct drop panels
- Trim length to match site requirements
- Includes: (2) or (10) each, 96" L (2387 mm) bulb seals
- Material: Plastic; bulb is flexible PVC (UL 94HB or UL 94VO), support is rigid PVC (UL 94VO), barbs in support are flexible Alcryn (UL 94HB)
- Flammability Standards: UL 94HB or UL 94VO, see Material
- Finish: Black

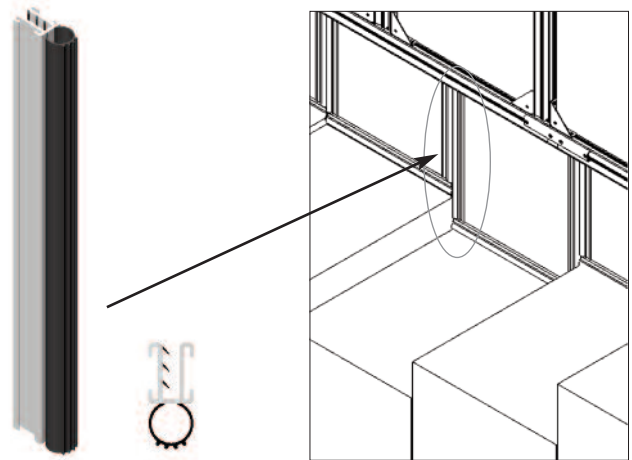

Bulb seal used along the edge of drop panels

Universal Bulb Seal from Full Height Cabinet Blanking Panel		
Part Number	Description	Shipping Weight lb (kg)
33003-001	Universal Bulb Seal, 96" L (2438 mm), Pack of 2	4 (1.8)
33003-002	Universal Bulb Seal, 96" L (2438 mm), Pack of 10	21 (9.5)

Note: Order additional polycarbonate panels and panel retention clips separately if required. See 33000_SERVICE_PARTS_CUT.

800-834-4969 in U.S. & Canada • www.chatsworth.com



CHATSWORTH PRODUCTS

While every effort has been made to ensure the accuracy of all information, CPI does not accept liability for any errors or omissions and reserves the right to change information and descriptions of listed services and products.

©2013 Chatsworth Products, Inc. All rights reserved. CPI, CPI Passive Cooling, GlobalFrame, MegaFrame, Saf-T-Grip, Seismic Frame, SlimFrame, TeraFrame, Cube-iT Plus, Evolution, OnTrac, Velocity and QuadraRack are federally registered trademarks of Chatsworth Products. eConnect and Simply Efficient are trademarks of Chatsworth Products. All other trademarks belong to their respective companies. 12/13