

Installation Instructions

RMR WALL-MOUNT LATCH SYSTEM

Safety Information



WARNING: Improper use of this product may lead to serious injury. Read and understand all instructions for proper installation and use of this product.

Tools Required

M22 Socket Driver
Channel Lock Pliers

Included Hardware

Wing Knob Gasket
L-Handle Gasket and Nut
T-Pawl Gasket and Nut
Hex Rod

Assembly Sequence

Wing Knob Latch Assembly

1. Insert Gasket over threaded body of Latch
2. Insert Latch through hole in door. Lock symbol towards top. Knob should rotate 90 degrees counter-clockwise from vertical.
3. Tighten nut on backside of door. (Torque 18 IN-LB [2 N-M])

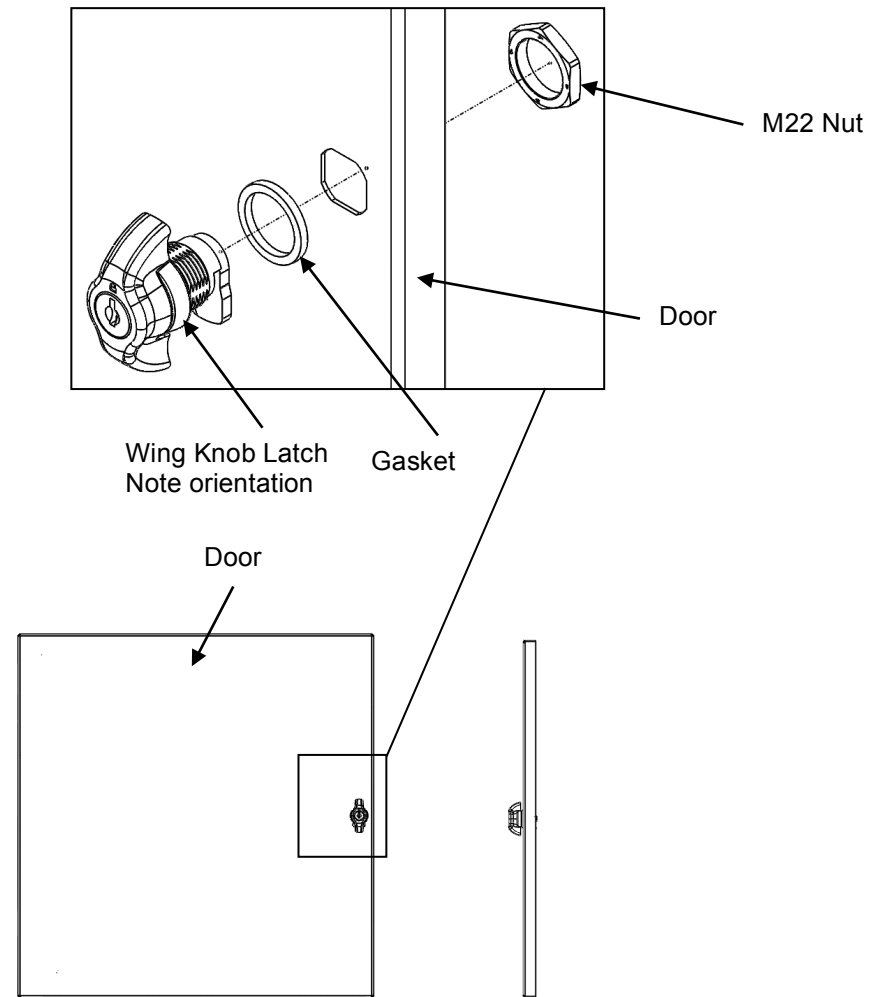

IIS-737xxx, 09/16/16, Rev. 1, CPI/SJG
800-834-4969 (USA & Canada) • www.chatsworth.com • techsupport@chatsworth.com
For international phone numbers, see our website or contact CPI Tech Support.

This drawing contains proprietary and confidential information and is protected by U.S. and international law. Unauthorized reproduction, disclosure or use of the drawing or the information therein is expressly forbidden except as agreed to in writing by Chatsworth Products, Inc.

Installation Instructions

RMR WALL-MOUNT LATCH SYSTEM

L-Handle Assembly

1. Insert Gasket over threaded body of L-Handle.
2. Insert L-Handle through hole in Cabinet. L-Handle should rotate 90 degrees counter-clockwise from orientation shown.
3. Assemble Washer and Nut on inside of cabinet. Tighten nut. (Torque 88 IN-LB [10 N-M])
4. Verify Wing Knob Latch on Front Door engages properly.

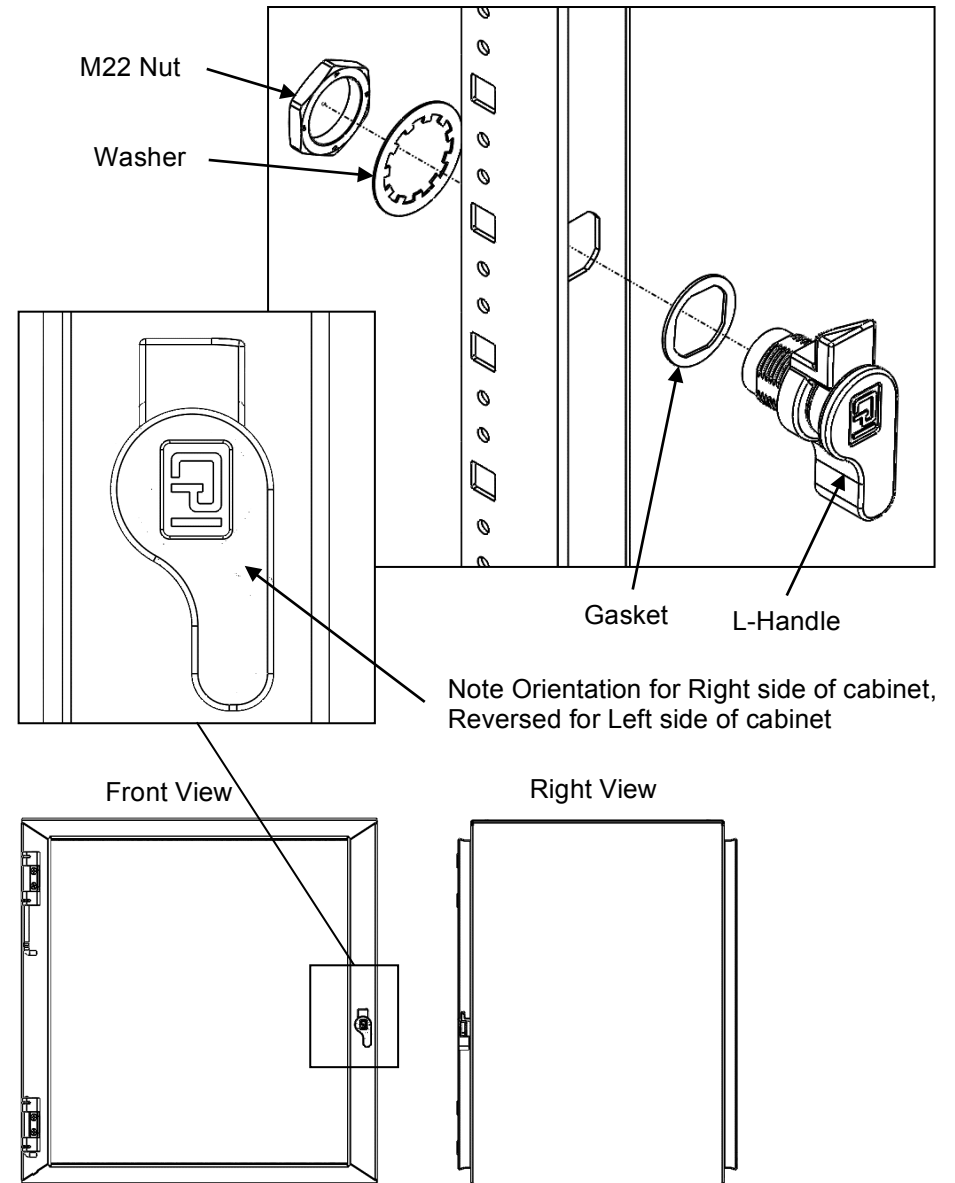

Installation Instructions

RMR WALL-MOUNT LATCH SYSTEM

T-Pawl Assembly

1. Insert Gasket over threaded body of T-Pawl.
2. Insert T-Pawl through hole in Cabinet and onto Hex Rod, such that proper orientation is maintained. Rib on T-Pawl housing should be at the top. T-Pawl should rotate 90 degrees clockwise from orientation shown.
3. Assemble Washer and Nut on inside of cabinet. Tighten nut. (Torque 88 IN-LB [10 N-M])
4. Verify T-Pawl properly engages Rear Catch on Rear Chassis.

