

NOTE:
UPPER CROSS MEMBERS
ARE MARKED "TOP"

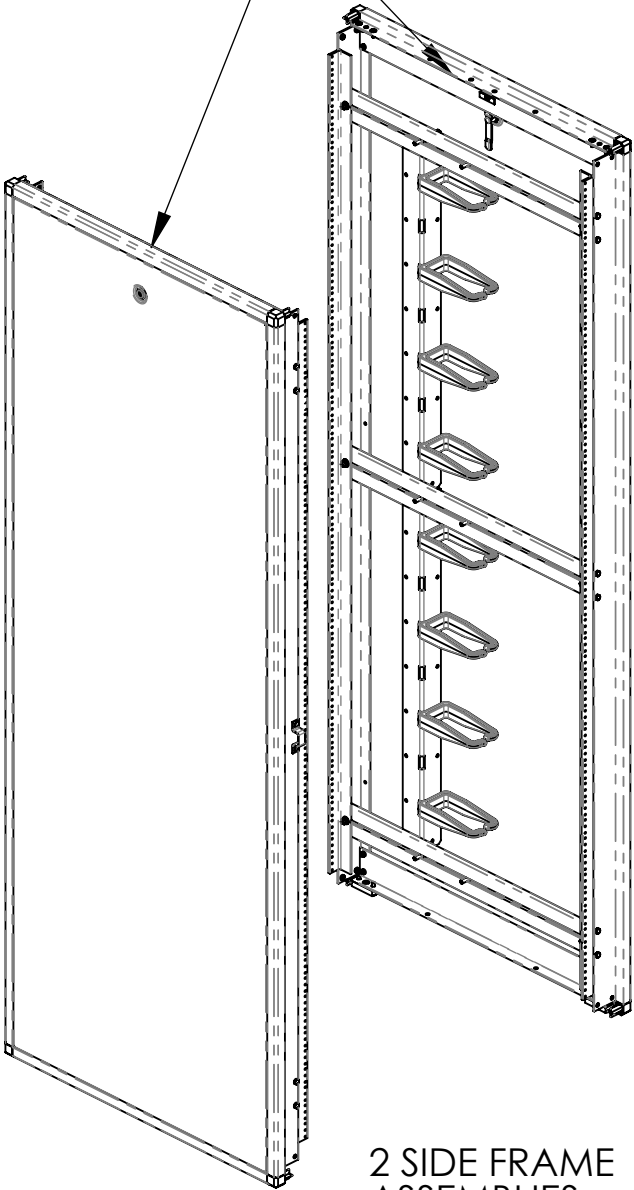

2 SIDE FRAME
ASSEMBLIES

VENTED TOP - OR - SOLID TOP

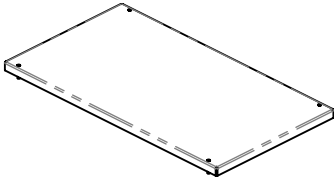
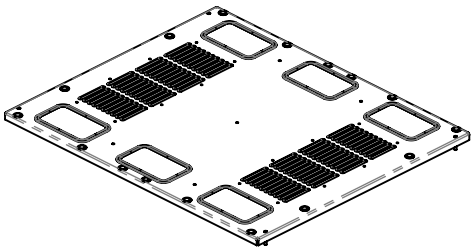

NOTE:
SOME CONFIGURATIONS
OF SOLID TOP INCLUDE
TOP SUPPORT MEMBERS.

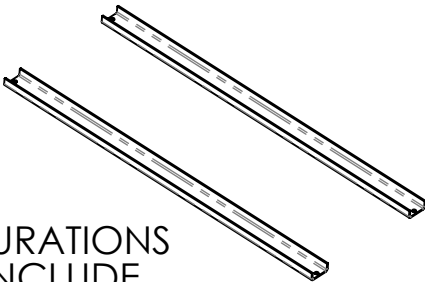

2 UPPER FRAME
CROSS MEMBERS

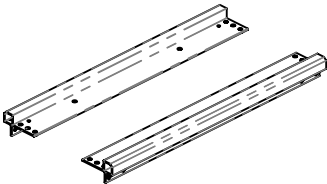

NOTE:
4 CASTER MOUNTING
HOLES IN EACH END
OF LOWER FRAME
CROSS MEMBERS

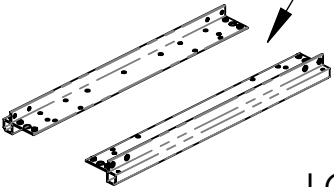

LOWER FRAME
CROSS MEMBER
FRONT & REAR

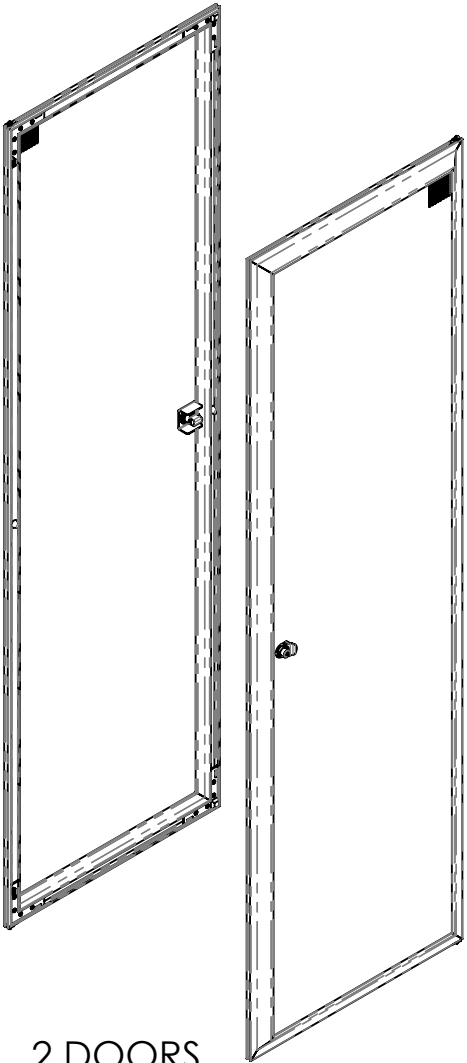

2 DOORS



CHATSWORTH PRODUCTS, INC.

800-834-4969 techsupport@chatsworth.com www.chatsworth.com

MEGAFRAME CABINET ASSEMBLY INSTRUCTIONS

THIS DRAWING CONTAINS PROPRIETARY AND CONFIDENTIAL INFORMATION AND IS PROTECTED BY U.S. AND INTERNATIONAL LAW. UNAUTHORIZED REPRODUCTION, DISCLOSURE OR USE OF THE DRAWING OR THE INFORMATION THEREIN IS EXPRESSLY FORBIDDEN EXCEPT AS AGREED TO IN WRITING BY CHATSWORTH PRODUCTS, INC.

LEVELING FOOT ASSEMBLY
TO
BOTTOM/SIDE ASSEMBLIES

8 EACH
1/4-20 X 1
HEX-HEAD,
CAP SCREW
(025-020290-108)

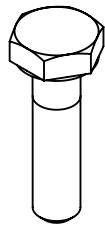

4 EACH
1/2-13, HEX,
JAM NUT
(025-903002-005)

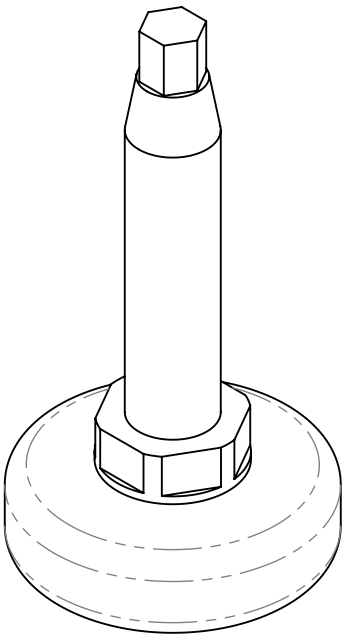
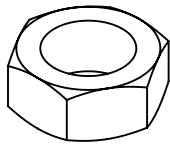

4 EACH
1/2-13 X 2.5,
LEVELING FOOT
(025-908052-002)

CROSS MEMBERS
TO
SIDE ASSEMBLIES

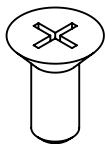

24 EACH
1/4-20 X 5/8,
CROSS RECESS
FLAT-HEAD
SCREW
(025-902013-004)

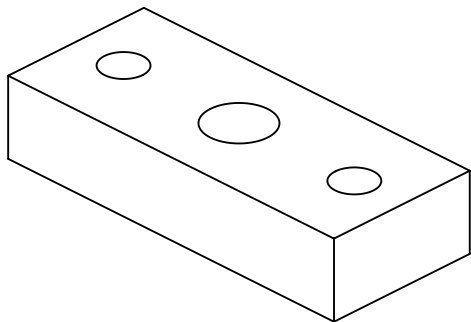

4 EACH
LEVELING BLOCK
(020-712357-001)

TOP
TO
FRAMEWORK

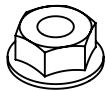

4 EACH
10/32,
SERRATED,
FLANGE NUT
(025-903006-003)

NOTE:
SOME CABINETS INCLUDE OTHER
HARDWARE

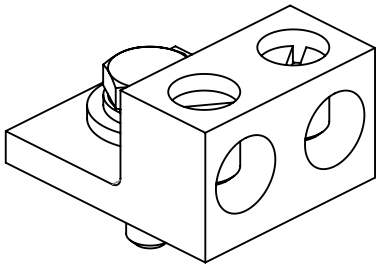

MF GROUNDING
ACCY KIT
(025-715010-152)

FRAMEWORK
TO
FRAMEWORK
(BAYING)

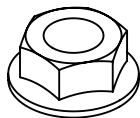

5/16-18 SERRATED
FLANGE NUT
(025-903006-005)

DOORS
TO
FRAMEWORK

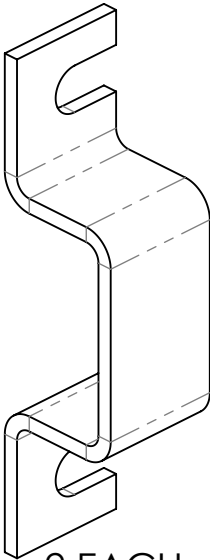

2 EACH
DOOR CATCH
(020-712438-001)

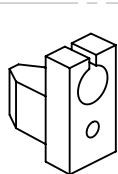

4 PRE-INSTALLED,
DOOR-PIN
LOCK
(035-712353-001)



DOOR-LOCK KEYS
(025-908014-009)

FRAMEWORK
TO
FLOOR

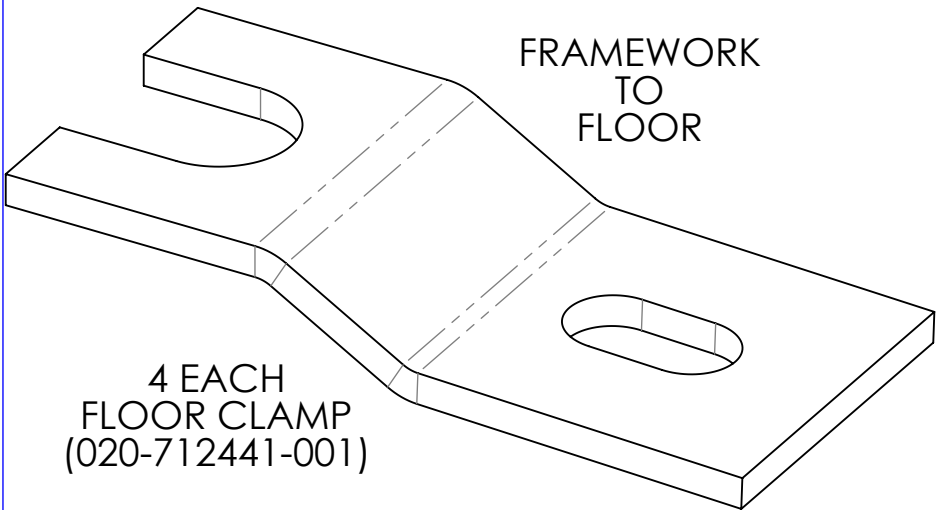

4 EACH
FLOOR CLAMP
(020-712441-001)

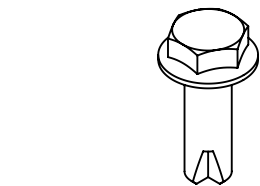

8 EACH
1/4-14 X 3/4 HEX
WASHER HEAD SCREW
(025-902005-004)

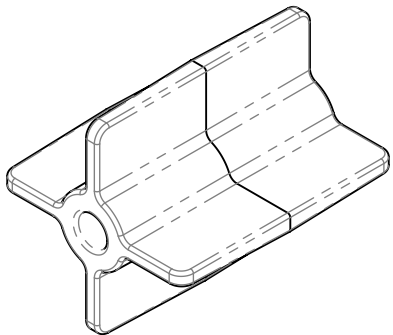

4 EACH
COUPLER
(035-712448-001)

RAIL MOUNTING HARDWARE INCLUDED
TO MATCH RAIL CONFIGURATION ORDERED
ADDITIONAL HARDWARE MAY BE ORDERED SEPARATELY

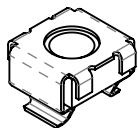

CHATSWORTH PRODUCTS, INC.

800-834-4969 techsupport@chatsworth.com www.chatsworth.com

PACKAGED HARDWARE
MEGAFRAME CABINET
ASSEMBLY INSTRUCTIONS

THIS DRAWING CONTAINS PROPRIETARY AND CONFIDENTIAL
INFORMATION AND IS PROTECTED BY U.S. AND INTERNATIONAL
LAW. UNAUTHORIZED REPRODUCTION, DISCLOSURE OR USE OF THE
DRAWING OR THE INFORMATION THEREIN IS EXPRESSLY FORBIDDEN
EXCEPT AS AGREED TO IN WRITING BY CHATSWORTH PRODUCTS, INC.

REMEMBER:
4 CASTER MOUNTING HOLES
IN EACH END OF LOWER
FRAME CROSS MEMBERS.

ATTACH GROUNDING LUG KIT
TO CENTER HOLE OF FRONT
FRAME CROSS MEMBER

PACKING
MATERIAL
CUSHIONING.

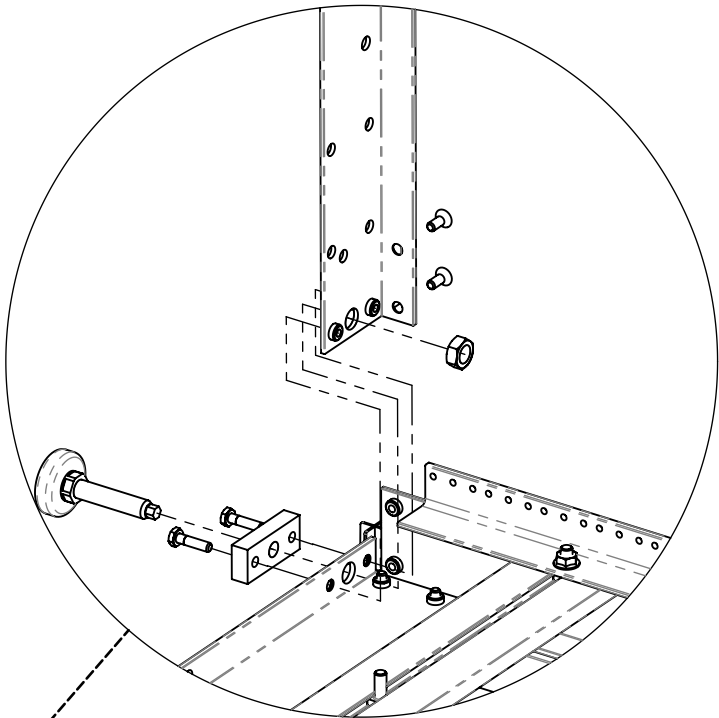

SCALE: 1 / 5

ATTACH CROSS MEMBERS
TO SIDE ASSEMBLY.
(AS SHOWN)
ADDING STANDARD LEVELING
FEET OR OPTIONAL CASTERS
WITH EXTENDED LEVELERS

REMEMBER,
UPPER FRAME
MARKED "TOP"

USE: 12, 1/4-20 X 5/8
CROSS-RECESS,FLAT-HEAD SCREWS
AT ALL BUT BOTTOM END. (SEE BELOW)

NOTE: FOR EASE OF ASSEMBLY, DO NOT
TIGHTEN SCREWS FULLY UNTIL THE
SECOND SIDE PANEL IS IN PLACE.

AT THE BOTTOM END; SCREW TWO LEVELING
FEET ABOUT HALFWAY THROUGH TWO LEVELING
BLOCKS AND THEN ON THROUGH THE BASE HOLES,
AS SHOWN, ADD HEX JAM NUTS TO THE ENDS. SECURE
EACH BLOCK WITH TWO 1/4-20 X 1 HEX-HEAD CAP SCREWS.



CHATSWORTH PRODUCTS, INC.
800-834-4969 techsupport@chatsworth.com www.chatsworth.com

MEGAFRAME CABINET
ASSEMBLY INSTRUCTIONS

THIS DRAWING CONTAINS PROPRIETARY AND CONFIDENTIAL
INFORMATION AND IS PROTECTED BY U.S. AND INTERNATIONAL
LAW. UNAUTHORIZED REPRODUCTION, DISCLOSURE OR USE OF THE
DRAWING OR THE INFORMATION THEREIN IS EXPRESSLY FORBIDDEN
EXCEPT AS AGREED TO IN WRITING BY CHATSWORTH PRODUCTS,INC.

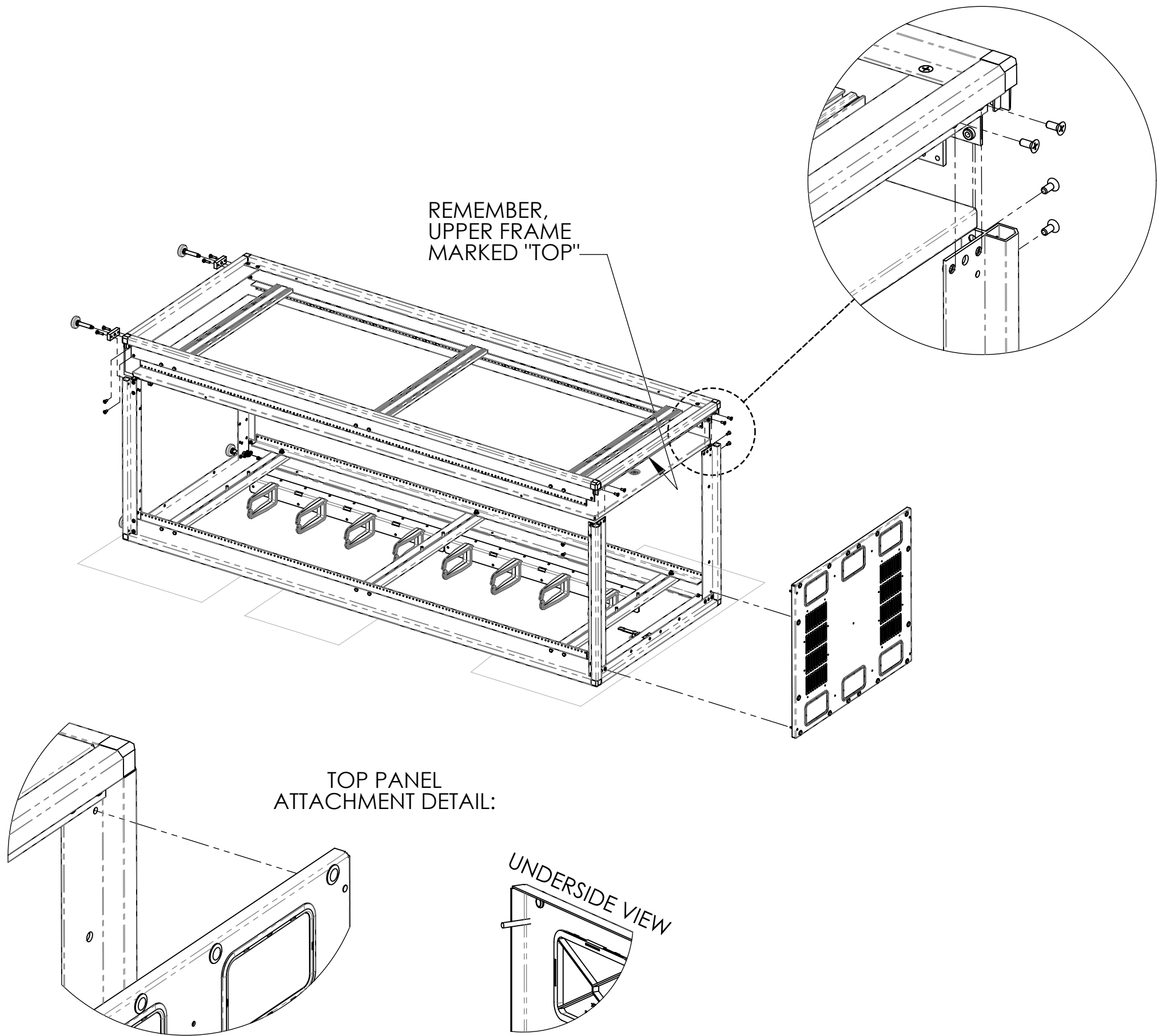

SAME INSTRUCTIONS AS PREVIOUS PAGE.
USE: 12, 1/4-20 X 5/8
CROSS-RECESS, FLAT-HEAD SCREWS
AT ALL BUT BOTTOM END. (SEE LEFT)

AT THE BOTTOM END, SCREW TWO MORE
LEVELING FEET THROUGH TWO MORE
LEVELING BLOCKS AND ON THROUGH THE
BASE HOLES, AS SHOWN BEFORE. ADD HEX
JAM NUTS TO ENDS AND SECURE BLOCKS
WITH TWO EACH HEX-HEAD CAP SCREWS.

NOTE: ONCE THE ASSEMBLY AND SCREWS
ARE IN PLACE, TIGHTEN ALL SCREWS
(UPPER AND LOWER) FULLY.

ATTACH TOP PANEL ASSEMBLY USING
FOUR 10-32 FLANGE NUTS FROM INSIDE
OF FRAME.

NOTE: IF OPTIONAL FAN ASSEMBLY
IS TO BE ADDED, MOUNT IT TO
THE UNDER-SIDE OF THE TOP,
(FOLLOWING THE FAN INSTALLATION
INSTRUCTIONS) BEFORE INSTALLING
THE TOP.

 CHATSWORTH PRODUCTS, INC.
800-834-4969 techsupport@chatsworth.com www.chatsworth.com

MEGAFRAME CABINET ASSEMBLY INSTRUCTIONS

THIS DRAWING CONTAINS PROPRIETARY AND CONFIDENTIAL
INFORMATION AND IS PROTECTED BY U.S. AND INTERNATIONAL
LAW. UNAUTHORIZED REPRODUCTION, DISCLOSURE OR USE OF THE
DRAWING OR THE INFORMATION THEREIN IS EXPRESSLY FORBIDDEN
EXCEPT AS AGREED TO IN WRITING BY CHATSWORTH PRODUCTS, INC.

1. REMOVE PIN-LOCK FROM UPPER INSIDE DOOR, SLIDE PIN DOWN INTO FRAME.

2. INSERT LOWER EXTENDED PIN INTO HOLE IN LOWER RIGHT DOOR SILL (SEE BELOW RIGHT).

3. FIT DOOR INTO FRAME, AND SLIDE UPPER PIN INTO PLACE AND REPLACE DOOR-PIN LOCK (SEE RIGHT ABOVE).

4. LOOSEN MIDDLE FRAME SIDE BOLTS, INSERT DOOR LATCH AS SHOWN ABOVE AND TIGHTEN BOLTS. ADJUST AS NEEDED.

5. NOW, LOOSEN NUTS ON EQUIPMENT MOUNTING ANGLES, AND PLACE WHERE DESIRED, BUT NOT LESS THAN ONE INCH FROM EACH END (SEE SLIDE MARKERS).

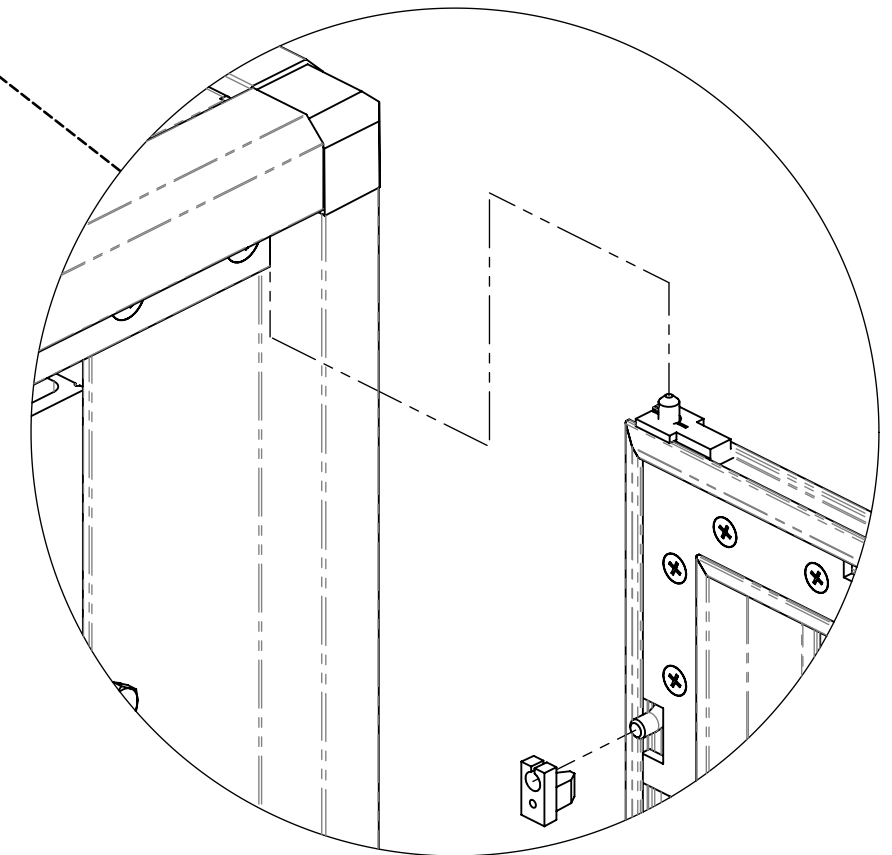
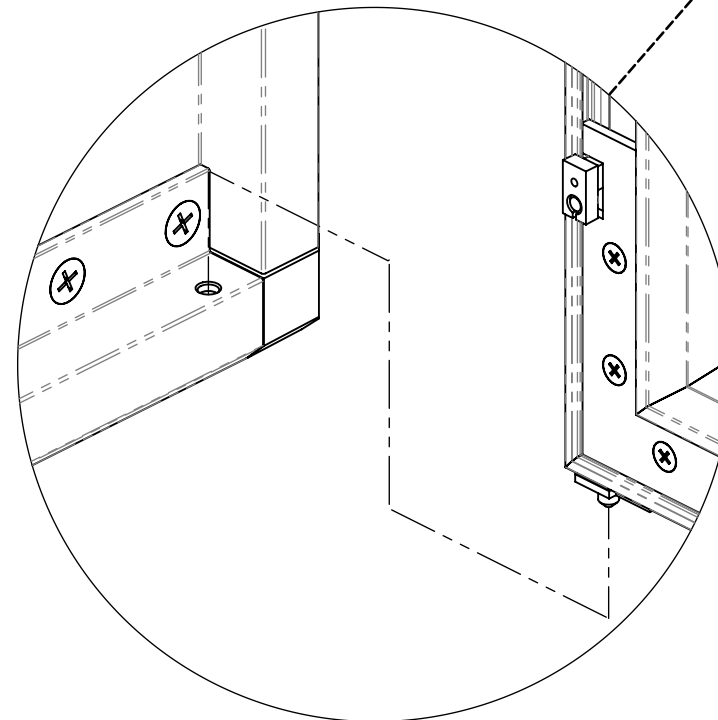
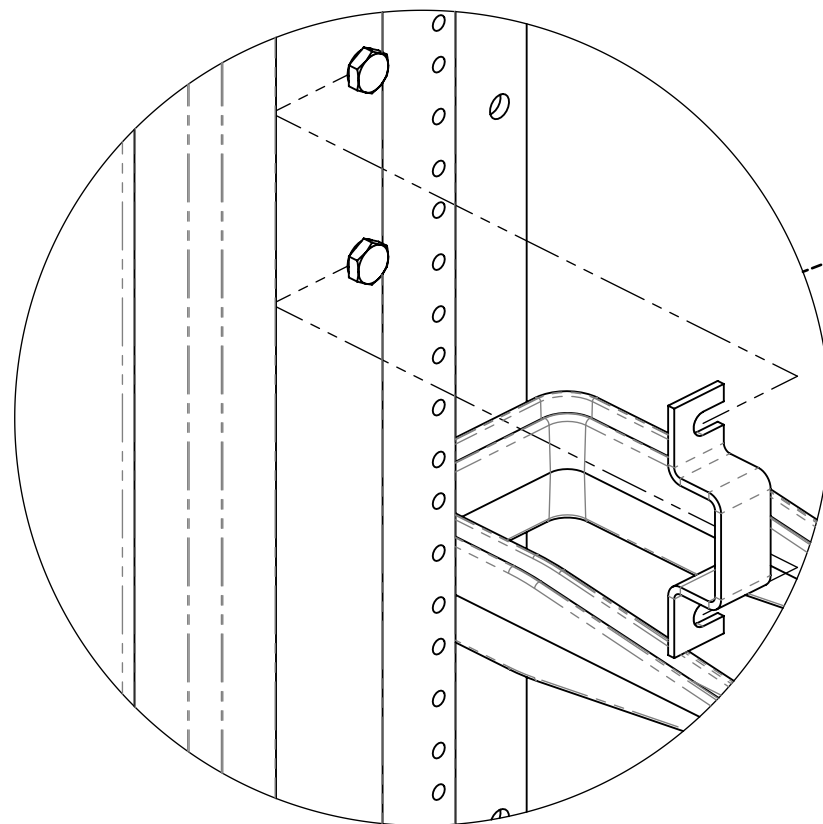
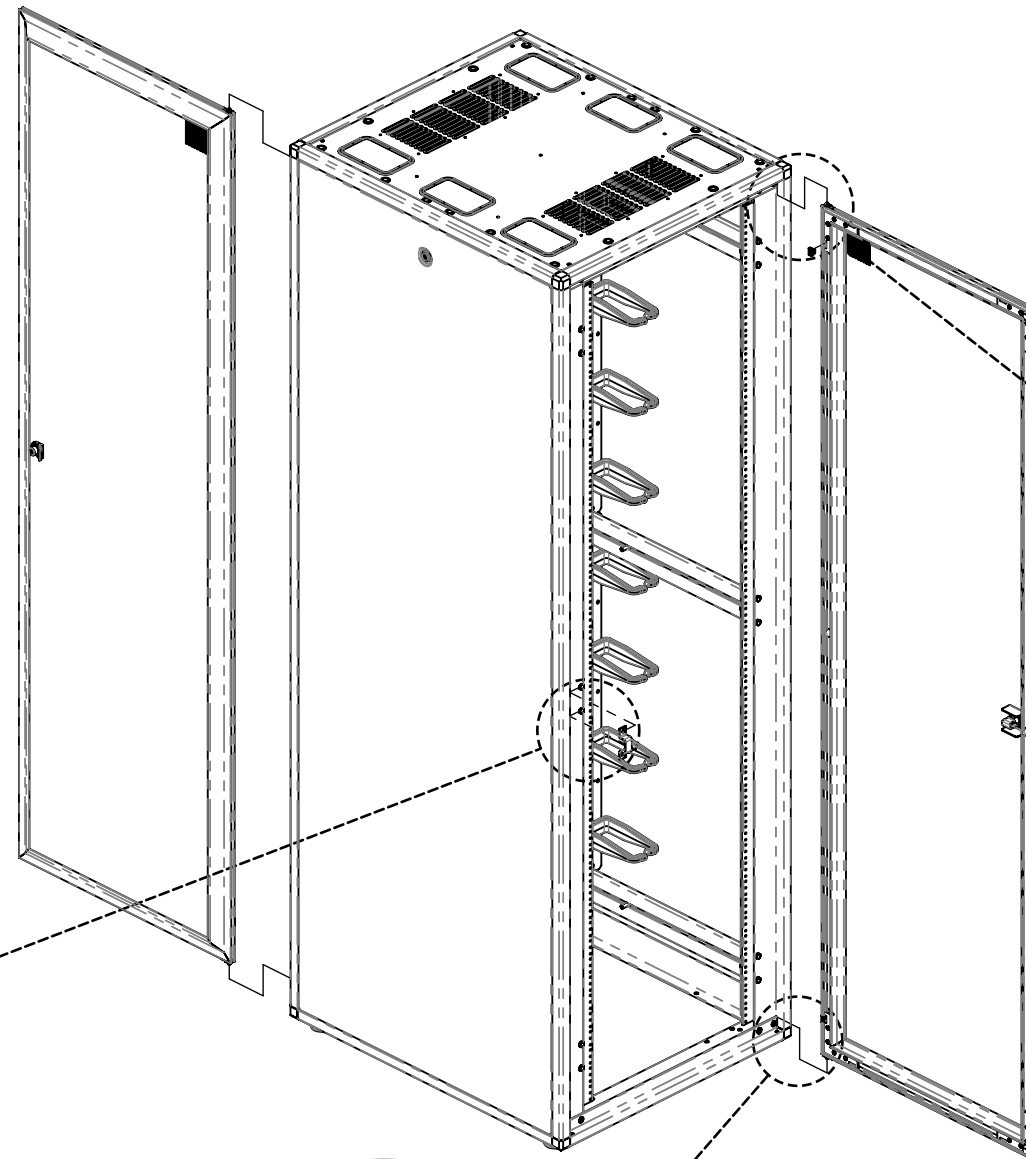

NOTE: TO REVERSE THE DOOR SWING:

TURN THE DOOR OVER, TOP TO BOTTOM.
MOUNT DOOR ON OPPOSITE SIDE OF FRAME.
MOUNT DOOR CATCH ON OPPOSITE SIDE.



CHATSWORTH PRODUCTS, INC.

800-834-4969 techsupport@chatsworth.com www.chatsworth.com

MEGAFRAME CABINET ASSEMBLY INSTRUCTIONS

THIS DRAWING CONTAINS PROPRIETARY AND CONFIDENTIAL INFORMATION AND IS PROTECTED BY U.S. AND INTERNATIONAL LAW. UNAUTHORIZED REPRODUCTION, DISCLOSURE OR USE OF THE DRAWING OR THE INFORMATION THEREIN IS EXPRESSLY FORBIDDEN EXCEPT AS AGREED TO IN WRITING BY CHATSWORTH PRODUCTS, INC.

TO REMOVE SIDE PANEL:

UNLOCK SIDE PANEL LOCK, TILT TOP OF PANEL 10 DEGREES AWAY FROM CABINET AND LIFT PANEL.

TO INSTALL SIDE PANEL:
TILT TOP OF PANEL 10 DEGREES AWAY FROM CABINET AND GUIDE THE BOTTOM (PANEL) TABS OVER THE SPRING CLIP TABS. ROTATE PANEL TOWARD CABINET UNTIL FLUSH WITH THE OUTER FRAME AND LOCK INTO POSITION.

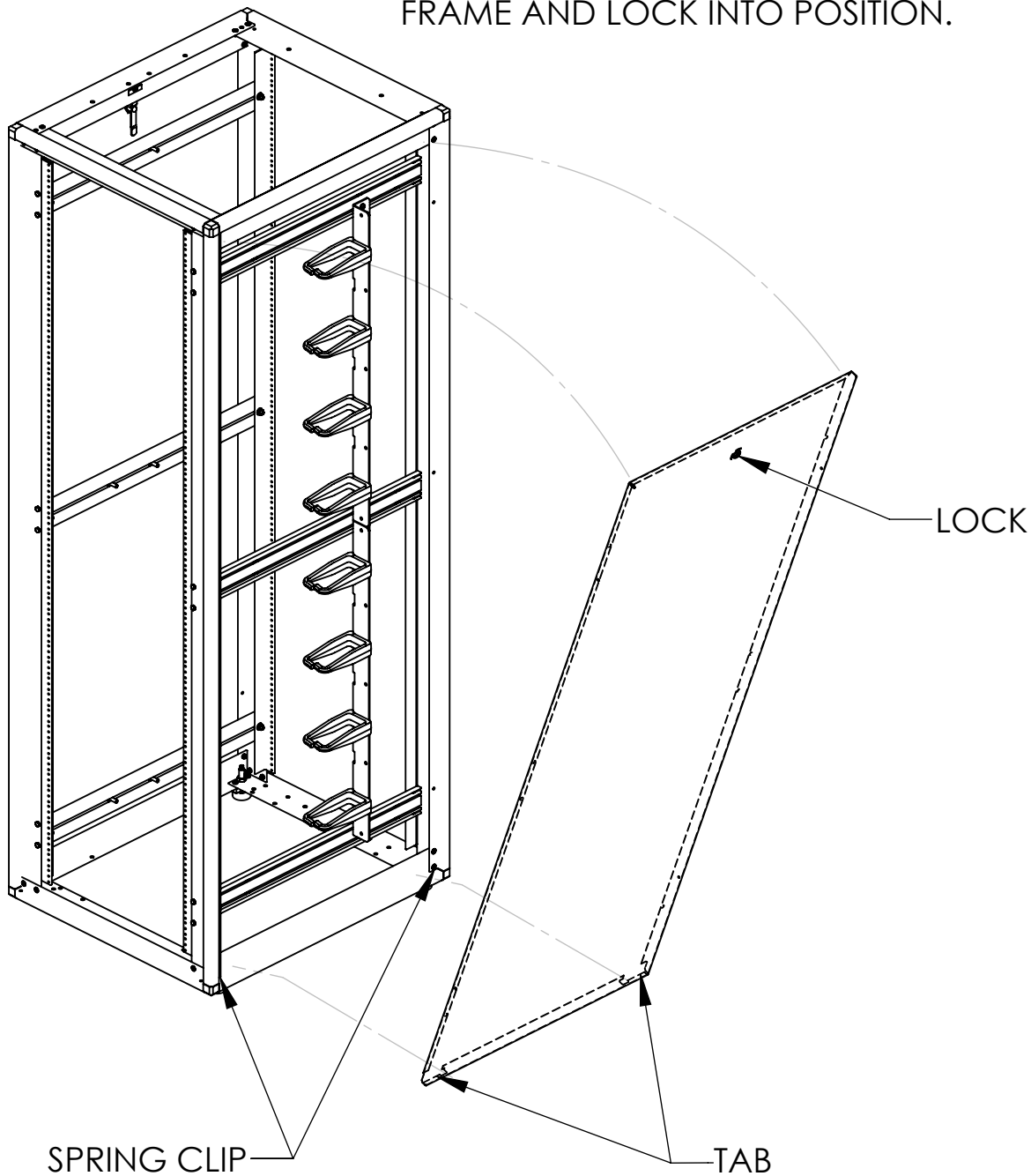

TO INSTALL FLOOR CLAMPS

1. INSTALL FLOOR CLAMPS FROM INSIDE THE FRAMEWORK (AS SHOWN BELOW). CAPTURING EACH OF THE FOUR LEVELING BOLTS. ATTACH TO THE FLOOR WITH APPROPRIATE HARDWARE FOR YOUR TYPE OF FLOOR.

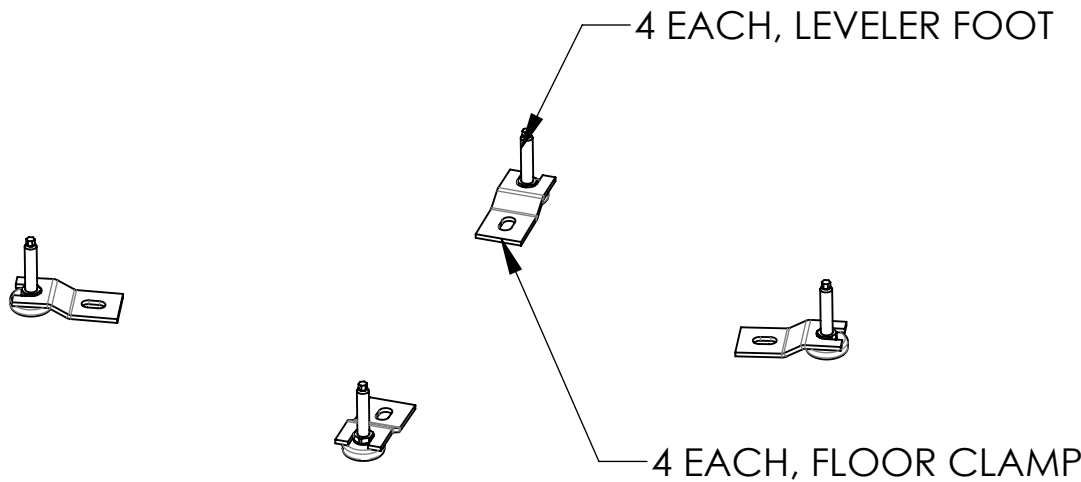



CHATSWORTH PRODUCTS, INC.
800-834-4969 techsupport@chatsworth.com www.chatsworth.com

MEGAFRAME CABINET
ASSEMBLY INSTRUCTIONS

THIS DRAWING CONTAINS PROPRIETARY AND CONFIDENTIAL INFORMATION AND IS PROTECTED BY U.S. AND INTERNATIONAL LAW. UNAUTHORIZED REPRODUCTION, DISCLOSURE OR USE OF THE DRAWING OR THE INFORMATION THEREIN IS EXPRESSLY FORBIDDEN EXCEPT AS AGREED TO IN WRITING BY CHATSWORTH PRODUCTS, INC.