

Installation Instructions

eConnect Electronic Access Control

**F-Series TeraFrame,
GF-Series GlobalFrame,
N-Series TeraFrame,
Double Perforated,
Single, Solid Door with Gaskets**

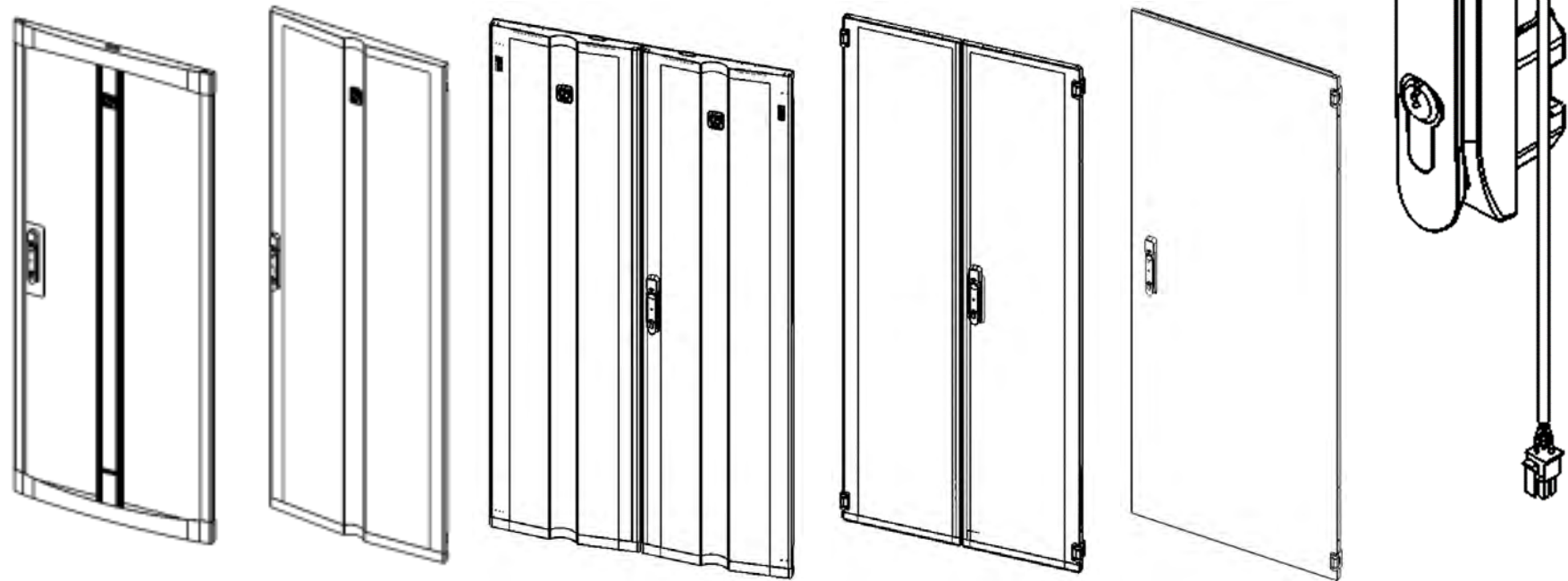

IIS-736650, 02/22/17, Rev. 1, CPI/RBF
800-834-4969 (USA & Canada) • www.chatsworth.com •
techsupport@chatsworth.com
For international phone numbers, see our website or contact CPI Tech Support.

Installation Instructions

eConnect Electronic Access Control – F-Series TeraFrame Cabinet

Includes:

025-907002-006	CLIP,CBL,ADH,BK
025-908040-009	BUSH,.437ID MAX,.125 PNL
020-736643-001	SNAP,EXTRUSION,BK
020-736644-X01	BRKT,DOOR SW,MNTG
025-907011-137	LATCH ASSEMBLY,5V
025-907011-138	CAN BUS MODULE ASSEMBLY,5V
025-907011-139	Y-HARNESS,24 GAUGE,2 METERS,BLACK
025-907011-141	PATCH CABLE,3 METERS,BLACK
025-907011-143	DOOR SWITCH KIT,BLACK
025-907011-154	PROX CARD,ELS,CPI,20 PK

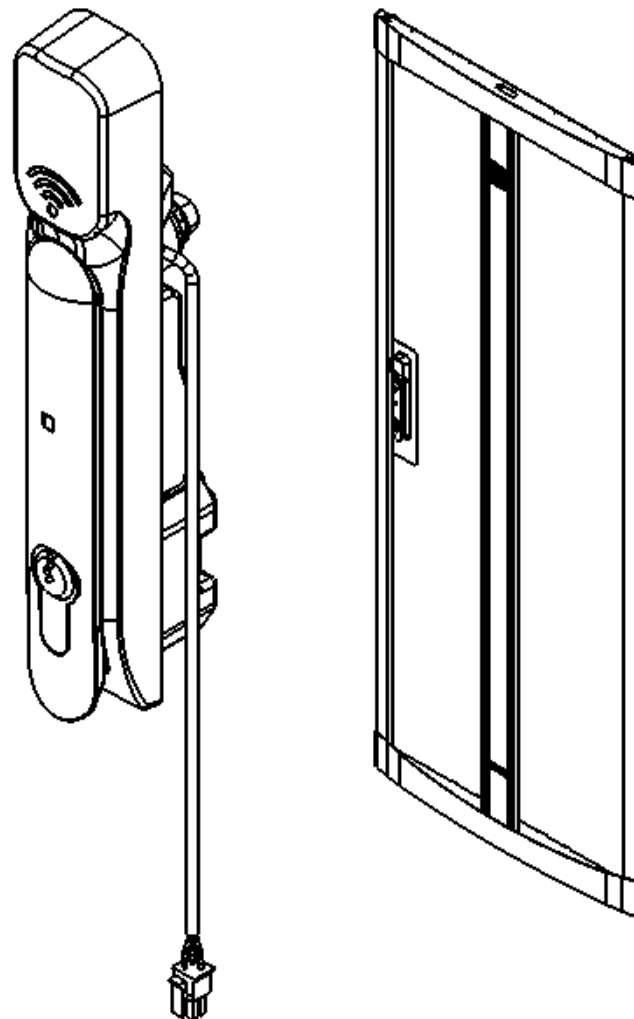

IIS-736650, 02/22/17, Rev. 1, CPI/RBF

800-834-4969 (USA & Canada) • www.chatsworth.com • techsupport@chatsworth.com

For international phone numbers, see our website or contact CPI Tech Support.

This drawing contains proprietary and confidential information and is protected by U.S. and international law. Unauthorized reproduction, disclosure or use of the drawing or the information therein is expressly forbidden except as agreed to in writing by Chatsworth Products, Inc.

Installation Instructions

eConnect Electronic Access Control – F-Series TeraFrame Cabinet

ASSEMBLY SEQUENCE

1. Mount latch to door
2. Mount magnet to door
3. Mount CAN bus module to frame/door
4. Mount switch to frame
5. Route wires between latch and CAN bus module
6. Route wires between switch and CAN bus module
7. Route wires between CAN bus and PDU

1. MOUNT LATCH TO DOOR

1. Remove existing latch and latch components. (the locking components must be reassembled onto the EAC latch)
2. Insert EAC latch into door.
3. Place the top mounting bracket (1) and the bottom mounting bracket (6) over the latch.

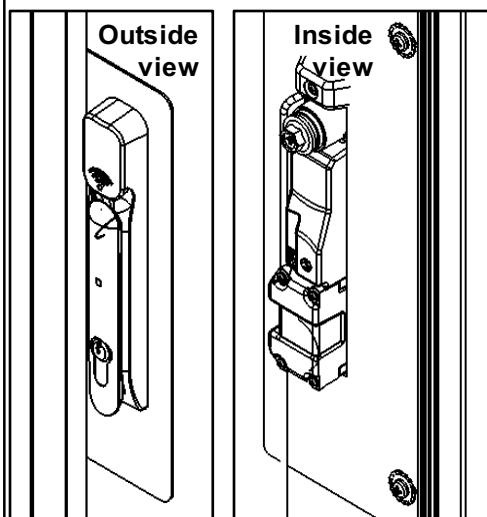
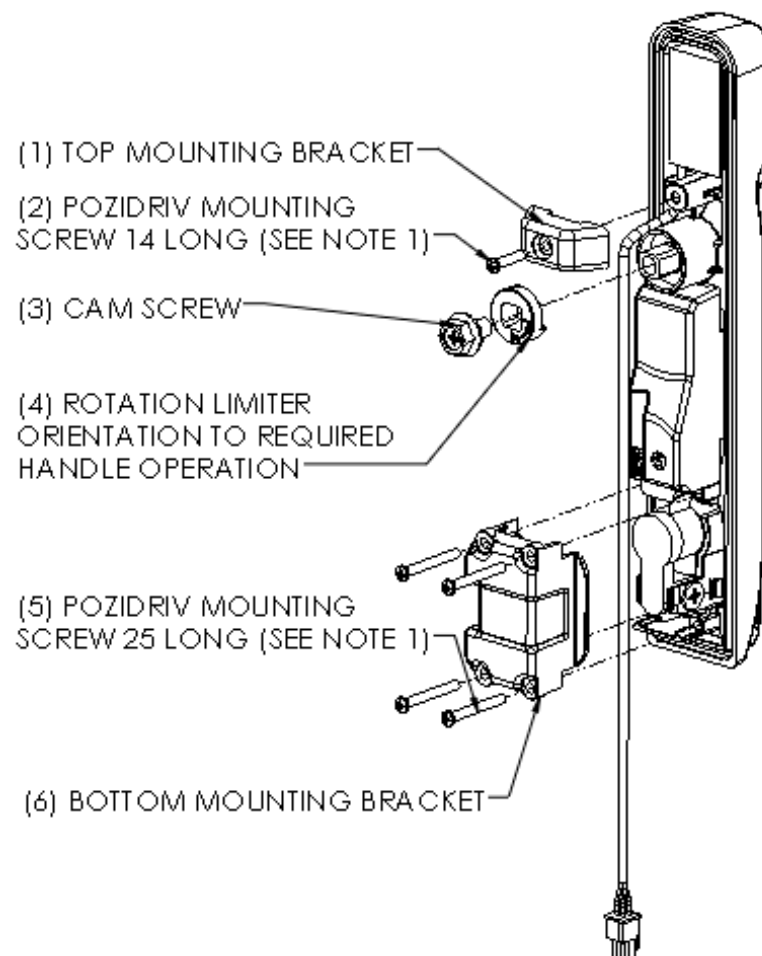

1. USE #1 POZIDRIV DRIVER WHEN INSTALLING MOUNTING SCREWS

Installation Instructions

eConnect Electronic Access Control – F-Series TeraFrame Cabinet

1. MOUNT LATCH TO DOOR

4. Orient the rotation limiter (4) and bottom mounting bracket (6) as needed.

OPTION 1 FOR INSTALLATION
OF ROTATION LIMITER
- VIEWED FROM BACK -

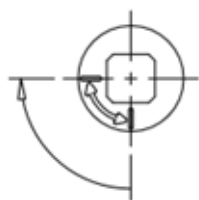

LEFT HAND MOUNTING
TO OPEN: TURN HANDLE 90°
COUNTER CLOCKWISE IF VIEWED
FROM FRONT

OPTION 2 FOR INSTALLATION
OF ROTATION LIMITER
- VIEWED FROM BACK -

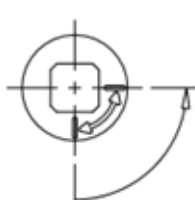

RIGHT HAND MOUNTING
TO OPEN: TURN HANDLE 90°
CLOCKWISE IF VIEWED
FROM FRONT

INSTALLATION OF BOTTOM MOUNTING BRACKET

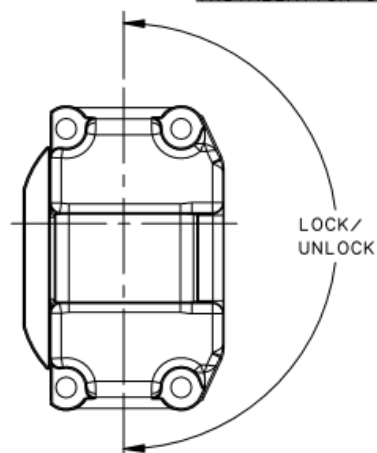

OPERATION OF LOCK PLUG CORRESPONDS WITH
ORIENTATION OF BOTTOM MOUNTING BRACKET
LEFT HAND MOUNT

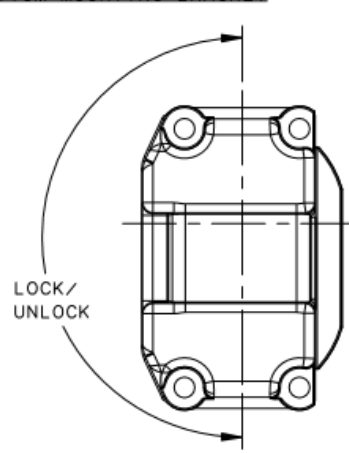

RIGHT HAND MOUNT

(1) TOP MOUNTING BRACKET

(2) POZIDRIV MOUNTING
SCREW 14 LONG (SEE NOTE 1)

(3) CAM SCREW

(4) ROTATION LIMITER
ORIENTATION TO REQUIRED
HANDLE OPERATION

(5) POZIDRIV MOUNTING
SCREW 25 LONG (SEE NOTE 1)

(6) BOTTOM MOUNTING BRACKET

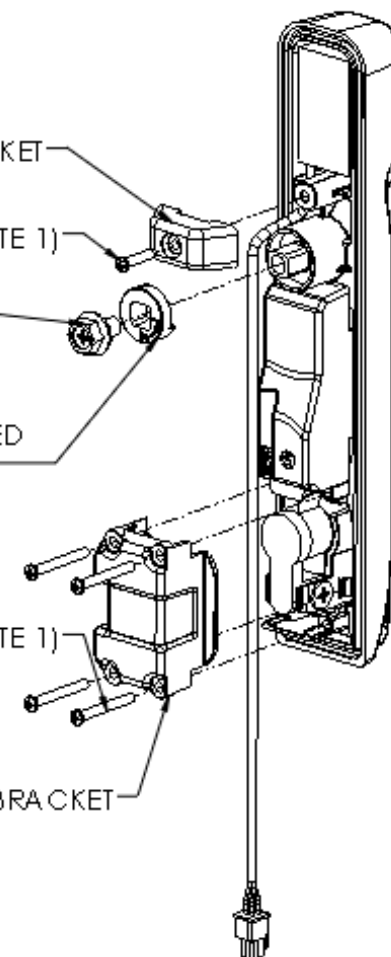

1. USE #1 POZIDRIV DRIVER WHEN
INSTALLING MOUNTING SCREWS

Installation Instructions

eConnect Electronic Access Control – F-Series TeraFrame Cabinet

1. MOUNT LATCH TO DOOR

5. Secure top mounting bracket with pozidriv screw (2)
6. Secure bottom mounting bracket with pozidriv screws (5)
7. Re-attach locking components in the same orientation

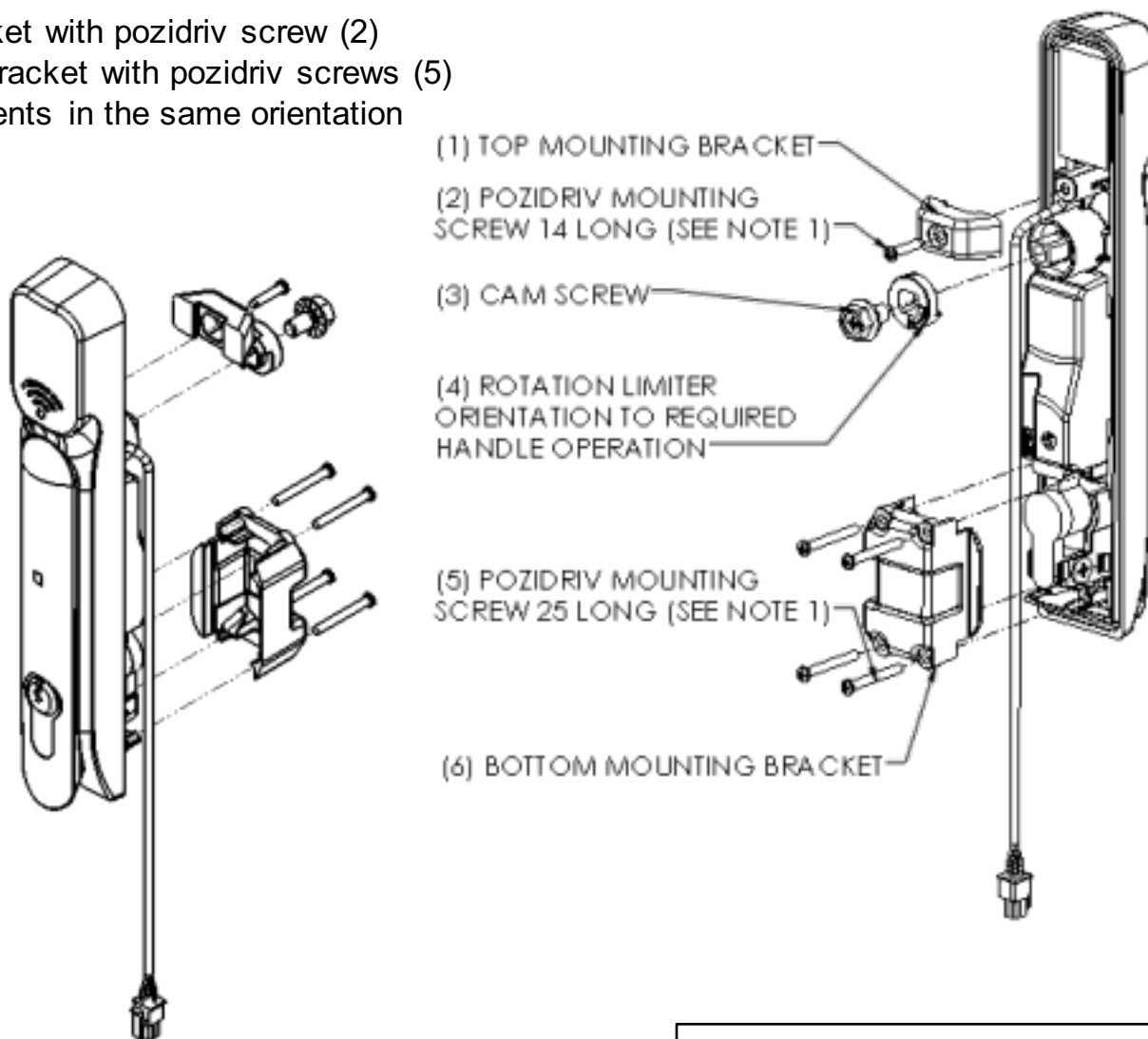
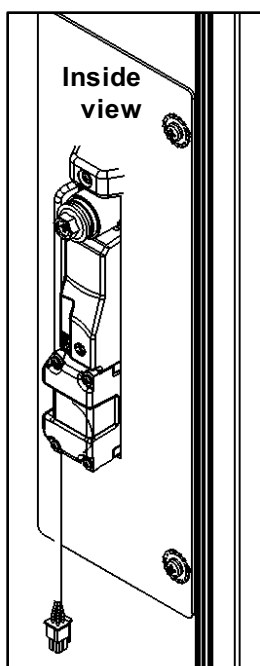
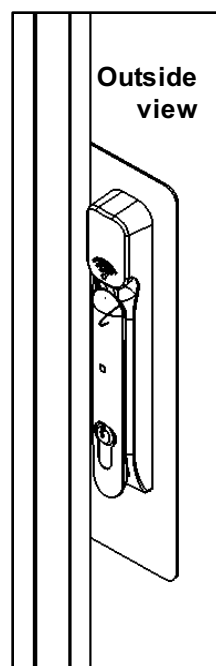

1. USE #1 POZIDRIV DRIVER WHEN INSTALLING MOUNTING SCREWS

Installation Instructions

eConnect Electronic Access Control – F-Series TeraFrame Cabinet

2. MOUNT MAGNET TO DOOR

1. Identify differences between sensor parts



MAGNET

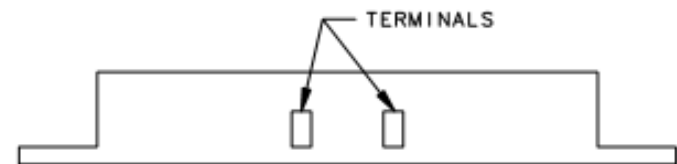

SWITCH

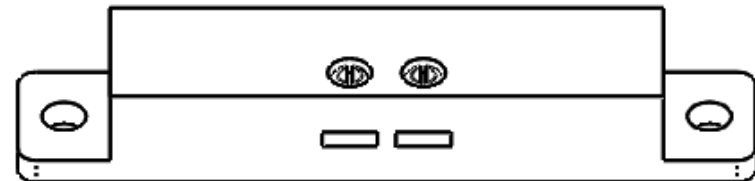
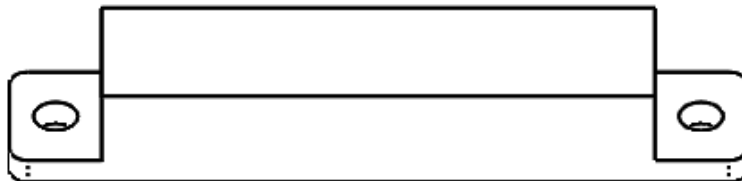

Installation Instructions

eConnect Electronic Access Control – F-Series TeraFrame Cabinet

2. MOUNT MAGNET TO DOOR

2. Attach bracket to door, latch side, with #4 Taptite screws
3. Attach sensor magnet to bracket with #2 Taptite screws and adhesive (not shown).
 1. Insert first screw
 2. Peel back cover to expose adhesive
 3. Insert second screw

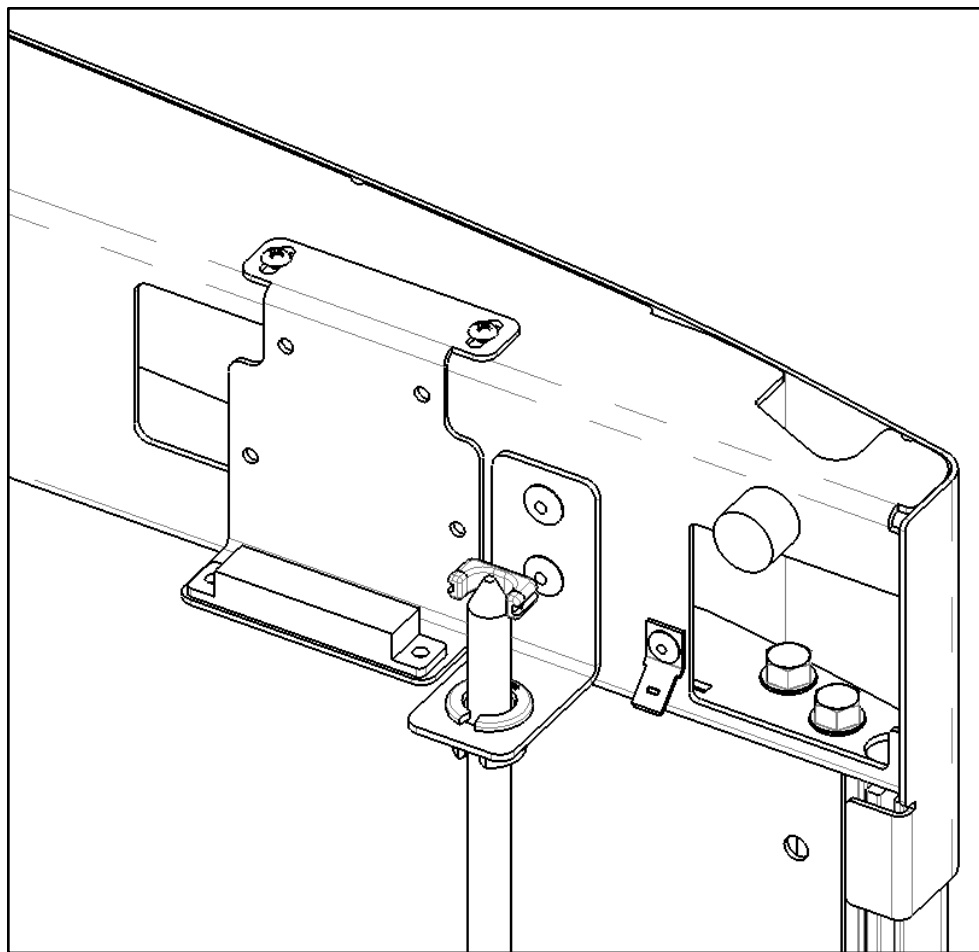

Installation Instructions

eConnect Electronic Access Control – F-Series TeraFrame Cabinet

3. MOUNT CAN BUS TO FRAME (OPTION 1)

1. Line the mounting bracket over the pre-drilled holes on the cabinet frame
2. Attach the bracket to the frame, using the #4 screws
3. Place the module behind the bracket
4. Push together until it snaps into place

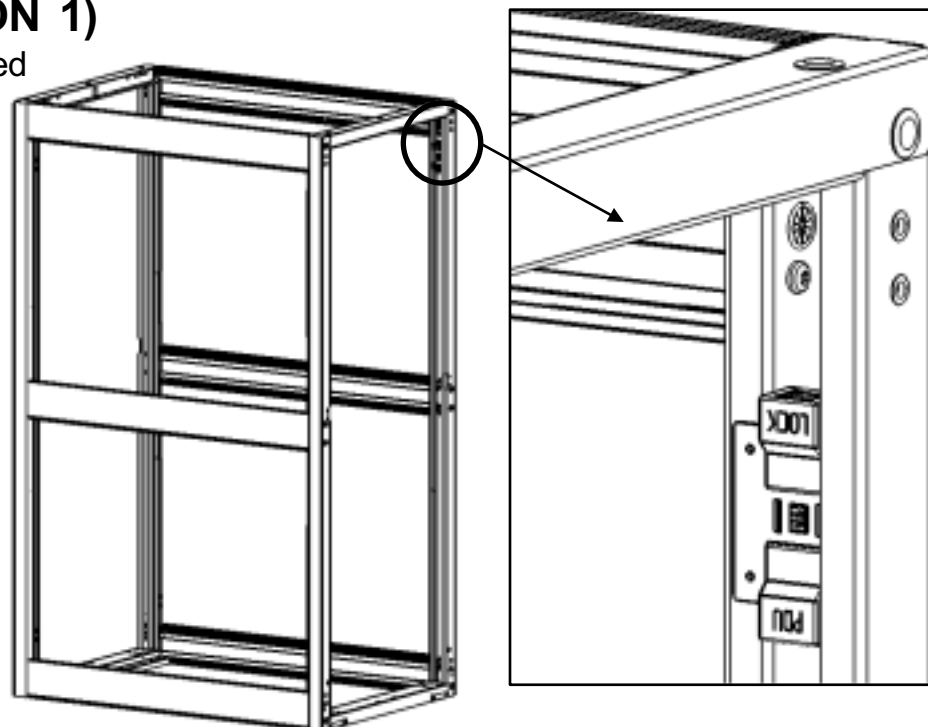
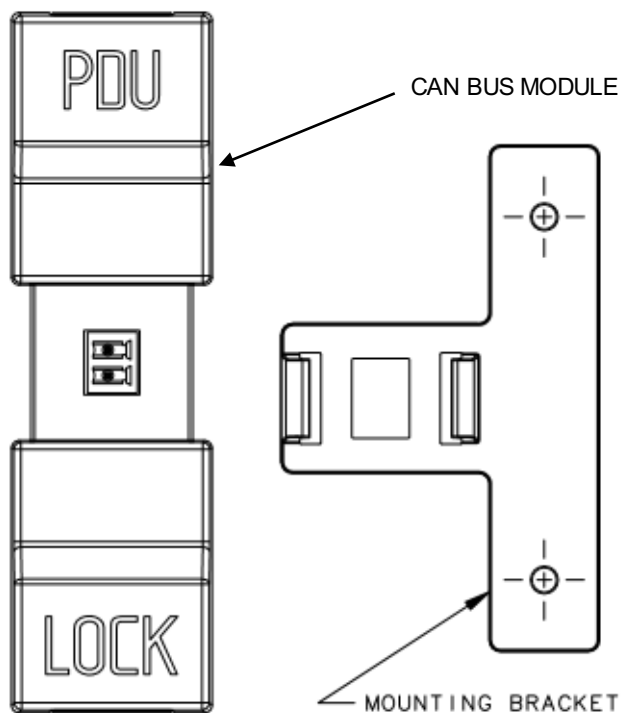

Installation Instructions

eConnect Electronic Access Control – F-Series TeraFrame Cabinet

3. INSERT CAN BUS INTO DOOR (OPTION 2)

1. If the rails are too far forward to install the module onto the frame, you are able to insert it into the door.
2. Use adhesive strip to mount module inside or leave it unattached.
3. Orient as shown

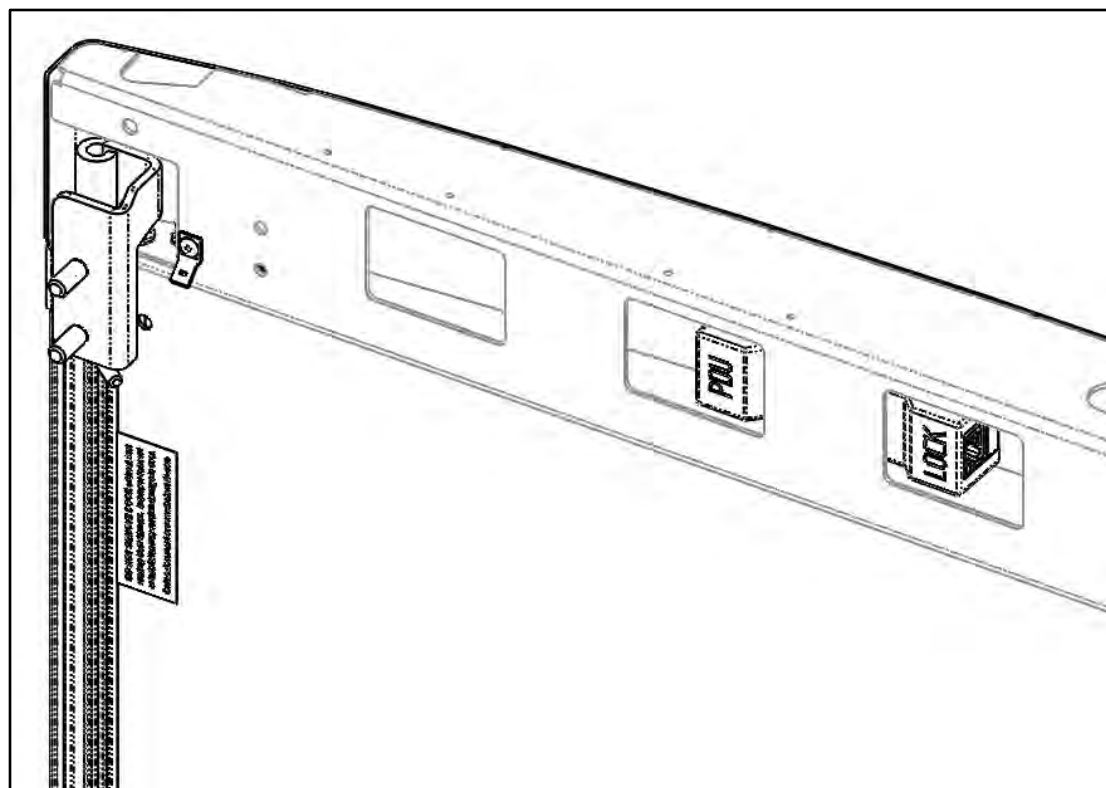
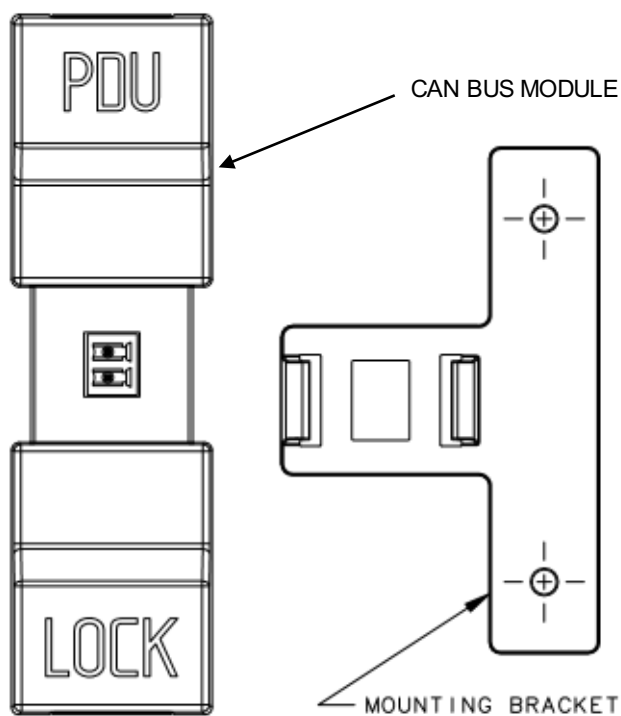

Installation Instructions

eConnect Electronic Access Control – F-Series TeraFrame Cabinet

4. MOUNT SWITCH TO FRAME

1. Attach sensor switch to frame with #2 Taptite screws and adhesive (not shown).
 1. Insert first screw into pre-drilled hole
 2. Peel back cover to expose adhesive
 3. Insert second screw into pre-drilled hole

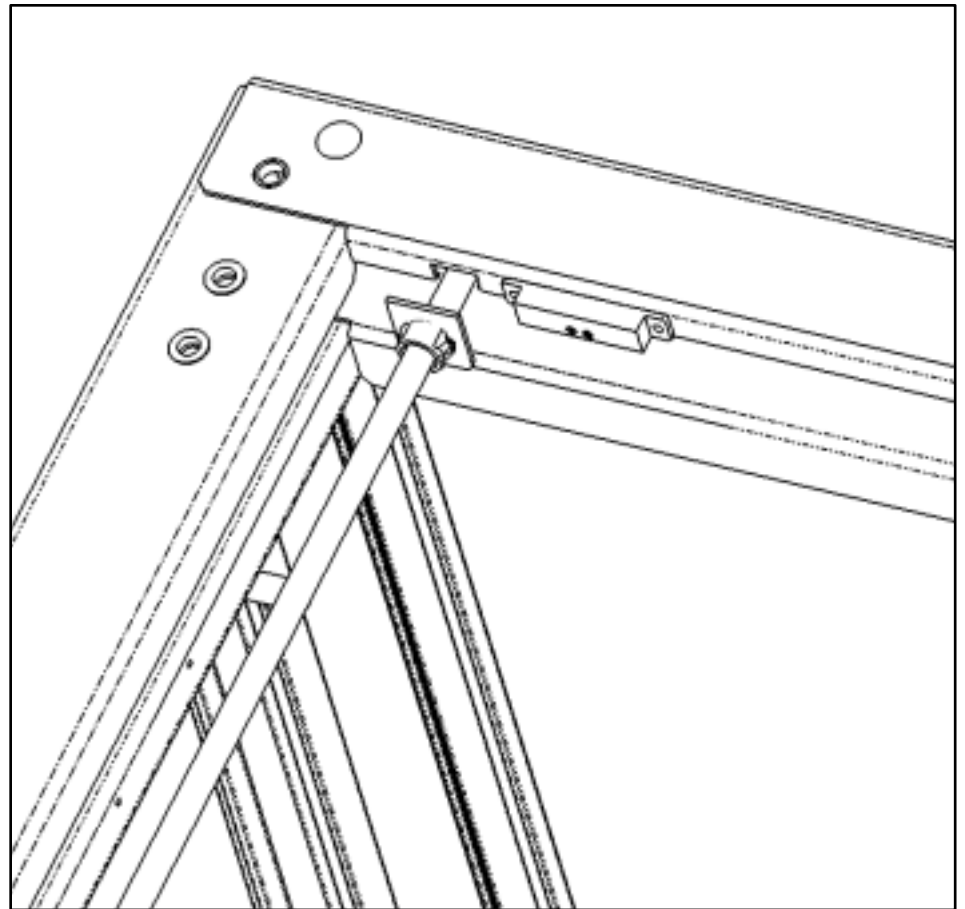

Installation Instructions

eConnect Electronic Access Control – F-Series TeraFrame Cabinet

5. ROUTE WIRES BETWEEN LATCH & CAN BUS

To Latch

To CAN Bus
Module: Lock Side

To Latch

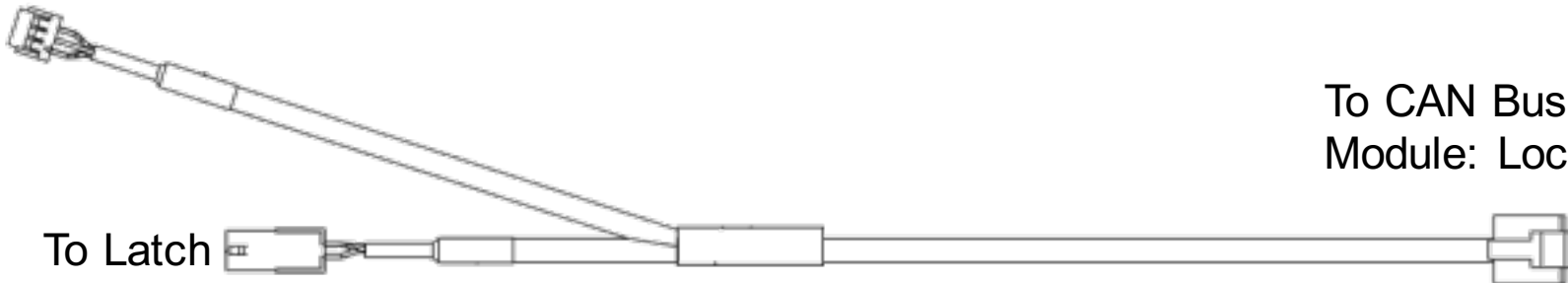

Installation Instructions

eConnect Electronic Access Control – F-Series TeraFrame Cabinet

5. ROUTE WIRES BETWEEN LATCH & CAN BUS

1. Use wire clips to run cable over the latch plate and into extrusion as shown
2. Use extrusion clips to push cable into extrusion
3. Direct cable into and out of door frame

WIRE CLIP W/
ADHESIVE

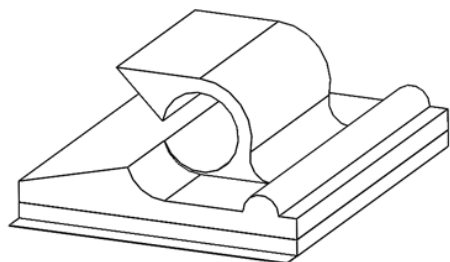

Into

Extrusion Clip

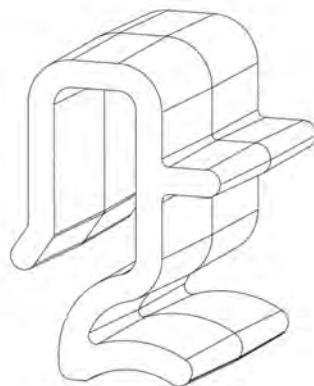

Out of



Installation Instructions

eConnect Electronic Access Control – F-Series TeraFrame Cabinet

5. ROUTE WIRES BETWEEN LATCH & CAN BUS

4. After mounting the door, plug the lock cable into the “Lock” side of the CAN Bus Module
5. Use wire clips to guide cable around frame, avoiding pinch points
6. Check and confirm that there is enough slack to allow the door to open and close fully



Installation Instructions

eConnect Electronic Access Control – F-Series TeraFrame Cabinet

6. ROUTE WIRES BETWEEN SWITCH & CAN BUS

1. Insert wires into sensor switch
2. Route wire inside door frame using wire clips
3. Plug other end into CAN Bus Module –
(Check and confirm that there is enough slack to allow the door to fully open and close.)



SWITCH WITH WIRES
CONNECTED



SWITCH WIRE CONNECTOR

WIRE CLIP W/
ADHESIVE

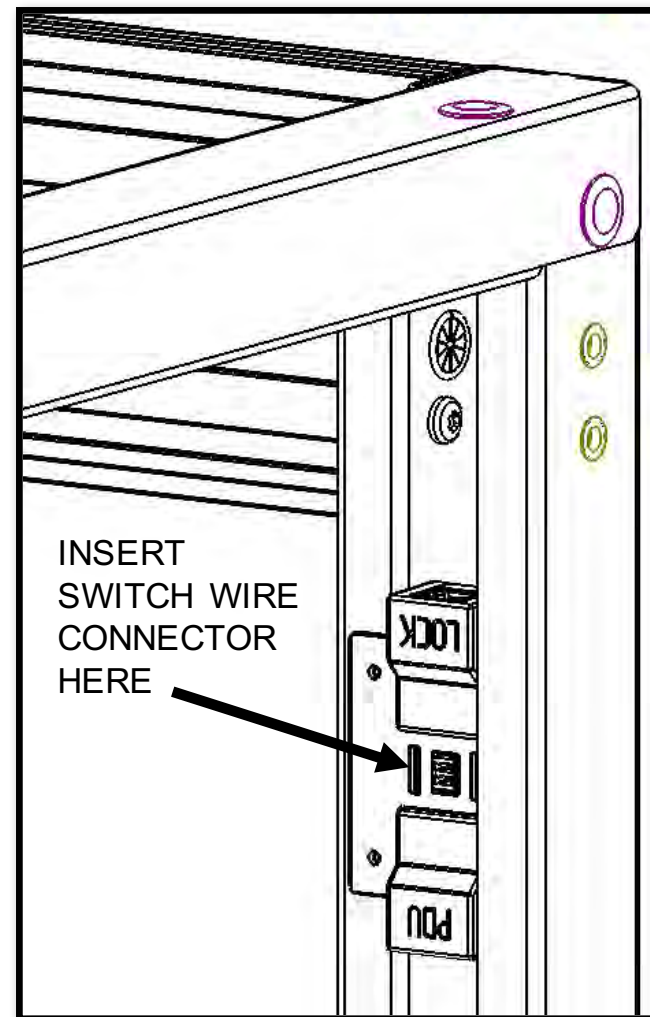
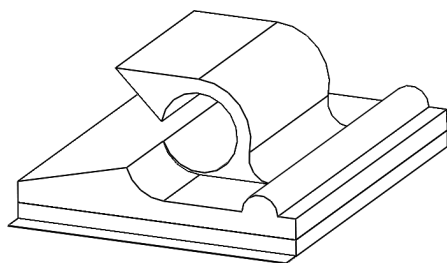

Installation Instructions

eConnect Electronic Access Control – F-Series TeraFrame Cabinet

7. ROUTE WIRES BETWEEN CAN BUS MODULE & PDU

1. Plug cable into PDU side of CAN Bus Module
2. Route the cable through grommets
3. Plug into PDU
 1. Aux 1 is for the rear door switch/latch
 2. Aux 2 is for the front door switch/latch

GROMMET
(ROUTE WIRE
FROM CAN BUS
MODULE TO PDU)

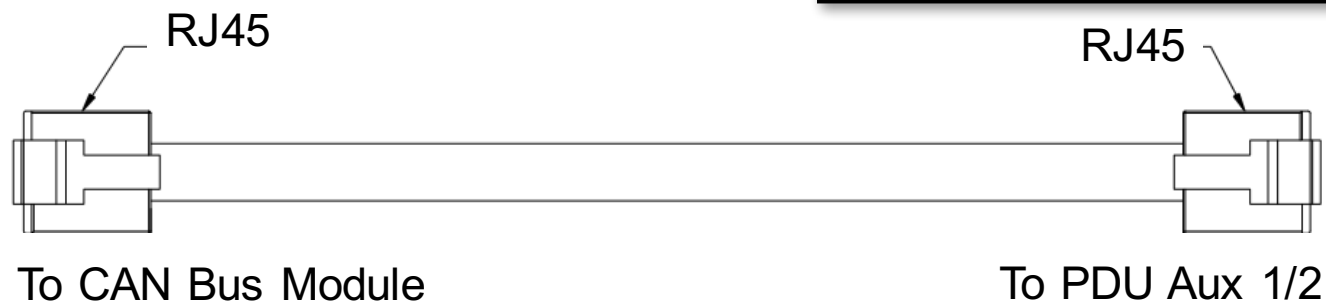
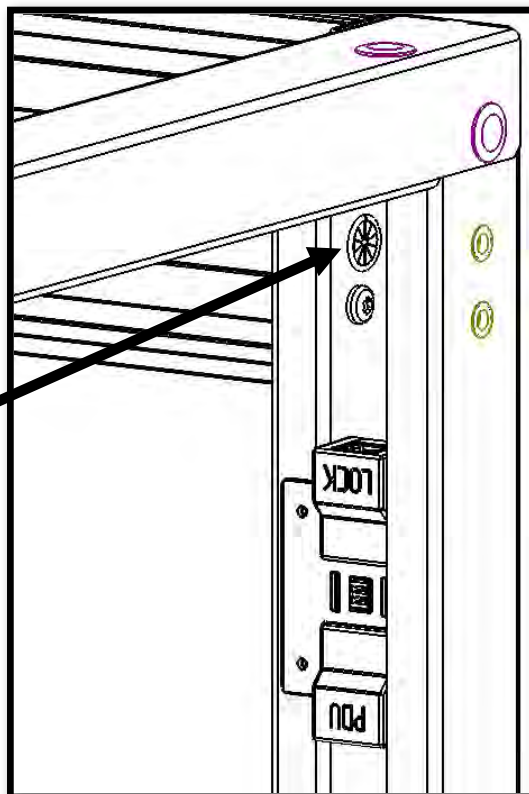

Installation Instructions

eConnect Electronic Access Control – GF-Series GlobalFrame Cabinet

Includes:

025-907002-006	CLIP,CBL,ADH,BK
025-908040-009	BUSH,.437ID MAX,.125 PNL
020-736643-001	SNAP,EXTRUSION,BK
020-736644-X01	BRKT,DOOR SW,MNTG
025-907011-137	LATCH ASSEMBLY,5V
025-907011-138	CAN BUS MODULE ASSEMBLY,5V
025-907011-139	Y-HARNESS,24 GAUGE,2 METERS,BLACK
025-907011-141	PATCH CABLE,3 METERS,BLACK
025-907011-143	DOOR SWITCH KIT,BLACK
025-907011-154	PROX CARD,ELS,CPI,20 PK

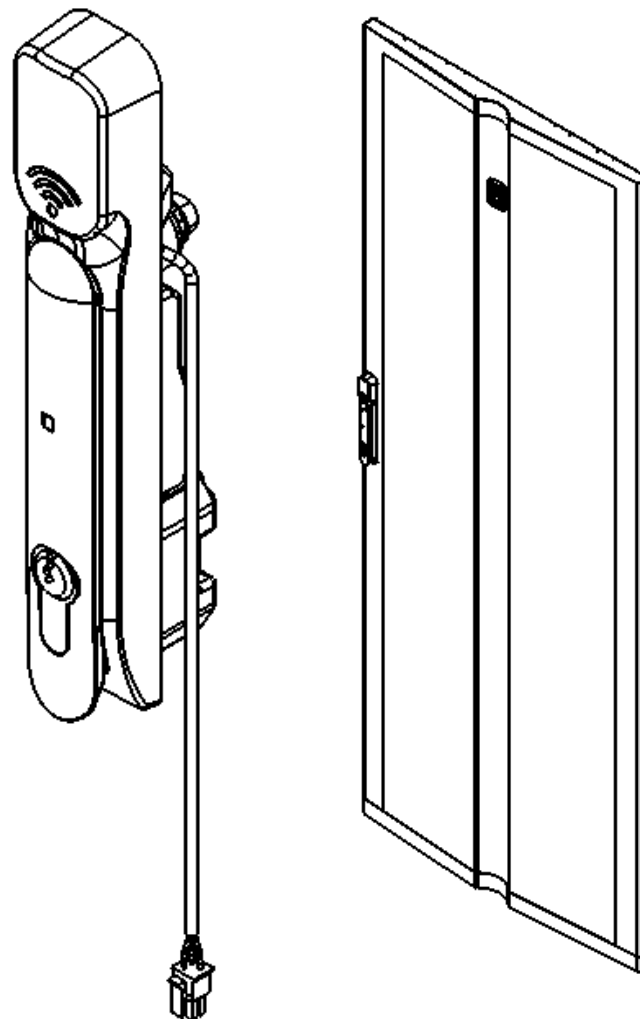

IIS-736650, 02/22/17, Rev. 1, CPI/RBF

800-834-4969 (USA & Canada) • www.chatsworth.com • techsupport@chatsworth.com
For international phonenumber, see our website or contact CPI Tech Support.

This drawing contains proprietary and confidential information and is protected by U.S. and international law. Unauthorized reproduction, disclosure or use of the drawing or the information therein is expressly forbidden except as agreed to in writing by Chatsworth Products, Inc.

Installation Instructions

eConnect Electronic Access Control – GF-Series GlobalFrame Cabinet

ASSEMBLY SEQUENCE

1. Mount latch to door
2. Mount magnet to door
3. Mount CAN bus module to frame/door
4. Mount switch to frame
5. Route wires between latch and CAN bus module
6. Route wires between switch and CAN bus module
7. Route wires between CAN bus and PDU

1. MOUNT LATCH TO DOOR

1. Remove existing latch and latch components these must be reassembled onto electronic latch
2. Insert latch into door.
3. Place the top mounting bracket (1) and the bottom mounting bracket (6) over the latch.

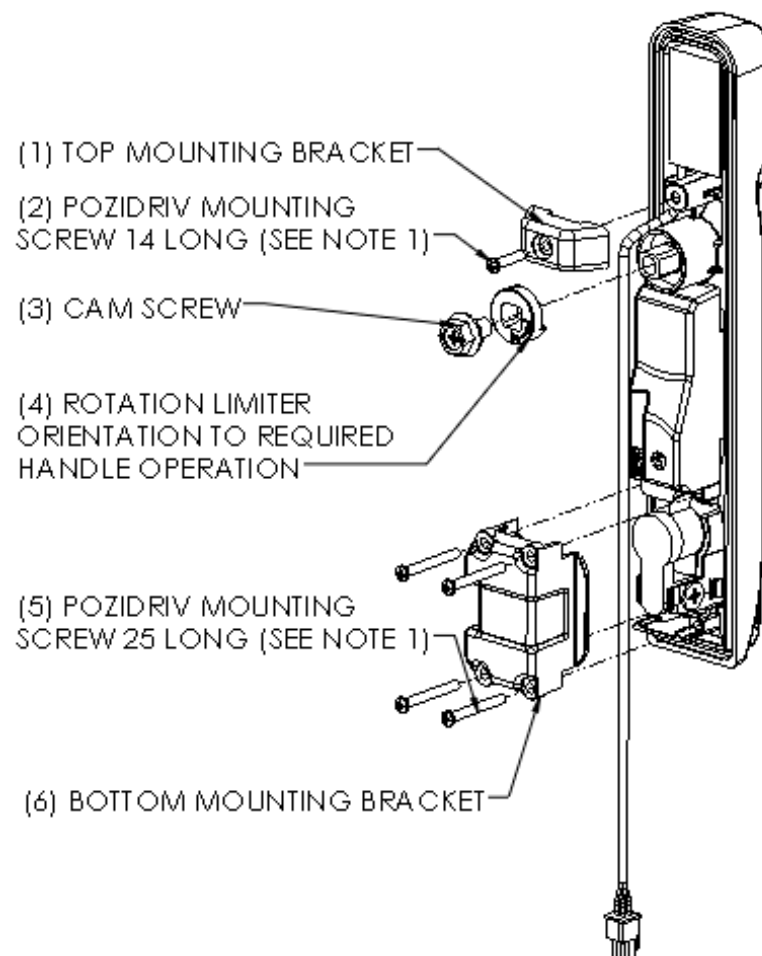
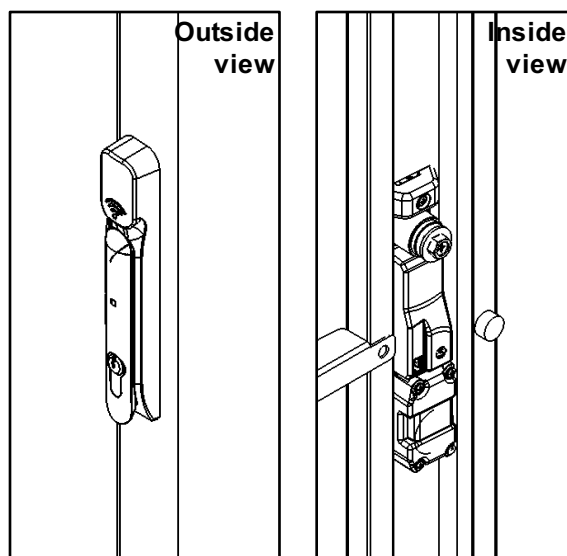

1. USE #1 POZIDRIV DRIVER WHEN INSTALLING MOUNTING SCREWS

Installation Instructions

eConnect Electronic Access Control – GF-Series GlobalFrame Cabinet

1. MOUNT LATCH TO DOOR

4. Orient the rotation limiter (4) and bottom mounting bracket (6) as needed.

OPTION 1 FOR INSTALLATION
OF ROTATION LIMITER
- VIEWED FROM BACK -

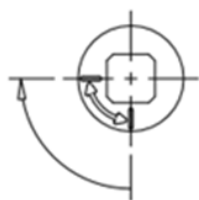

LEFT HAND MOUNTING
TO OPEN: TURN HANDLE 90°
COUNTER CLOCKWISE IF VIEWED
FROM FRONT

OPTION 2 FOR INSTALLATION
OF ROTATION LIMITER
- VIEWED FROM BACK -



RIGHT HAND MOUNTING
TO OPEN: TURN HANDLE 90°
CLOCKWISE IF VIEWED
FROM FRONT

INSTALLATION OF BOTTOM MOUNTING BRACKET

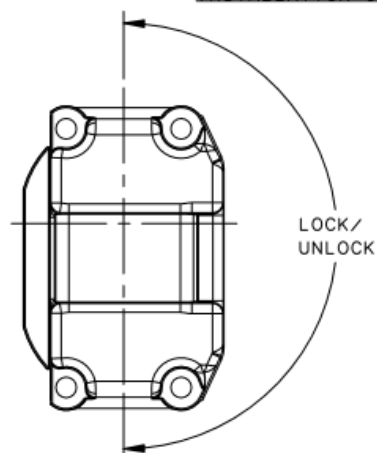

OPERATION OF LOCK PLUG CORRESPONDS WITH
ORIENTATION OF BOTTOM MOUNTING BRACKET
LEFT HAND MOUNT

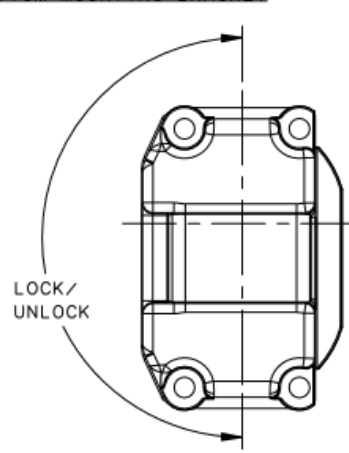

RIGHT HAND MOUNT

(1) TOP MOUNTING BRACKET

(2) POZIDRIV MOUNTING
SCREW 14 LONG (SEE NOTE 1)

(3) CAM SCREW

(4) ROTATION LIMITER
ORIENTATION TO REQUIRED
HANDLE OPERATION

(5) POZIDRIV MOUNTING
SCREW 25 LONG (SEE NOTE 1)

(6) BOTTOM MOUNTING BRACKET

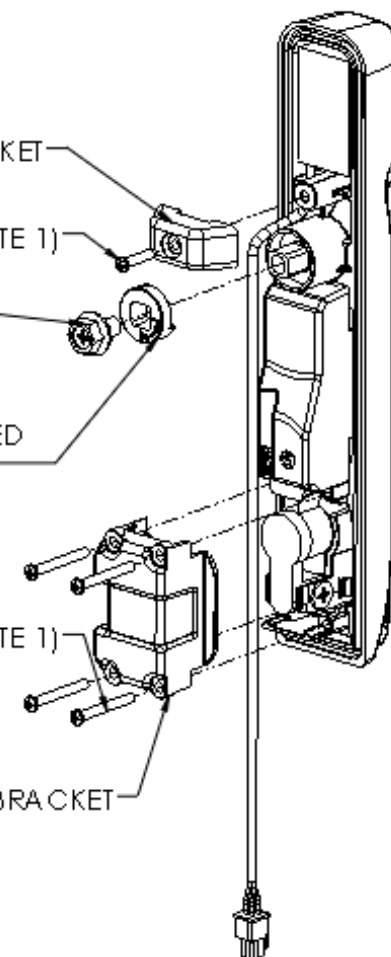

1. USE #1 POZIDRIV DRIVER WHEN
INSTALLING MOUNTING SCREWS

Installation Instructions

eConnect Electronic Access Control – GF-Series GlobalFrame Cabinet

1. MOUNT LATCH TO DOOR

5. Secure top mounting bracket with pozidriv screw (2)
6. Secure bottom mounting bracket with pozidriv screws (5)
7. Re-attach locking components in the same orientation

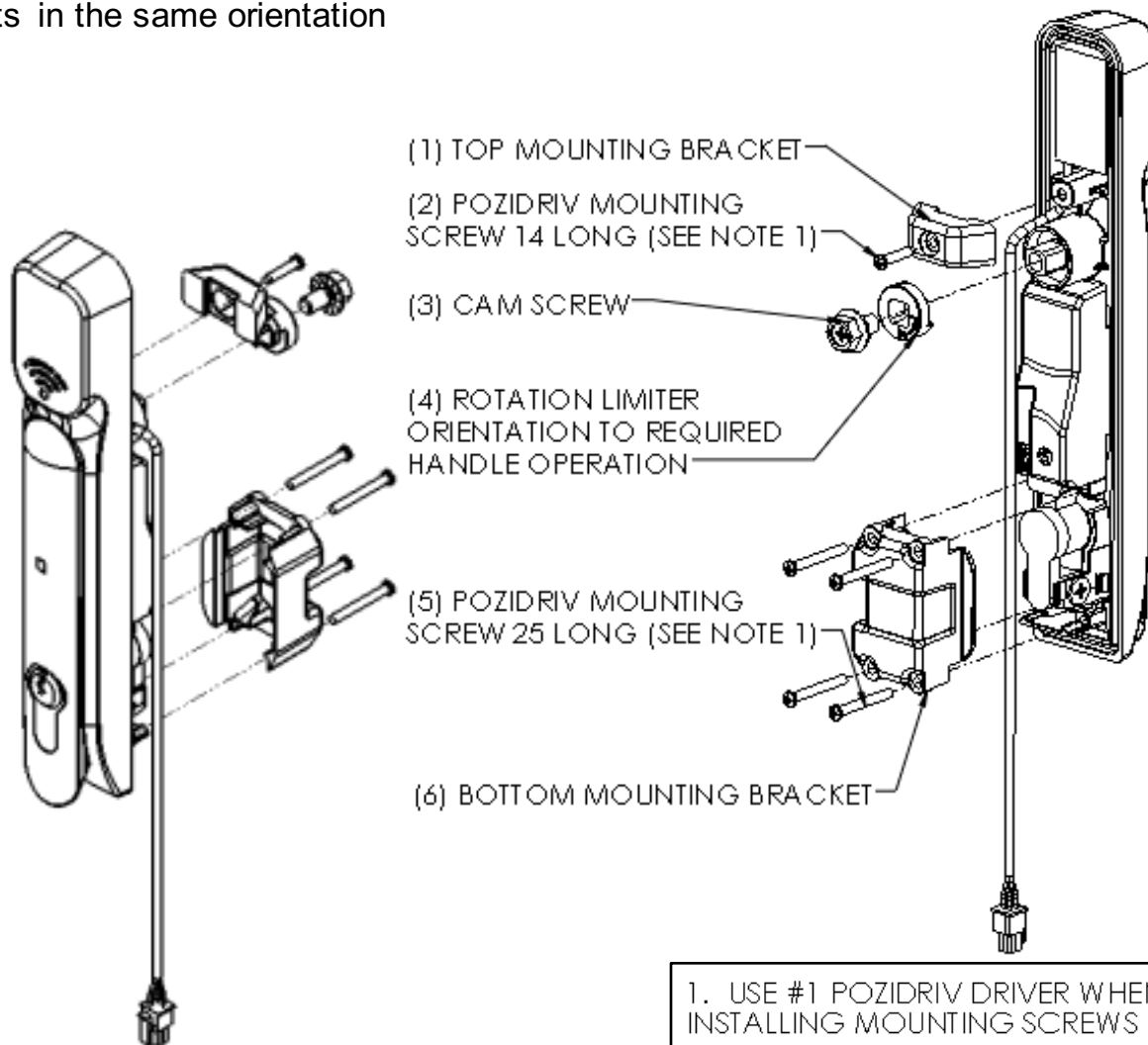
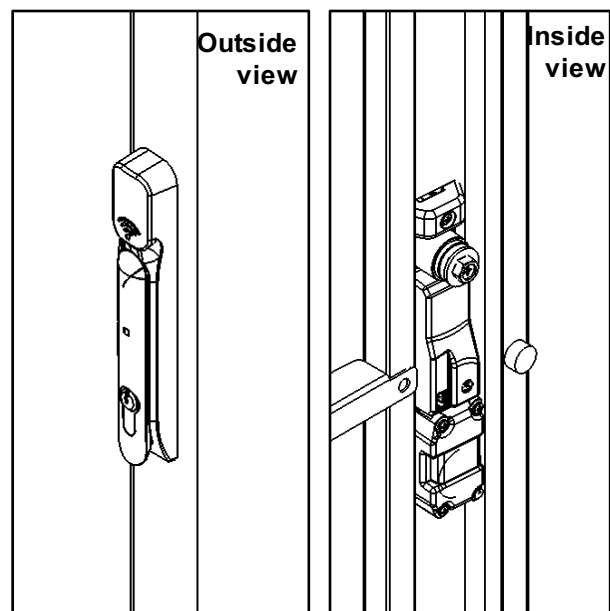

1. USE #1 POZIDRIV DRIVER WHEN INSTALLING MOUNTING SCREWS

Installation Instructions

eConnect Electronic Access Control – GF-Series GlobalFrame Cabinet

IDENTIFY DIFFERENCES BETWEEN SENSOR PARTS



MAGNET

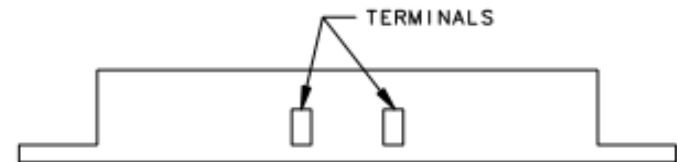

SWITCH



Installation Instructions

eConnect Electronic Access Control – GF-Series GlobalFrame Cabinet

2. MOUNT MAGNET TO DOOR

1. Attach bracket to door, latch side, with #4 Taptite screws
2. Attach sensor magnet to bracket with #2 Taptite screws and adhesive (not shown).
 1. Insert first screw
 2. Peel back cover to expose adhesive
 3. Insert second screw

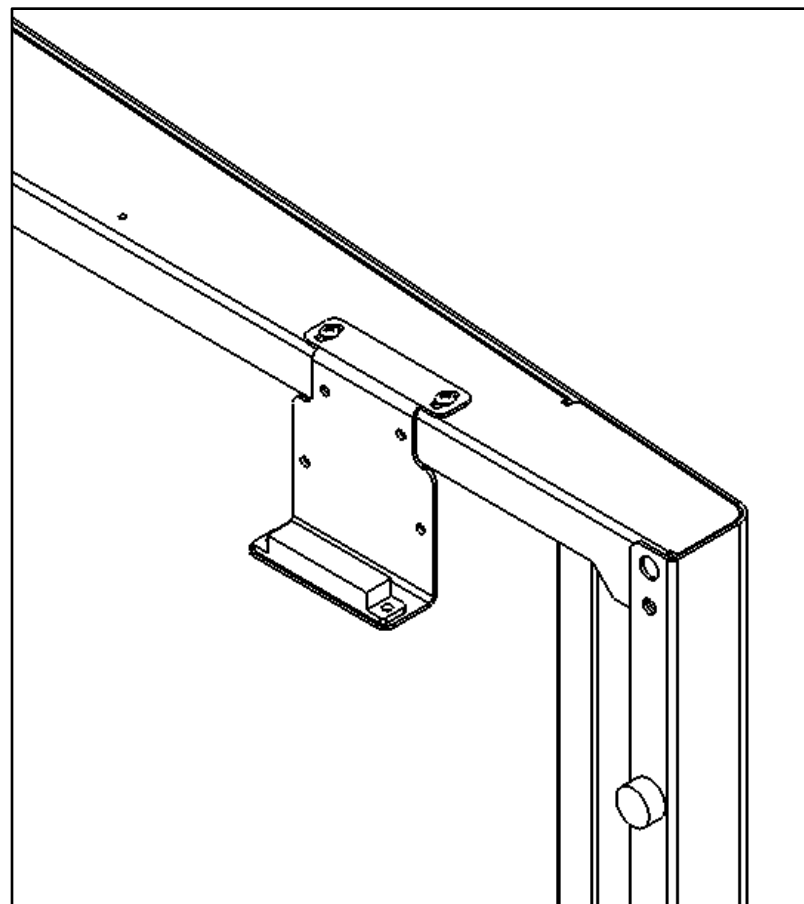

Installation Instructions

eConnect Electronic Access Control – GF-Series GlobalFrame Cabinet

3. MOUNT CAN BUS TO FRAME

1. Line the drill template over the door stiffener.
2. Use a #44 bit to drill a .086" hole through template.
3. Use #4 screws to attach the bracket to the door.
4. Place the module behind the bracket.
5. Push and hear it click into place.
6. If a drill or bit is unavailable, you can mount the module with double sided tape.
7. Place the mounting bracket so that the top edge is 6 inches down along the stiffener.

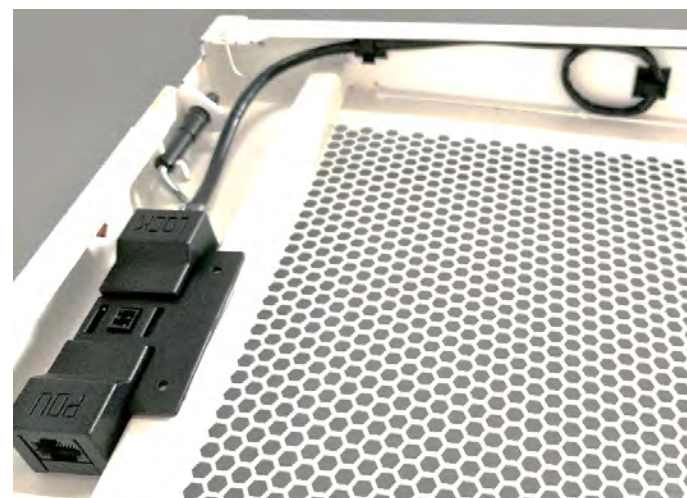
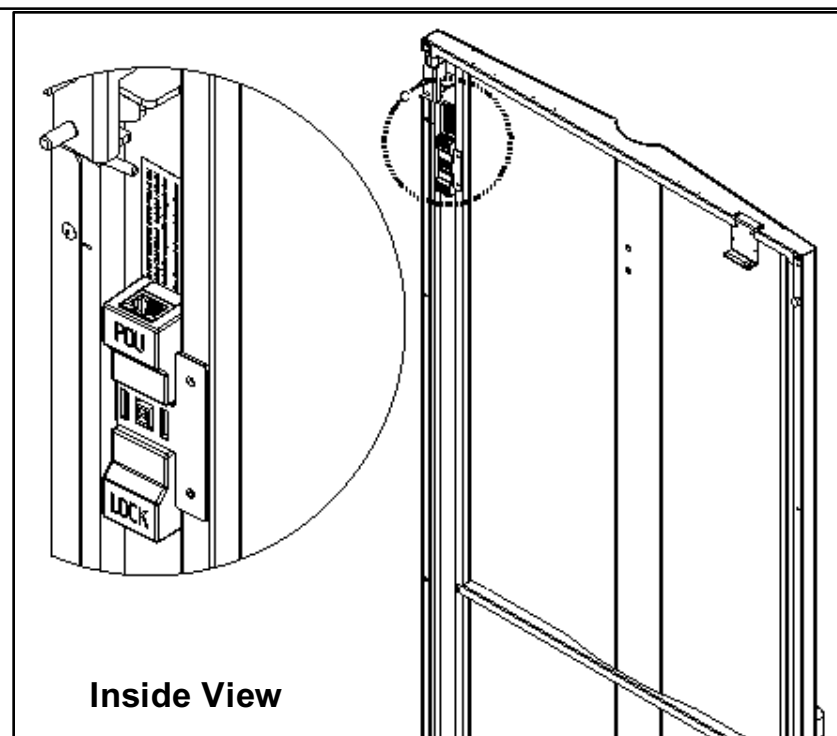
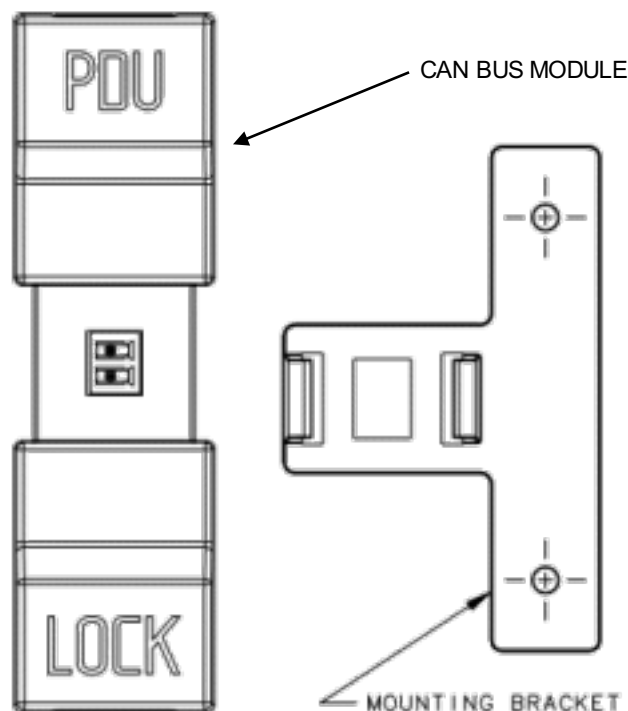

Installation Instructions

eConnect Electronic Access Control – GF-Series GlobalFrame Cabinet

4. MOUNT SWITCH TO FRAME

1. Attach sensor switch to frame with #2 Taptite screws and adhesive (not shown).
 1. Insert first screw into pre-drilled hole
 2. Peel back cover to expose adhesive
 3. Insert second screw into pre-drilled hole

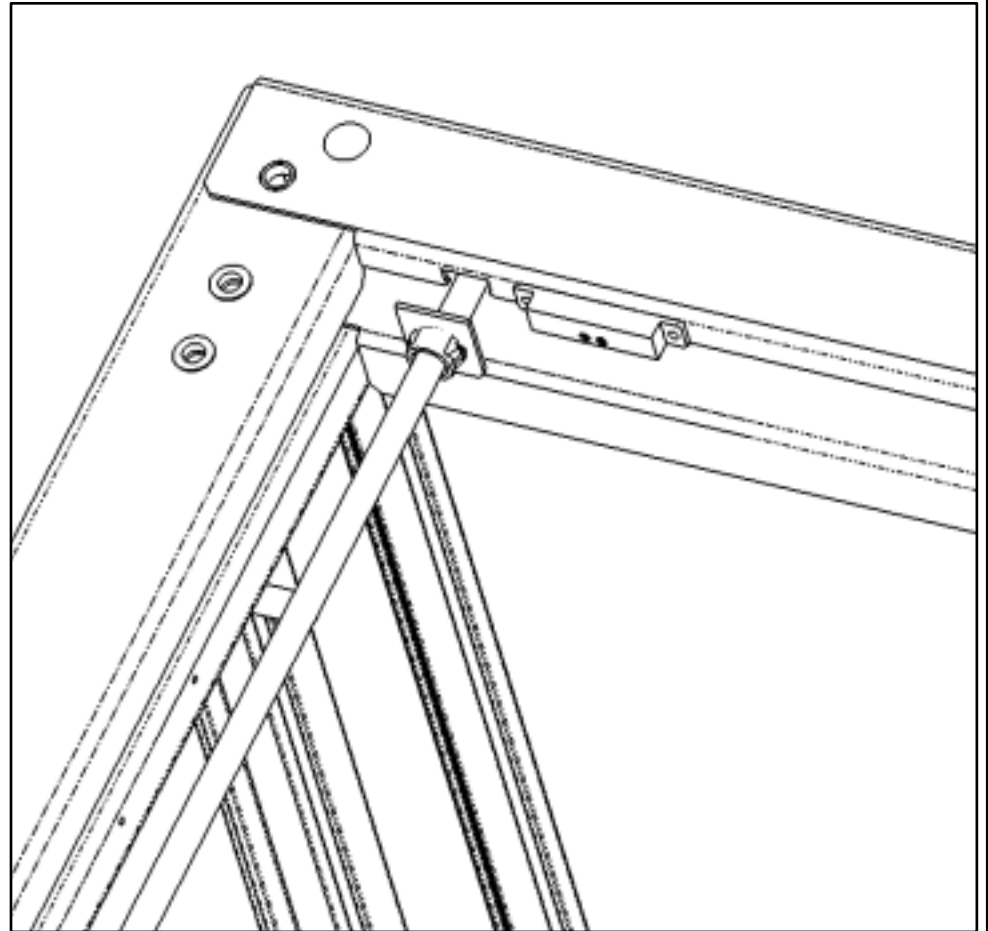

Installation Instructions

eConnect Electronic Access Control – GF-Series GlobalFrame Cabinet

5. ROUTE WIRES BETWEEN LATCH & CAN BUS

To Latch

To CAN Bus
Module: Lock Side

To Latch

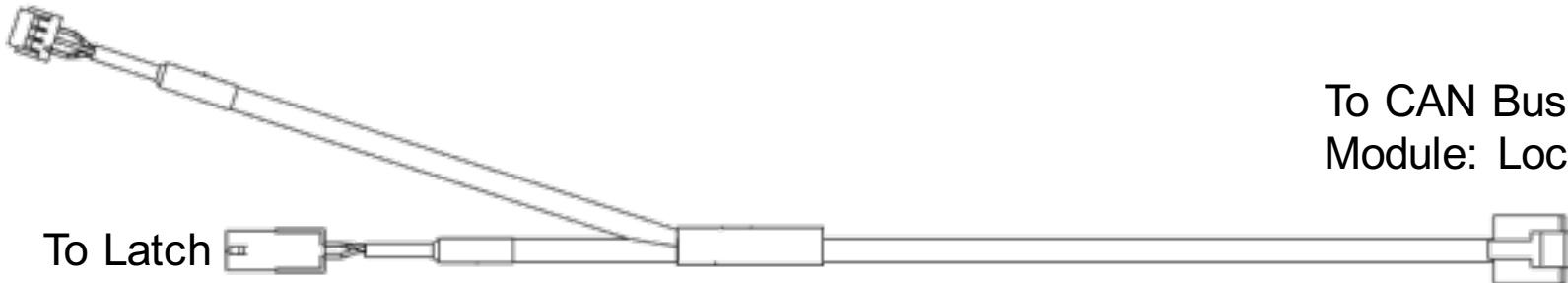

Installation Instructions

eConnect Electronic Access Control – GF-Series GlobalFrame Cabinet

5. ROUTE WIRES BETWEEN LATCH & CAN BUS

1. Use wire clips to run cable around the frame edge

WIRE CLIP W/
ADHESIVE

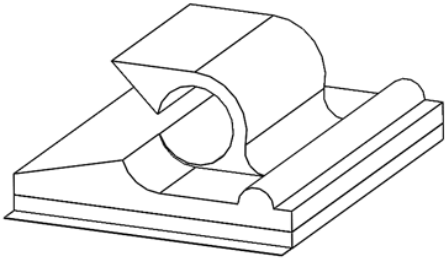

Into



Out of

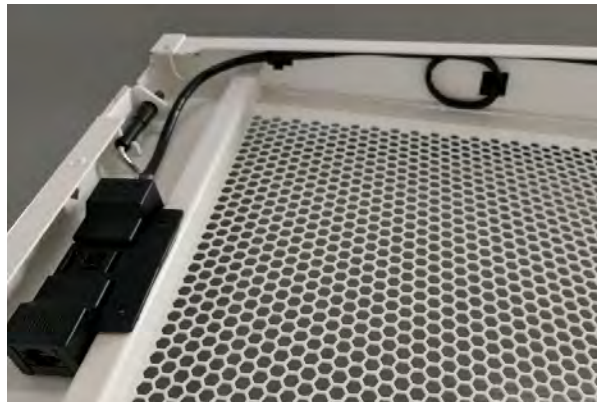

Installation Instructions

eConnect Electronic Access Control – GF-Series GlobalFrame Cabinet

5. ROUTE WIRES BETWEEN LATCH & CAN BUS

2. After mounting the door, plug the latch wire into the “Lock” side of the CAN Bus Module
3. Use wire clips to guide cable around frame, avoiding pinch points
4. Check and confirm that there is enough slack to allow the door to fully open and close



Installation Instructions

eConnect Electronic Access Control – GF-Series GlobalFrame Cabinet

6. ROUTE WIRES BETWEEN SWITCH & CAN BUS

1. Insert wires into sensor switch
2. Route wire inside door frame using wire clips
3. Plug other end into CAN Bus Module –
(Check and confirm that there is enough slack to allow the door to fully open and close.)



SWITCH WITH WIRES
CONNECTED



SWITCH WIRE CONNECTOR

WIRE CLIP W/
ADHESIVE

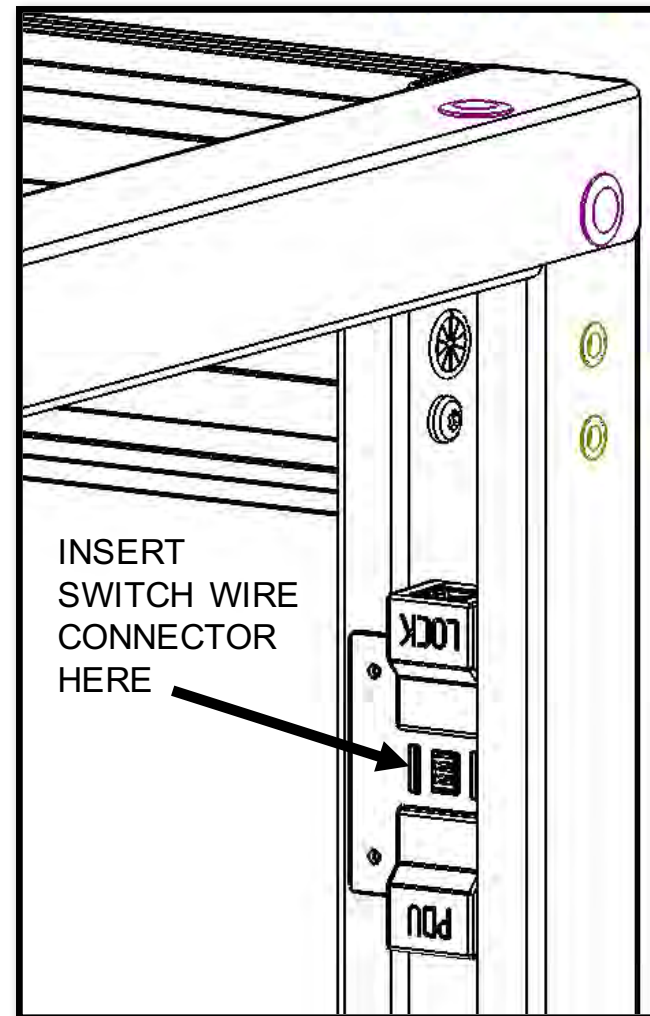
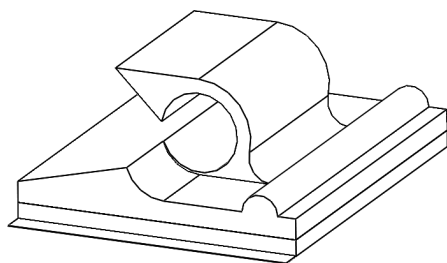

Installation Instructions

eConnect Electronic Access Control – GF-Series GlobalFrame Cabinet

7. ROUTE WIRES BETWEEN CAN BUS MODULE & PDU

1. Plug cable into PDU side of CAN Bus Module
2. Route the cable through grommets
3. Plug into PDU
 1. Aux 1 is for the rear door switch/latch
 2. Aux 2 is for the front door switch/latch

GROMMET
(ROUTE WIRE
FROM CAN BUS
MODULE TO PDU)

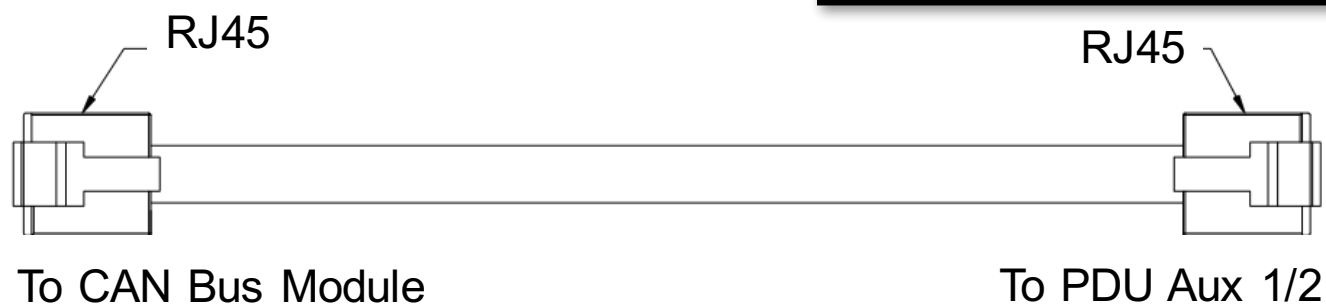
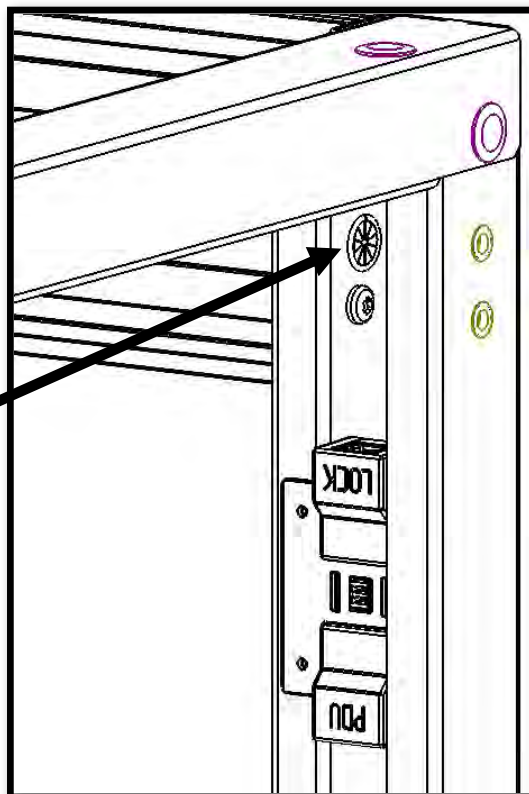

Installation Instructions

eConnect Electronic Access Control – N-Series TeraFrame Cabinet

Includes:

025-907002-006	CLIP,CBL,ADH,BK
025-908040-009	BUSH,.437ID MAX,.125 PNL
020-736643-001	SNAP,EXTRUSION,BK
020-736644-X01	BRKT,DOOR SW,MNTG
025-907011-137	LATCH ASSEMBLY,5V
025-907011-138	CAN BUS MODULE ASSEMBLY,5V
025-907011-139	Y-HARNESS,24 GAUGE,2 METERS,BLACK
025-907011-141	PATCH CABLE,3 METERS,BLACK
025-907011-143	DOOR SWITCH KIT,BLACK
025-907011-154	PROX CARD,ELS,CPI,20 PK



IIS-736650, 02/22/17, Rev. 1, CPI/RBF

800-834-4969 (USA & Canada) • www.chatsworth.com • techsupport@chatsworth.com

For international phone numbers, see our website or contact CPI Tech Support.

This drawing contains proprietary and confidential information and is protected by U.S. and international law. Unauthorized reproduction, disclosure or use of the drawing or the information therein is expressly forbidden except as agreed to in writing by Chatsworth Products, Inc.

Installation Instructions

eConnect Electronic Access Control – N-Series TeraFrame Cabinet

ASSEMBLY SEQUENCE

1. Mount latch to door
2. Mount magnet to door
3. Mount CAN bus module to frame/door
4. Mount switch to frame
5. Route wires between latch and CAN bus module
6. Route wires between switch and CAN bus module
7. Route wires between CAN bus and PDU

1. MOUNT LATCH TO DOOR

1. Remove existing latch and latch components.
(the locking components must be reassembled onto the EAC latch)
1. Insert EAC latch into door.
2. Place the top mounting bracket (1) and the bottom mounting bracket (6) over the latch.

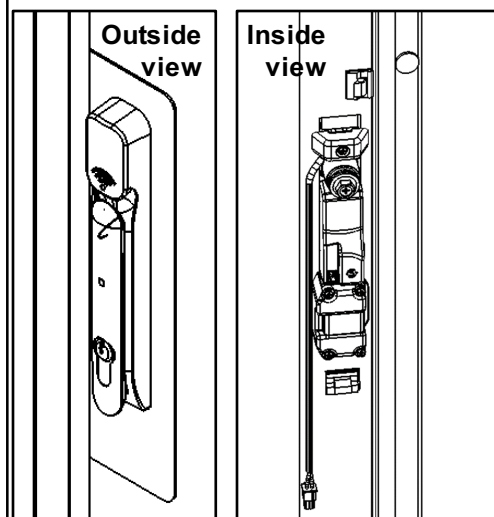
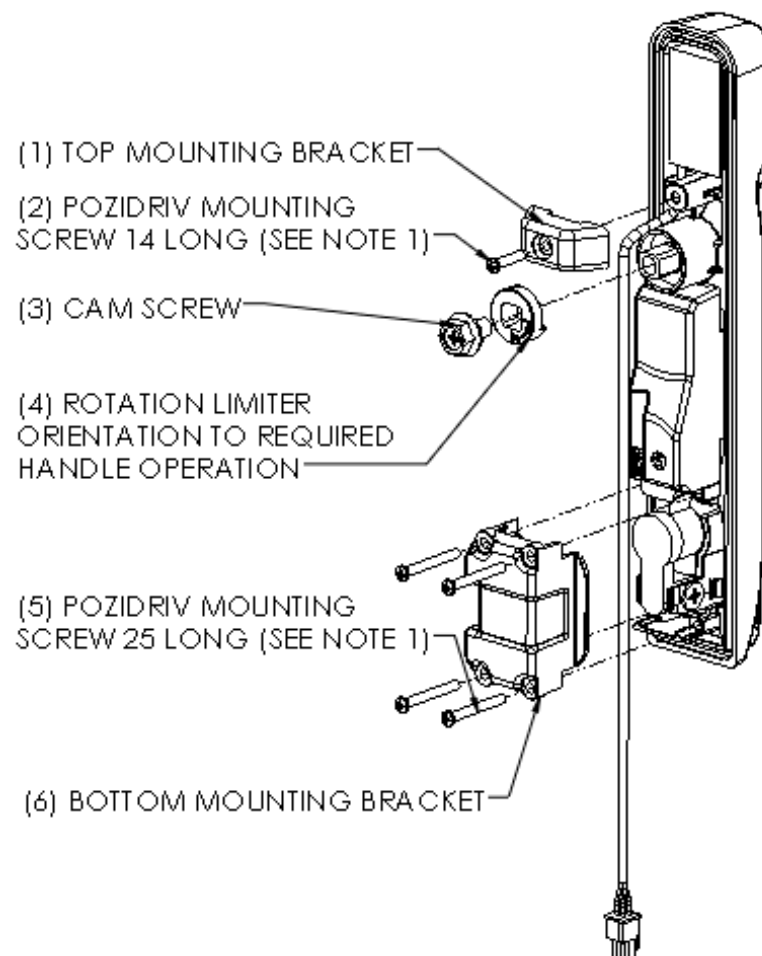

1. USE #1 POZIDRIV DRIVER WHEN INSTALLING MOUNTING SCREWS

Installation Instructions

eConnect Electronic Access Control – N-Series TeraFrame Cabinet

1. MOUNT LATCH TO DOOR

4. Orient the rotation limiter (4) and bottom mounting bracket (6) as needed.

OPTION 1 FOR INSTALLATION
OF ROTATION LIMITER
- VIEWED FROM BACK -

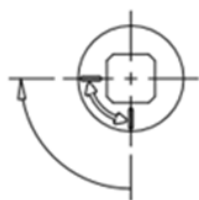

LEFT HAND MOUNTING
TO OPEN: TURN HANDLE 90°
COUNTER CLOCKWISE IF VIEWED
FROM FRONT

OPTION 2 FOR INSTALLATION
OF ROTATION LIMITER
- VIEWED FROM BACK -



RIGHT HAND MOUNTING
TO OPEN: TURN HANDLE 90°
CLOCKWISE IF VIEWED
FROM FRONT

INSTALLATION OF BOTTOM MOUNTING BRACKET

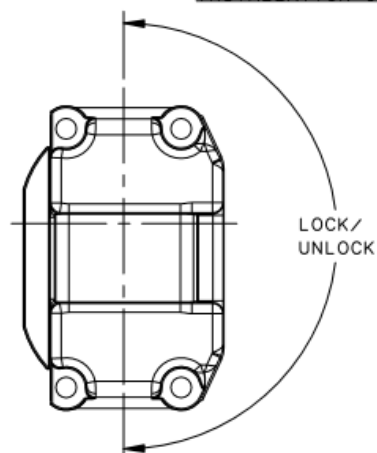

OPERATION OF LOCK PLUG CORRESPONDS WITH
ORIENTATION OF BOTTOM MOUNTING BRACKET
LEFT HAND MOUNT

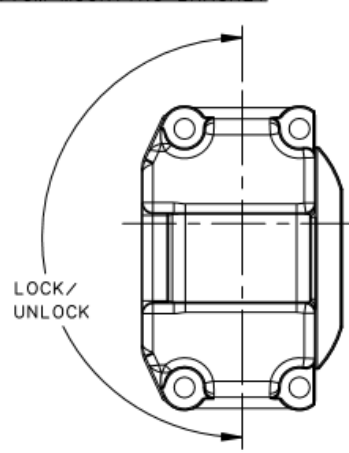

RIGHT HAND MOUNT

(1) TOP MOUNTING BRACKET

(2) POZIDRIV MOUNTING
SCREW 14 LONG (SEE NOTE 1)

(3) CAM SCREW

(4) ROTATION LIMITER
ORIENTATION TO REQUIRED
HANDLE OPERATION

(5) POZIDRIV MOUNTING
SCREW 25 LONG (SEE NOTE 1)

(6) BOTTOM MOUNTING BRACKET

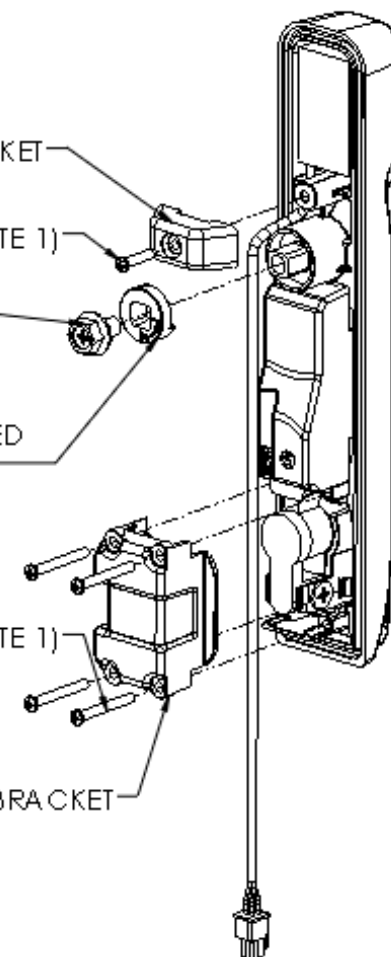

1. USE #1 POZIDRIV DRIVER WHEN
INSTALLING MOUNTING SCREWS

Installation Instructions

eConnect Electronic Access Control – N-Series TeraFrame Cabinet

1. MOUNT LATCH TO DOOR

5. Secure top mounting bracket with pozidriv screw (2)
6. Secure bottom mounting bracket with pozidriv screws (5)
7. Re-attach locking components in the same orientation

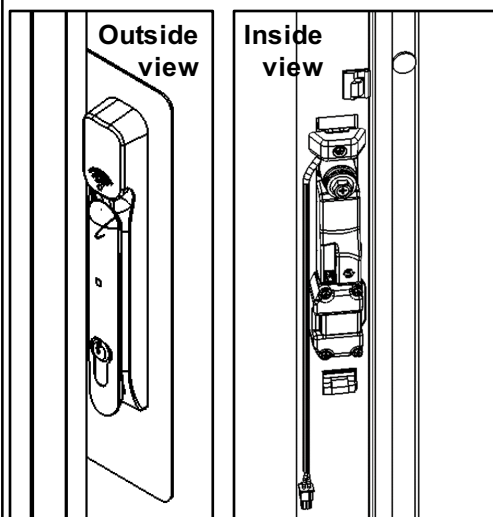
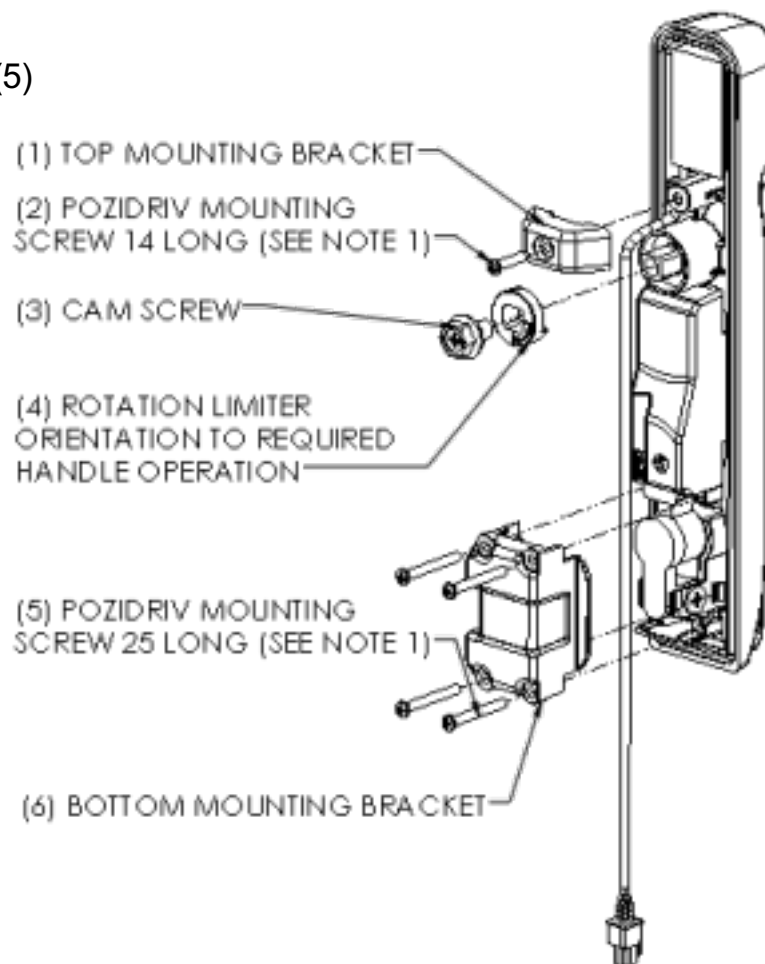

1. USE #1 POZIDRIV DRIVER WHEN INSTALLING MOUNTING SCREWS

Installation Instructions

eConnect Electronic Access Control – N-Series TeraFrame Cabinet

2. MOUNT MAGNET TO DOOR

1. Identify differences between sensor parts



MAGNET

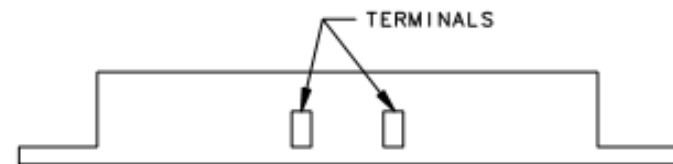

SWITCH

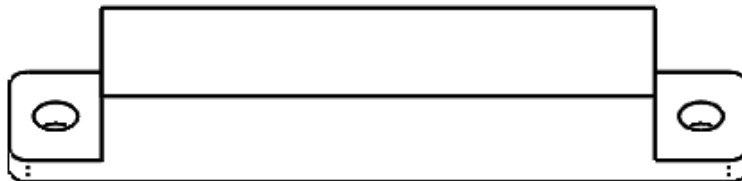

Installation Instructions

eConnect Electronic Access Control – N-Series TeraFrame Cabinet

2. MOUNT MAGNET TO DOOR

2. Attach bracket to door, latch side, with #4 Taptite screws
3. Attach sensor magnet to bracket with #2 Taptite screws and adhesive (not shown).
 1. Insert first screw
 2. Peel back cover to expose adhesive
 3. Insert second screw

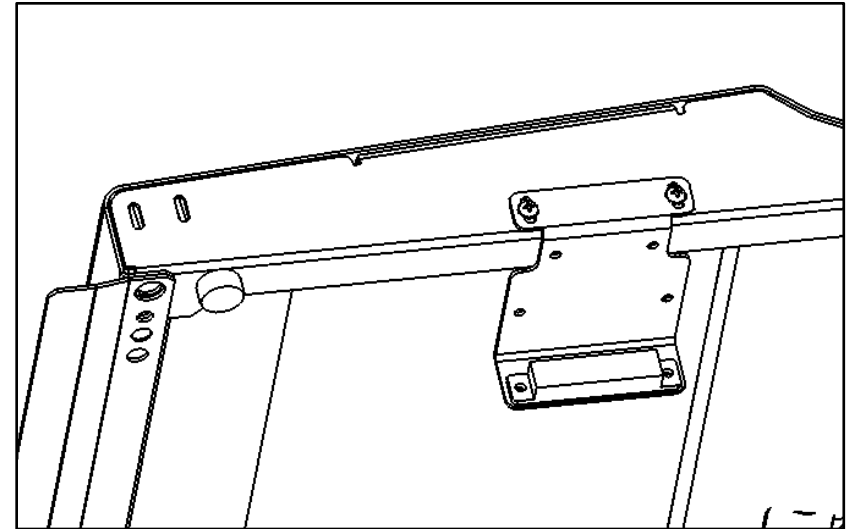
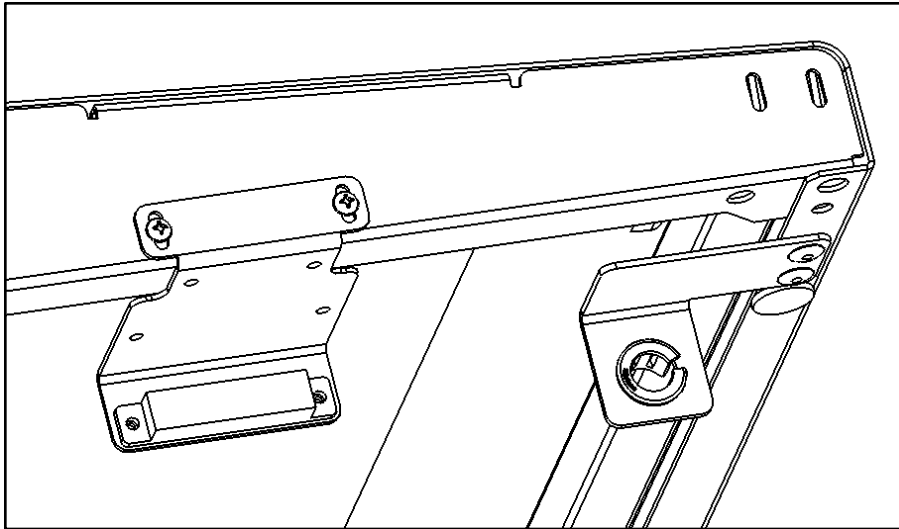

Installation Instructions

eConnect Electronic Access Control – N-Series TeraFrame Cabinet

3. MOUNT CAN BUS TO FRAME (OPTION 1)

1. Line the mounting bracket over the pre-drilled holes on the cabinet frame
2. Attach the bracket to the frame, using the #4 screws
3. Place the module behind the bracket
4. Push together until it snaps into place

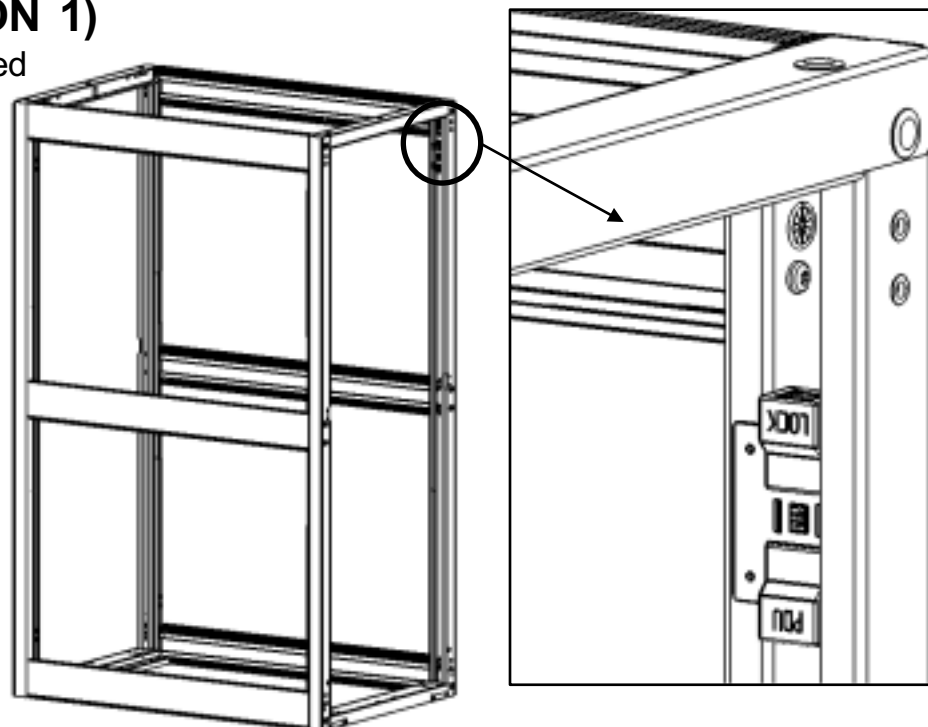
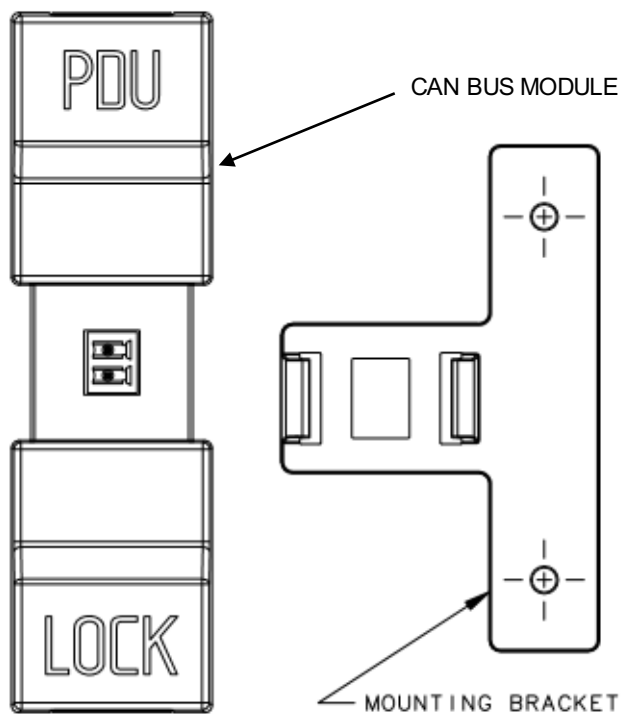

Installation Instructions

eConnect Electronic Access Control – N-Series TeraFrame Cabinet

4. MOUNT SWITCH TO FRAME

1. Attach sensor switch to frame with #2 Taptite screws and adhesive (not shown).
 1. Insert first screw into pre-drilled hole
 2. Peel back cover to expose adhesive
 3. Insert second screw into pre-drilled hole

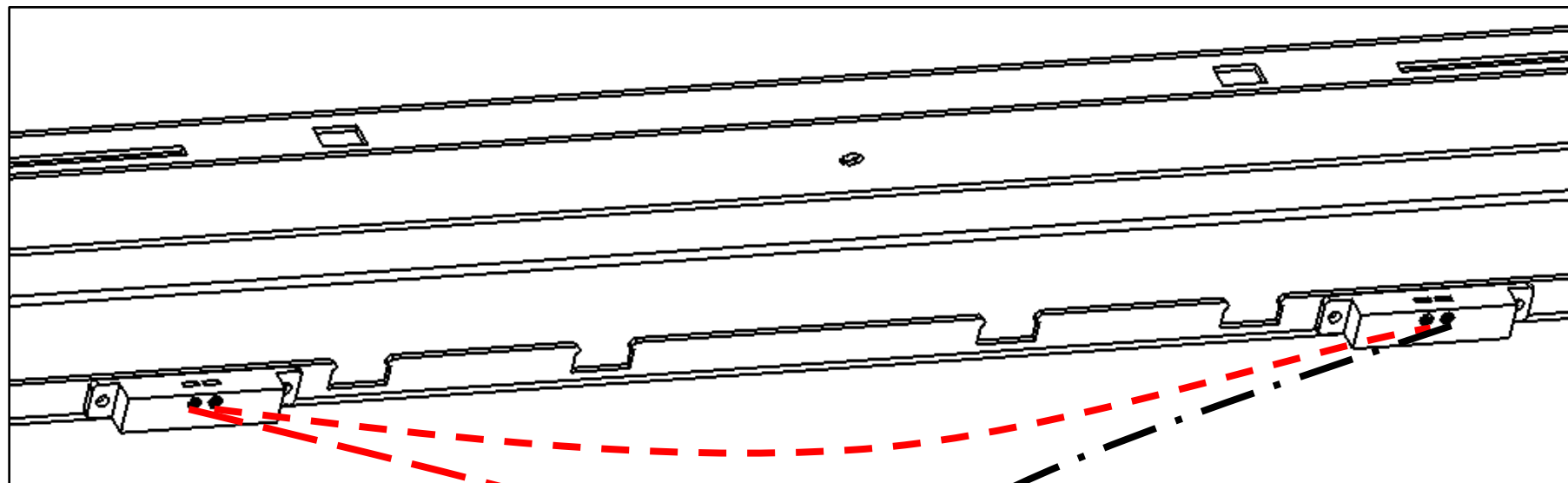

To CAN Bus

Installation Instructions

eConnect Electronic Access Control – N-Series TeraFrame Cabinet

5. ROUTE WIRES BETWEEN LATCH & CAN BUS

To Latch

To CAN Bus
Module: Lock Side

To Latch

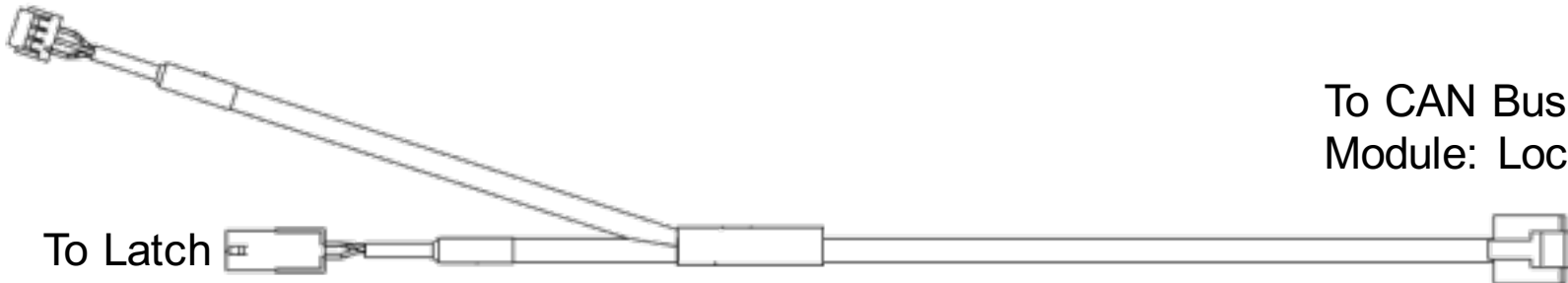

Installation Instructions

eConnect Electronic Access Control – N-Series TeraFrame Cabinet

5. ROUTE WIRES BETWEEN LATCH & CAN BUS

1. Use wire clips to run cable inside door frame

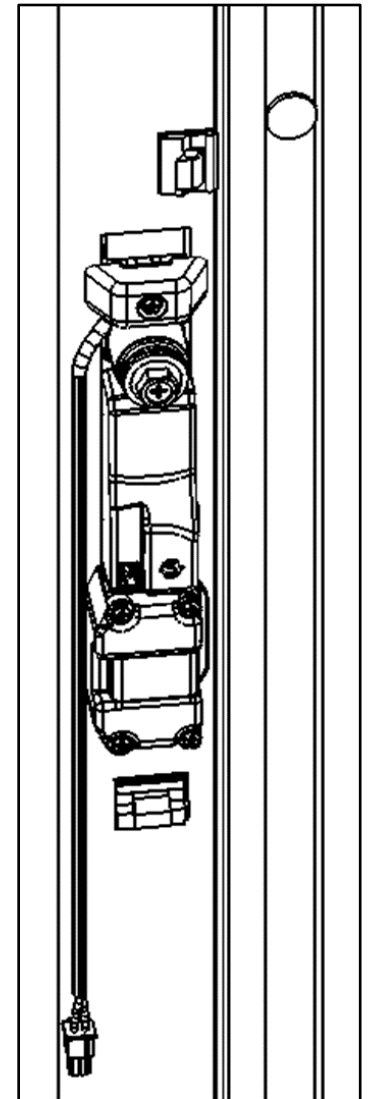
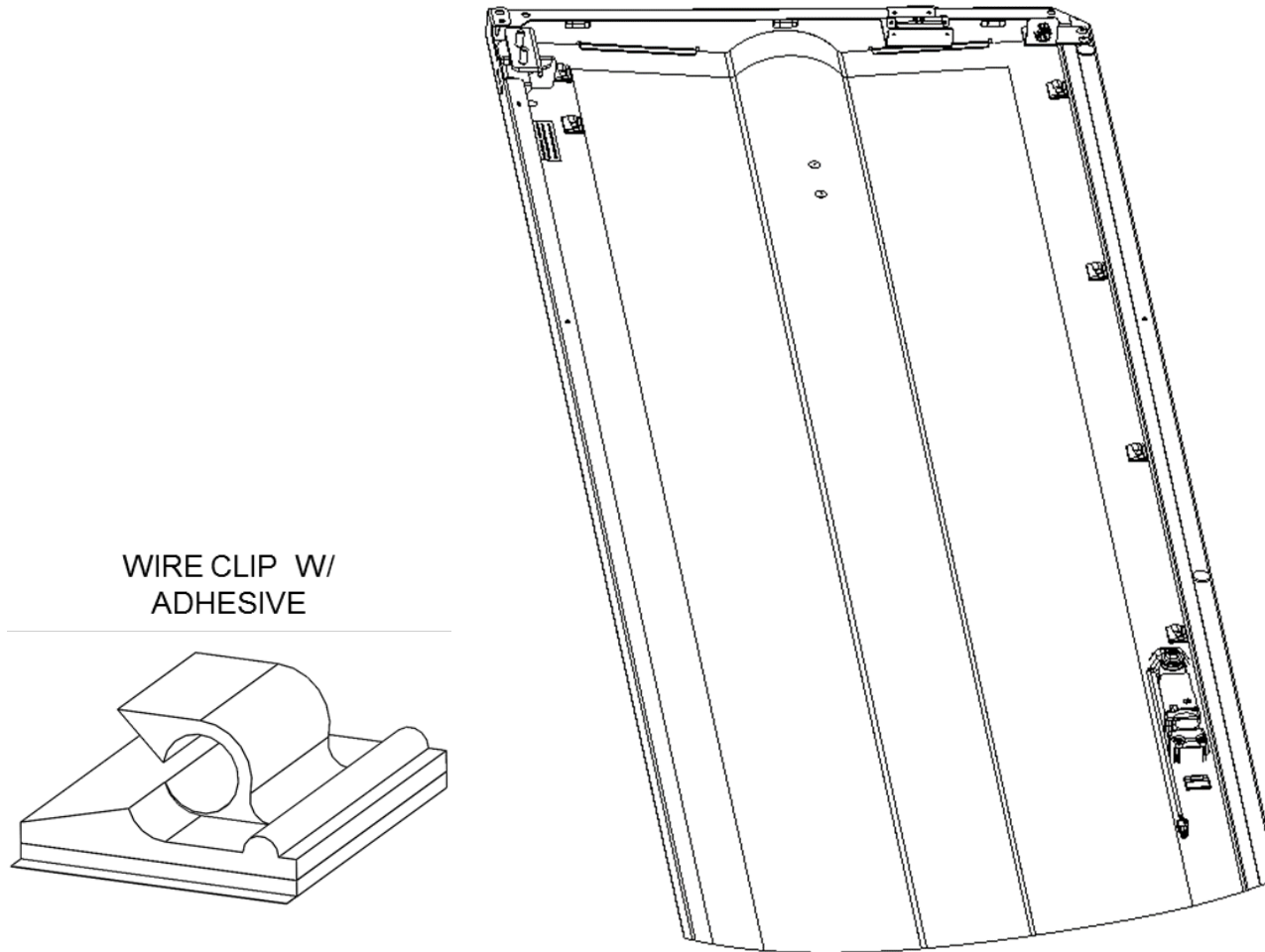

Installation Instructions

eConnect Electronic Access Control – N-Series TeraFrame Cabinet

5. ROUTE WIRES BETWEEN LATCH & CAN BUS

4. After mounting the door, plug the lock cable into the “Lock” side of the CAN Bus Module
5. Use wire clips to guide cable around frame, avoiding pinch points
6. Check and confirm that there is enough slack to allow the door to open and close fully

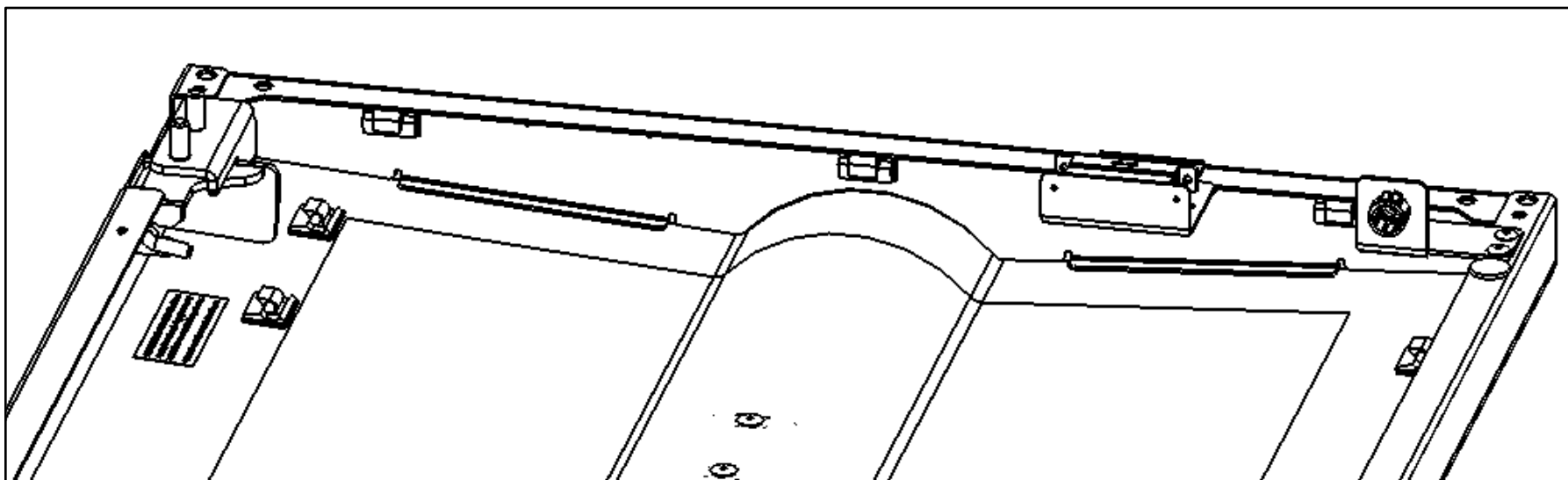

Installation Instructions

eConnect Electronic Access Control – N-Series TeraFrame Cabinet

6. ROUTE WIRES BETWEEN SWITCH & CAN BUS

1. Insert wires into sensor switch, connect switches in series.
2. Route wire inside door frame using wire clips
3. Plug other end into CAN Bus Module –
(Check and confirm that there is enough slack to allow the door to fully open and close.)



SWITCH WITH WIRES
CONNECTED



SWITCH WIRE CONNECTOR

WIRE CLIP W/
ADHESIVE

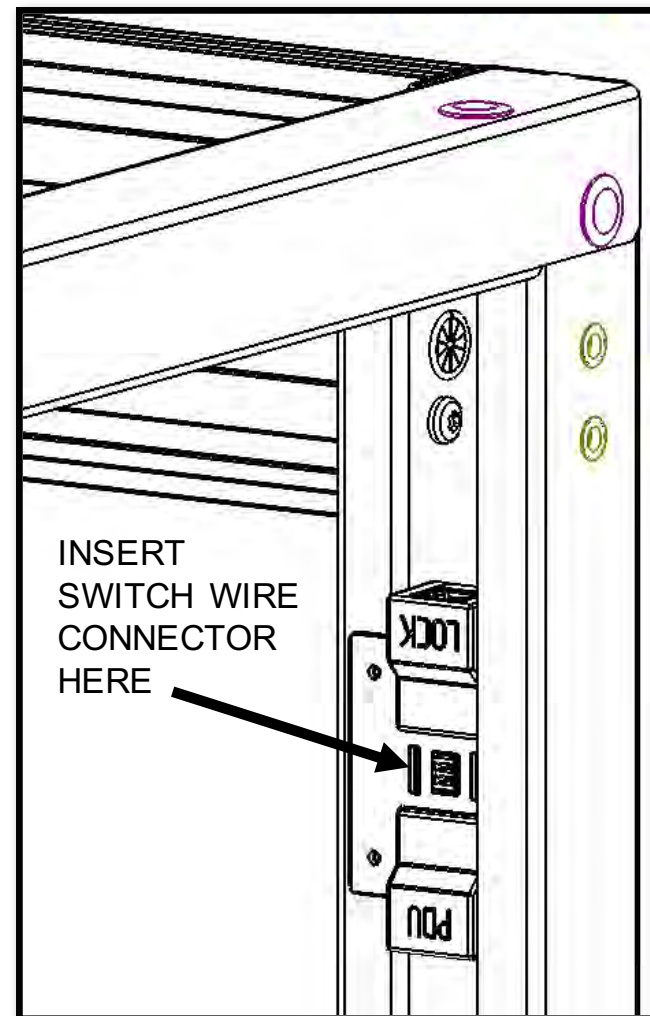
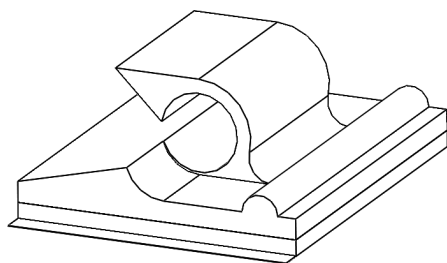

Installation Instructions

eConnect Electronic Access Control – N-Series TeraFrame Cabinet

6. ROUTE WIRES BETWEEN SWITCH & CAN BUS (DOUBLE DOOR)

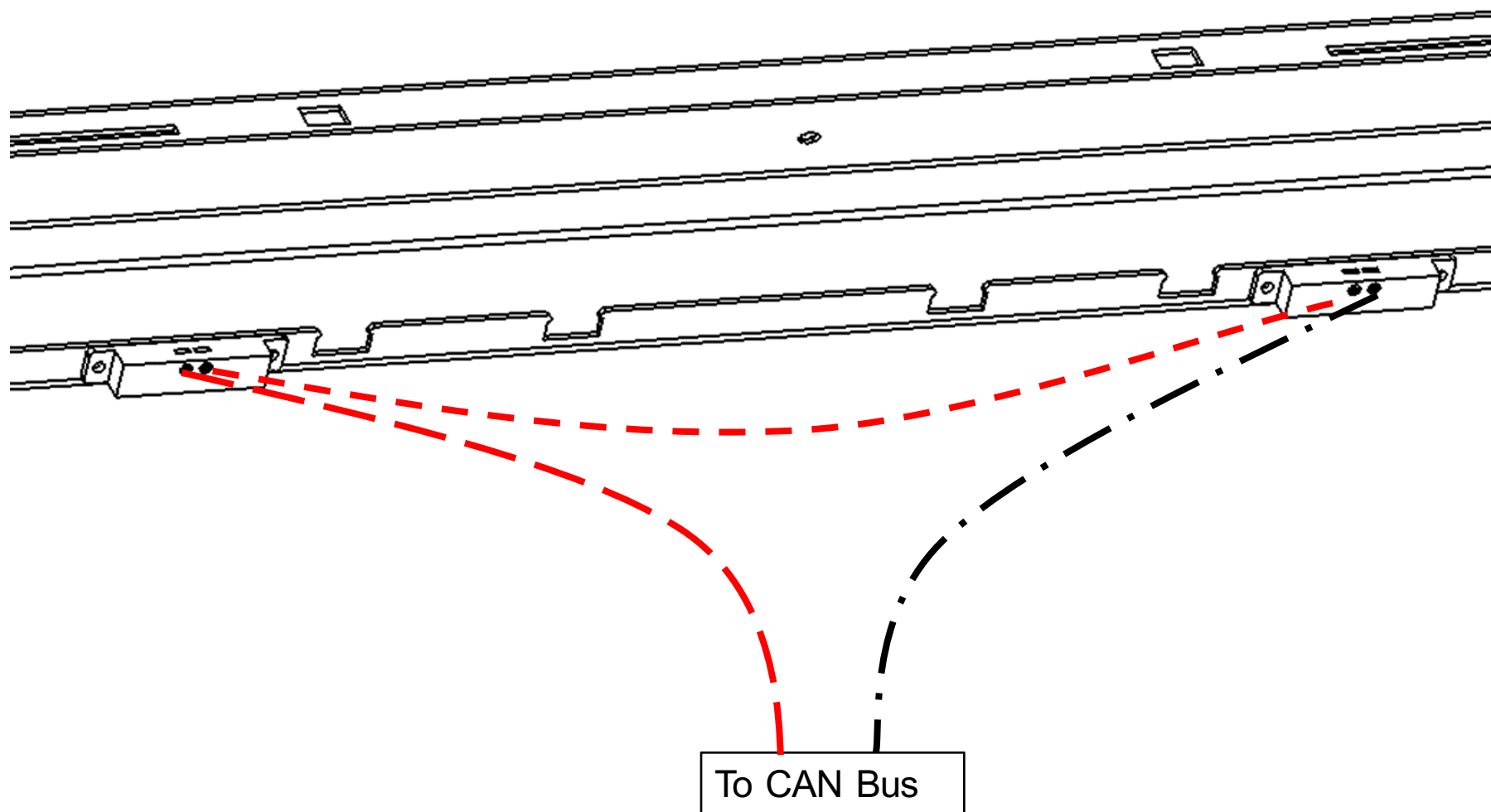

Installation Instructions

eConnect Electronic Access Control – N-Series TeraFrame Cabinet

7. ROUTE WIRES BETWEEN CAN BUS MODULE & PDU

1. Plug cable into PDU side of CAN Bus Module
2. Route the cable through grommets
3. Plug into PDU
 1. Aux 1 is for the rear door switch/latch
 2. Aux 2 is for the front door switch/latch

GROMMET
(ROUTE WIRE
FROM CAN BUS
MODULE TO PDU)

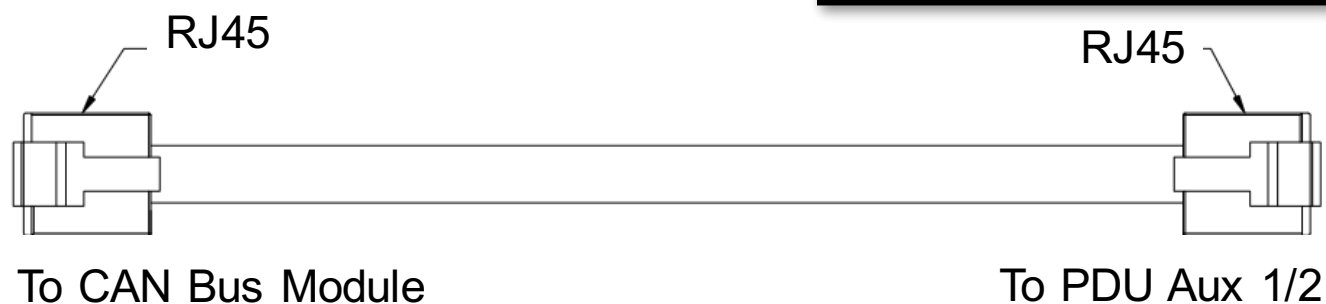
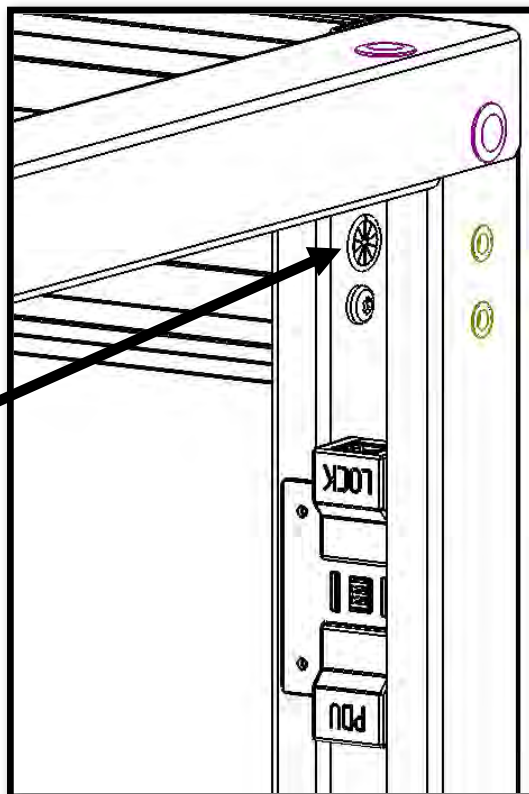

Installation Instructions

eConnect Electronic Access Control – Double-Sided Perforated Door

Includes:

025-907002-006	CLIP,CBL,ADH,BK
025-908040-009	BUSH,.437ID MAX,.125 PNL
020-736643-001	SNAP,EXTRUSION,BK
020-736644-X01	BRKT,DOOR SW,MNTG
025-907011-137	LATCH ASSEMBLY,5V
025-907011-138	CAN BUS MODULE ASSEMBLY,5V
025-907011-139	Y-HARNESS,24 GAUGE,2 METERS,BLACK
025-907011-141	PATCH CABLE,3 METERS,BLACK
025-907011-143	DOOR SWITCH KIT,BLACK
025-907011-154	PROX CARD,ELS,CPI,20 PK

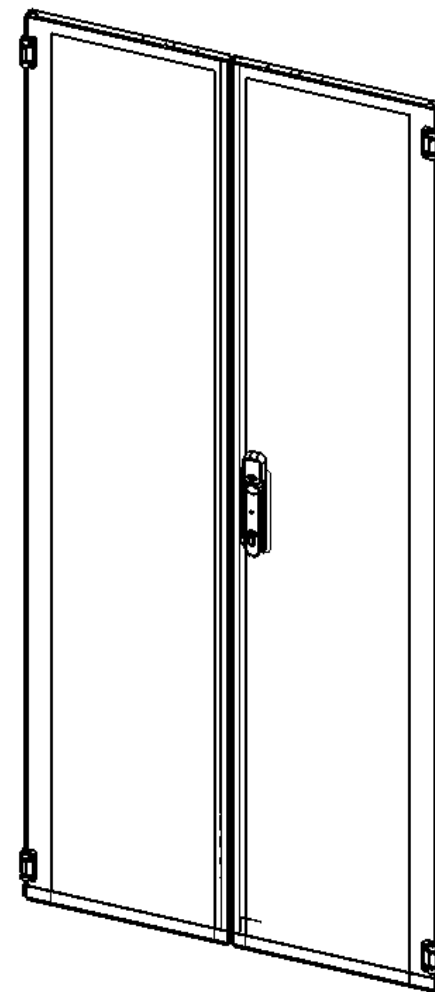
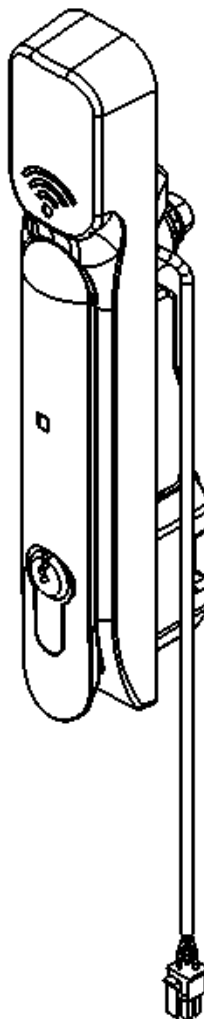

IIS-736650, 02/22/17, Rev. 1, CPI/RBF

800-834-4969 (USA & Canada) • www.chatsworth.com • techsupport@chatsworth.com
For international phone numbers, see our website or contact CPI Tech Support.

This drawing contains proprietary and confidential information and is protected by U.S. and international law. Unauthorized reproduction, disclosure or use of the drawing or the information therein is expressly forbidden except as agreed to in writing by Chatsworth Products, Inc.

Installation Instructions

eConnect Electronic Access Control – Double-Sided Perforated Door

ASSEMBLY SEQUENCE

1. Mount latch to door
2. Mount magnet to door
3. Mount CAN bus module to frame/door
4. Mount switch to frame
5. Route wires between latch and CAN bus module
6. Route wires between switch and CAN bus module
7. Route wires between CAN bus and PDU

1. MOUNT LATCH TO DOOR

1. Remove existing latch and latch components.
(the locking components must be reassembled onto the EAC latch)
1. Insert EAC latch into door.
2. Place the top mounting bracket (1) and the bottom mounting bracket (6) over the latch.

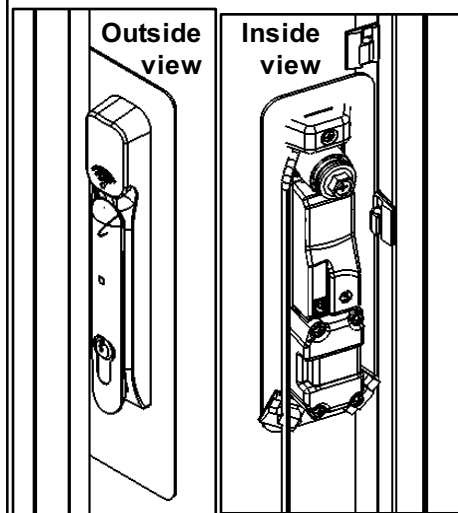
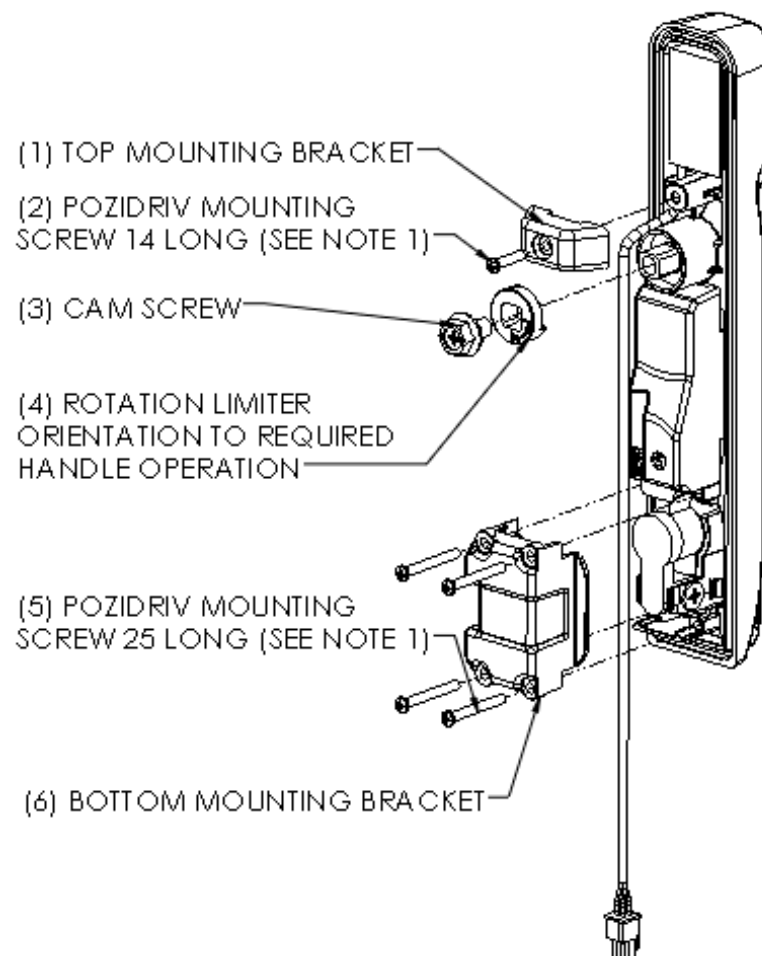

1. USE #1 POZIDRIV DRIVER WHEN INSTALLING MOUNTING SCREWS

Installation Instructions

eConnect Electronic Access Control – Double-Sided Perforated Door

1. MOUNT LATCH TO DOOR

4. Orient the rotation limiter (4) and bottom mounting bracket (6) as needed.

OPTION 1 FOR INSTALLATION
OF ROTATION LIMITER
- VIEWED FROM BACK -



LEFT HAND MOUNTING
TO OPEN: TURN HANDLE 90°
COUNTER CLOCKWISE IF VIEWED
FROM FRONT

OPTION 2 FOR INSTALLATION
OF ROTATION LIMITER
- VIEWED FROM BACK -



RIGHT HAND MOUNTING
TO OPEN: TURN HANDLE 90°
CLOCKWISE IF VIEWED
FROM FRONT

INSTALLATION OF BOTTOM MOUNTING BRACKET

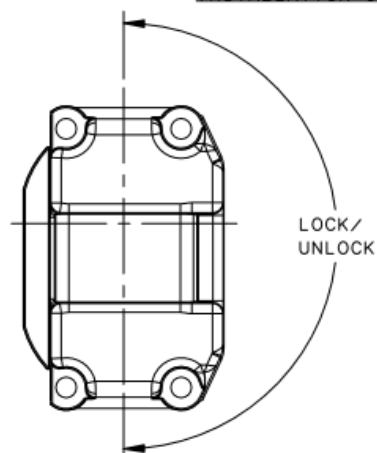

OPERATION OF LOCK PLUG CORRESPONDS WITH
ORIENTATION OF BOTTOM MOUNTING BRACKET
LEFT HAND MOUNT

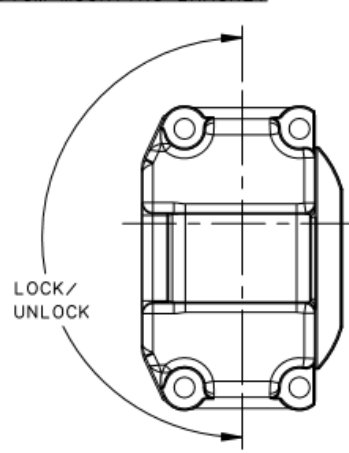

RIGHT HAND MOUNT

(1) TOP MOUNTING BRACKET

(2) POZIDRIV MOUNTING
SCREW 14 LONG (SEE NOTE 1)

(3) CAM SCREW

(4) ROTATION LIMITER
ORIENTATION TO REQUIRED
HANDLE OPERATION

(5) POZIDRIV MOUNTING
SCREW 25 LONG (SEE NOTE 1)

(6) BOTTOM MOUNTING BRACKET

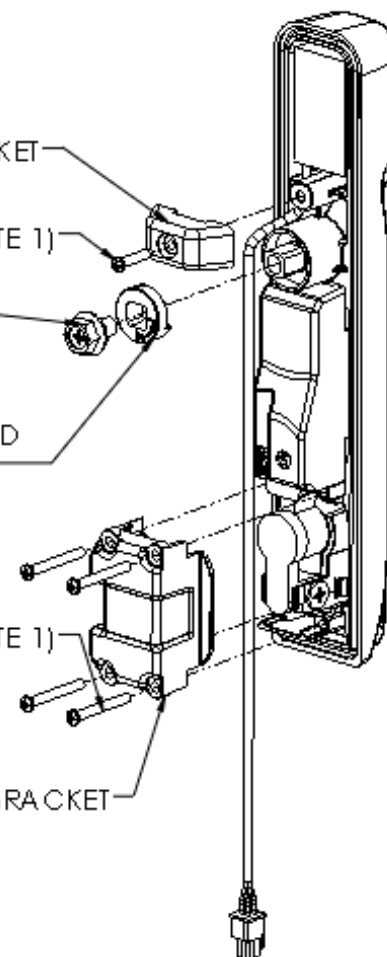

1. USE #1 POZIDRIV DRIVER WHEN
INSTALLING MOUNTING SCREWS

Installation Instructions

eConnect Electronic Access Control – Double-Sided Perforated Door

1. MOUNT LATCH TO DOOR

5. Secure top mounting bracket with pozidriv screw (2)
6. Secure bottom mounting bracket with pozidriv screws (5)
7. Re-attach locking components in the same orientation

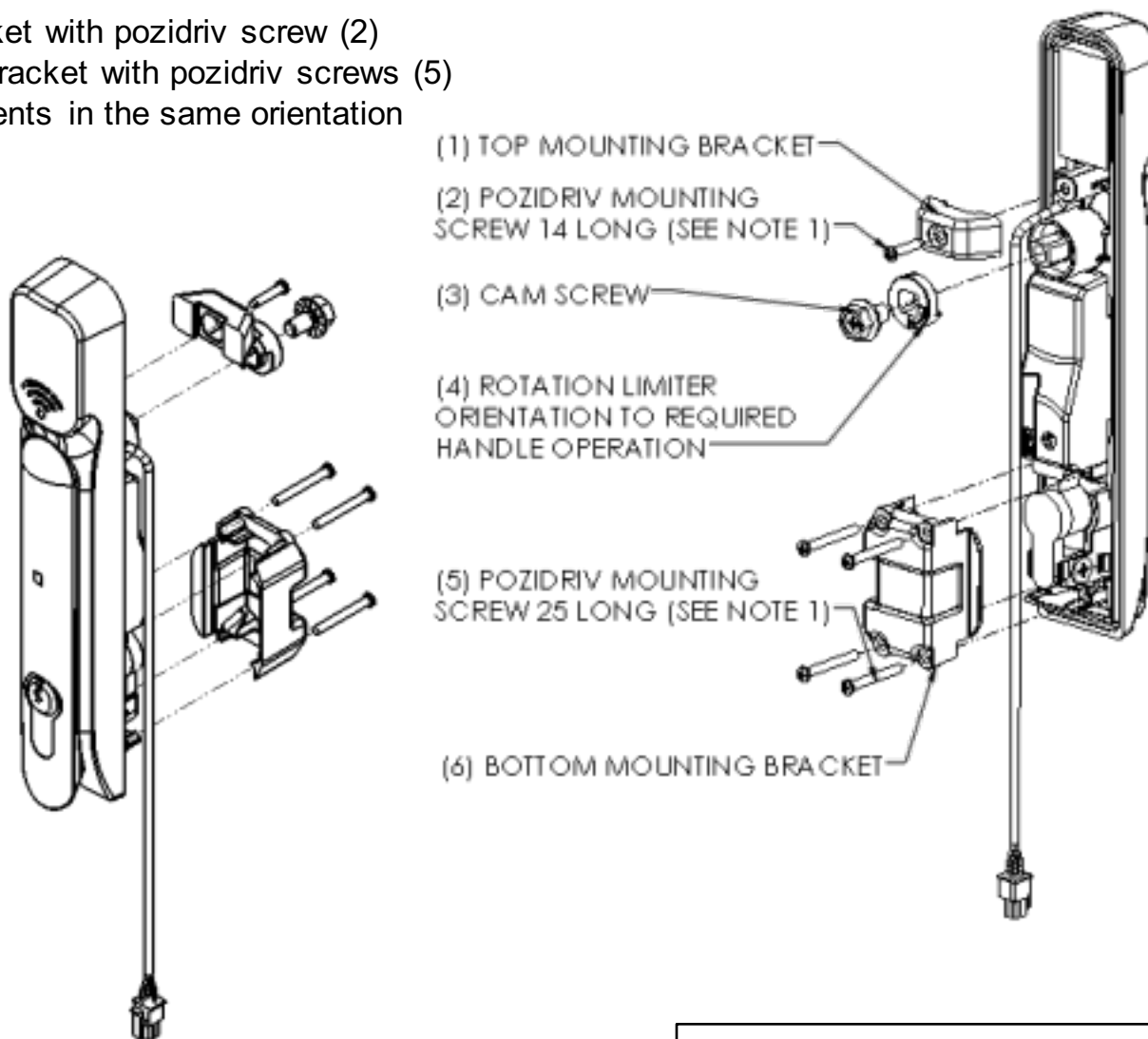
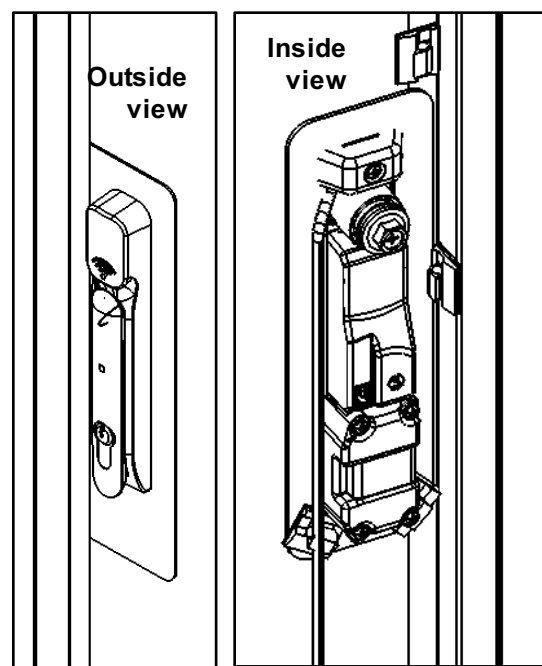

1. USE #1 POZIDRIV DRIVER WHEN INSTALLING MOUNTING SCREWS

Installation Instructions

eConnect Electronic Access Control – Double-Sided Perforated Door

2. MOUNT MAGNET TO DOOR

1. Identify differences between sensor parts



MAGNET

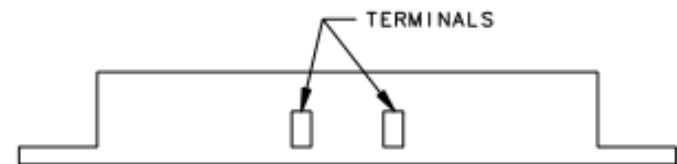

SWITCH

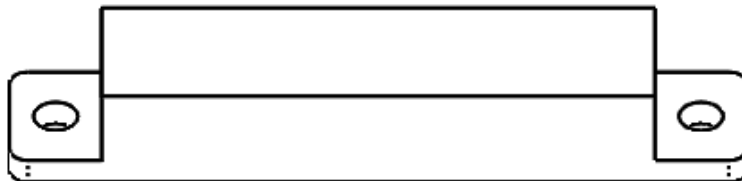

Installation Instructions

eConnect Electronic Access Control – Double-Sided Perforated Door

2. MOUNT MAGNET TO DOOR

2. Attach bracket to door, latch side, with #4 Taptite screws, in position shown.
3. Attach sensor magnet to bracket with #2 Taptite screws and adhesive (not shown).
 1. Insert first screw
 2. Peel back cover to expose adhesive
 3. Insert second screw

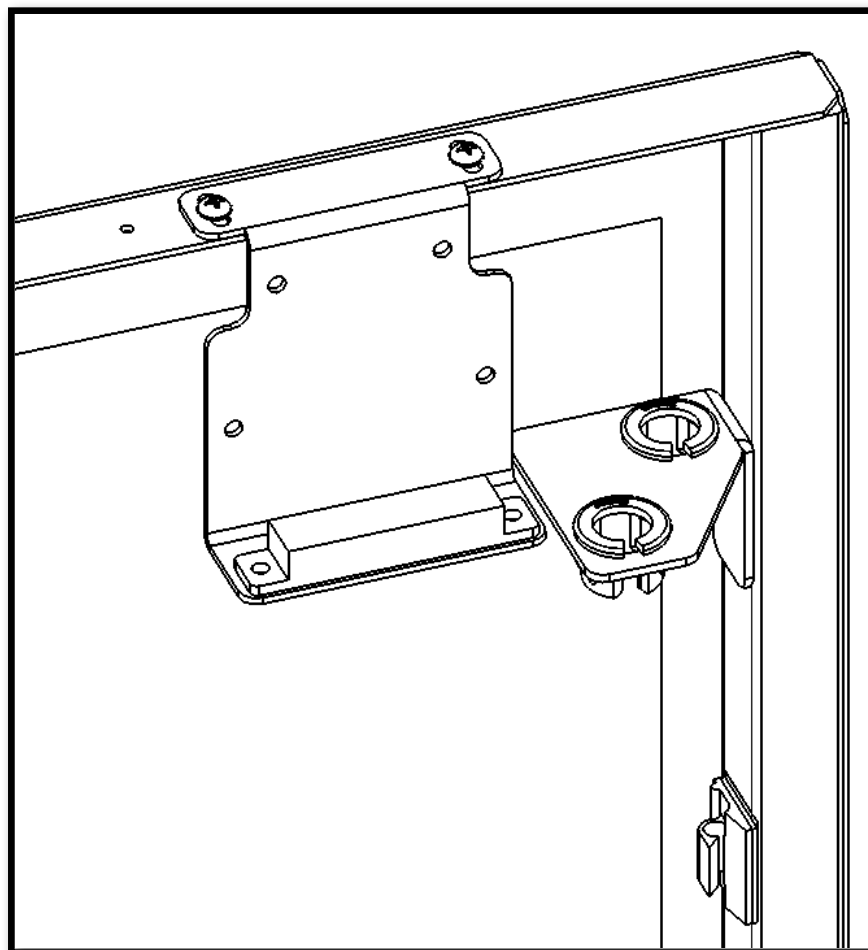

Installation Instructions

eConnect Electronic Access Control – Double-Sided Perforated Door

3. MOUNT CAN BUS TO FRAME

1. Line the mounting bracket over the pre-drilled holes on the cabinet frame
2. Attach the bracket to the frame, using the #4 screws
3. Place the module behind the bracket
4. Push together until it snaps into place

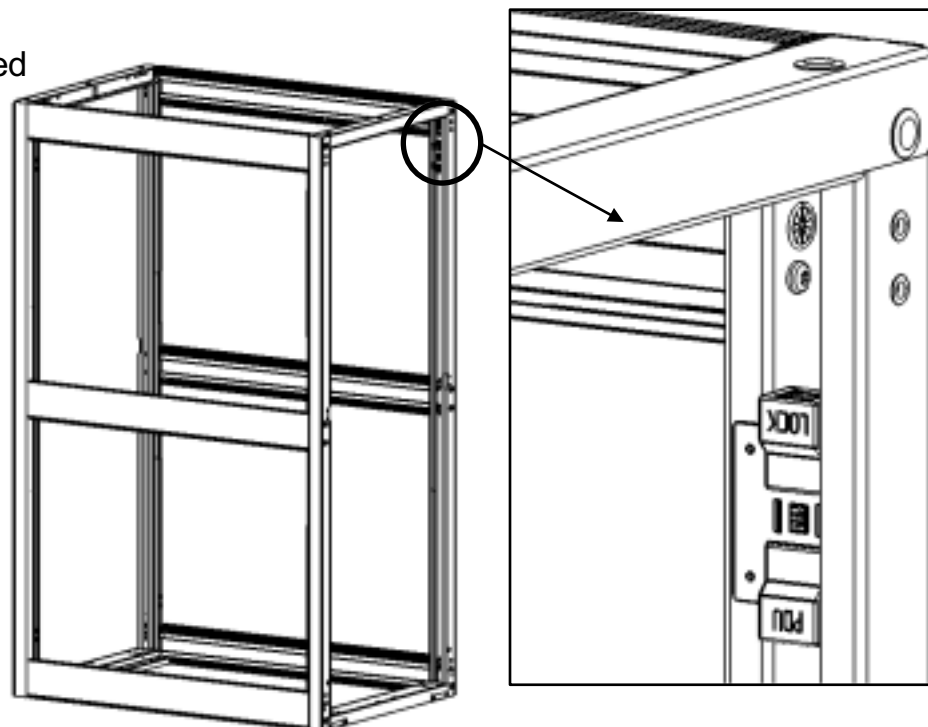
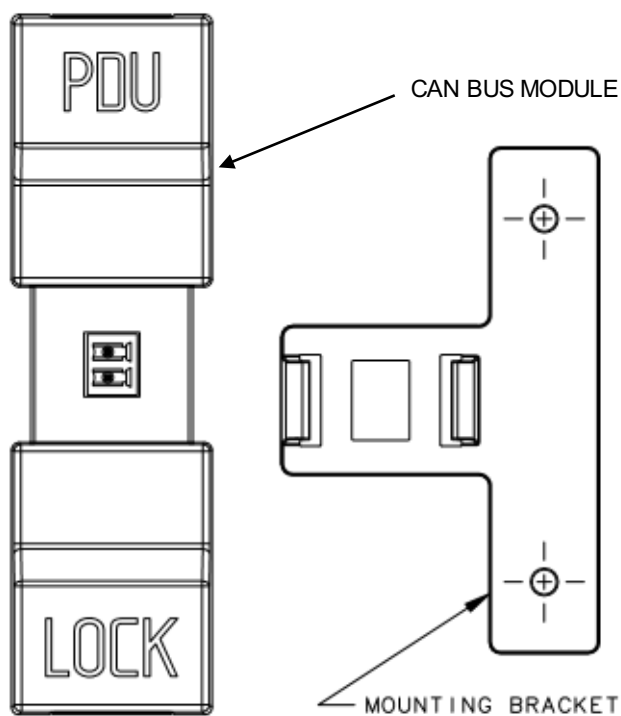

Installation Instructions

eConnect Electronic Access Control – Double-Sided Perforated Door

4. MOUNT SWITCH TO FRAME

1. Attach sensor switches to frame with #2 Taptite screws and adhesive (not shown).
 1. Insert first screw into pre-drilled hole
 2. Peel back cover to expose adhesive
 3. Insert second screw into pre-drilled hole

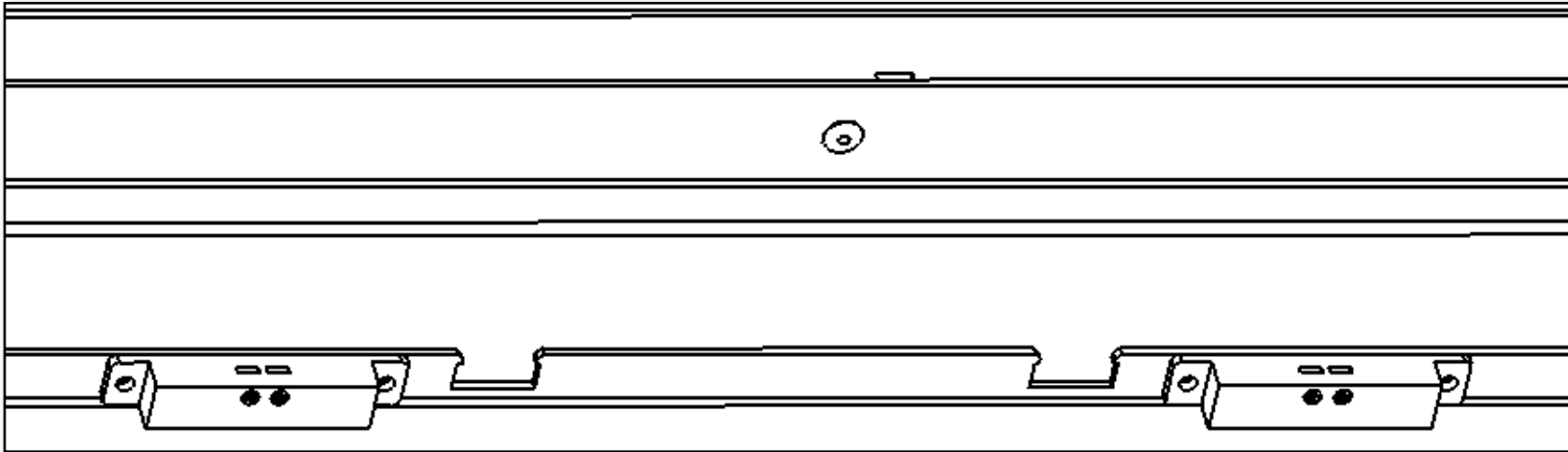

Installation Instructions

eConnect Electronic Access Control – Double-Sided Perforated Door

5. ROUTE WIRES BETWEEN LATCH & CAN BUS

1. Run cable through plastic grommet at top of door
2. Use wire clips to run cable below the latch and toward the top of the door
3. Direct cable along the top of the door toward the hinge

WIRE CLIP W/
ADHESIVE

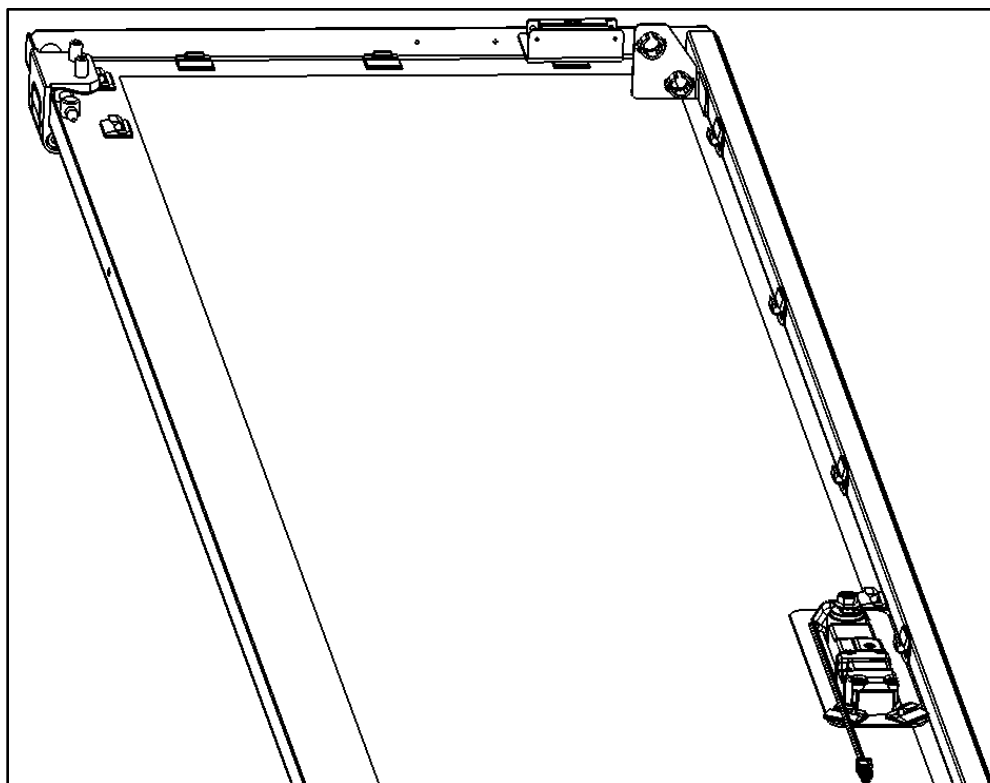
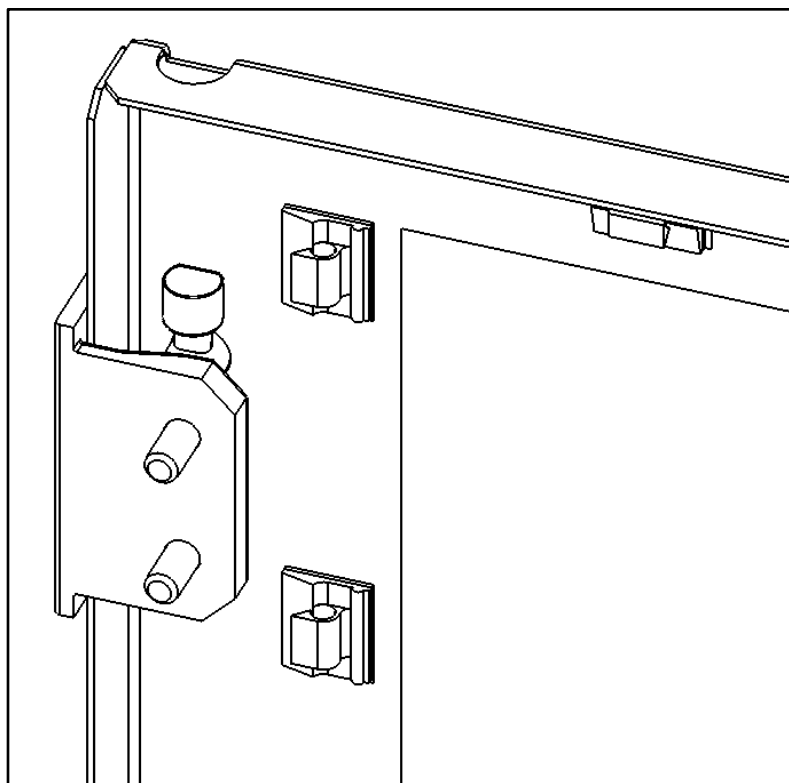
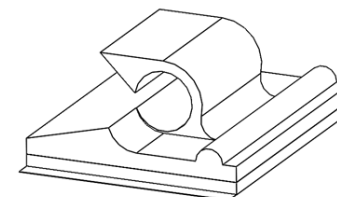

Installation Instructions

eConnect Electronic Access Control – Double-Sided Perforated Door

5. ROUTE WIRES BETWEEN LATCH & CAN BUS

4. Plug the lock cable into the “Lock” side of the CAN Bus Module
5. Use wire clips to guide cable around frame, avoiding pinch points
6. Check and confirm that there is enough slack to allow the door to fully open and close

To Latch



To Latch



To CAN Bus
Module: Lock Side



Installation Instructions

eConnect Electronic Access Control – Double-Sided Perforated Door

6. ROUTE WIRES BETWEEN SWITCH & CAN BUS

1. Insert wires into sensor switch, connect switches in series.
2. Route wire inside door frame using wire clips
3. Plug other end into CAN Bus Module –
(Check and confirm that there is enough slack to allow the door to fully open and close.)



SWITCH WITH WIRES
CONNECTED



SWITCH WIRE CONNECTOR

WIRE CLIP W/
ADHESIVE

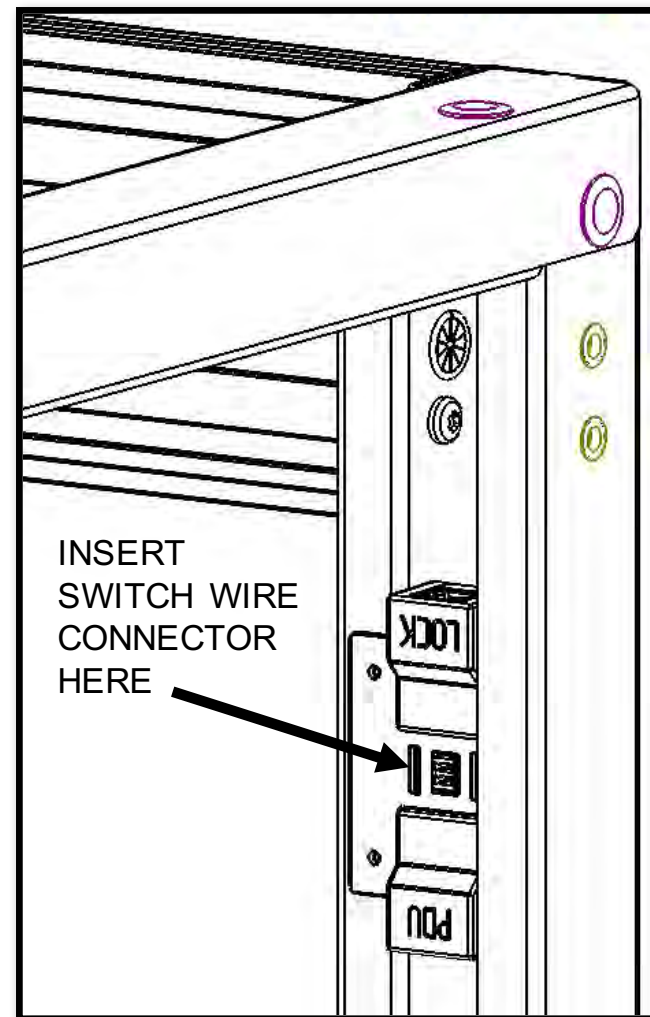
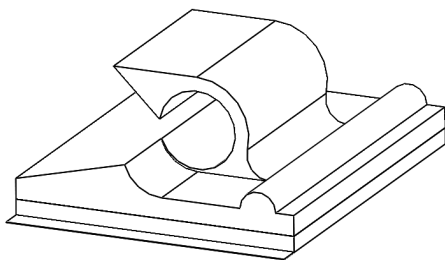

Installation Instructions

eConnect Electronic Access Control – Double-Sided Perforated Door

6. ROUTE WIRES BETWEEN SWITCH & CAN BUS

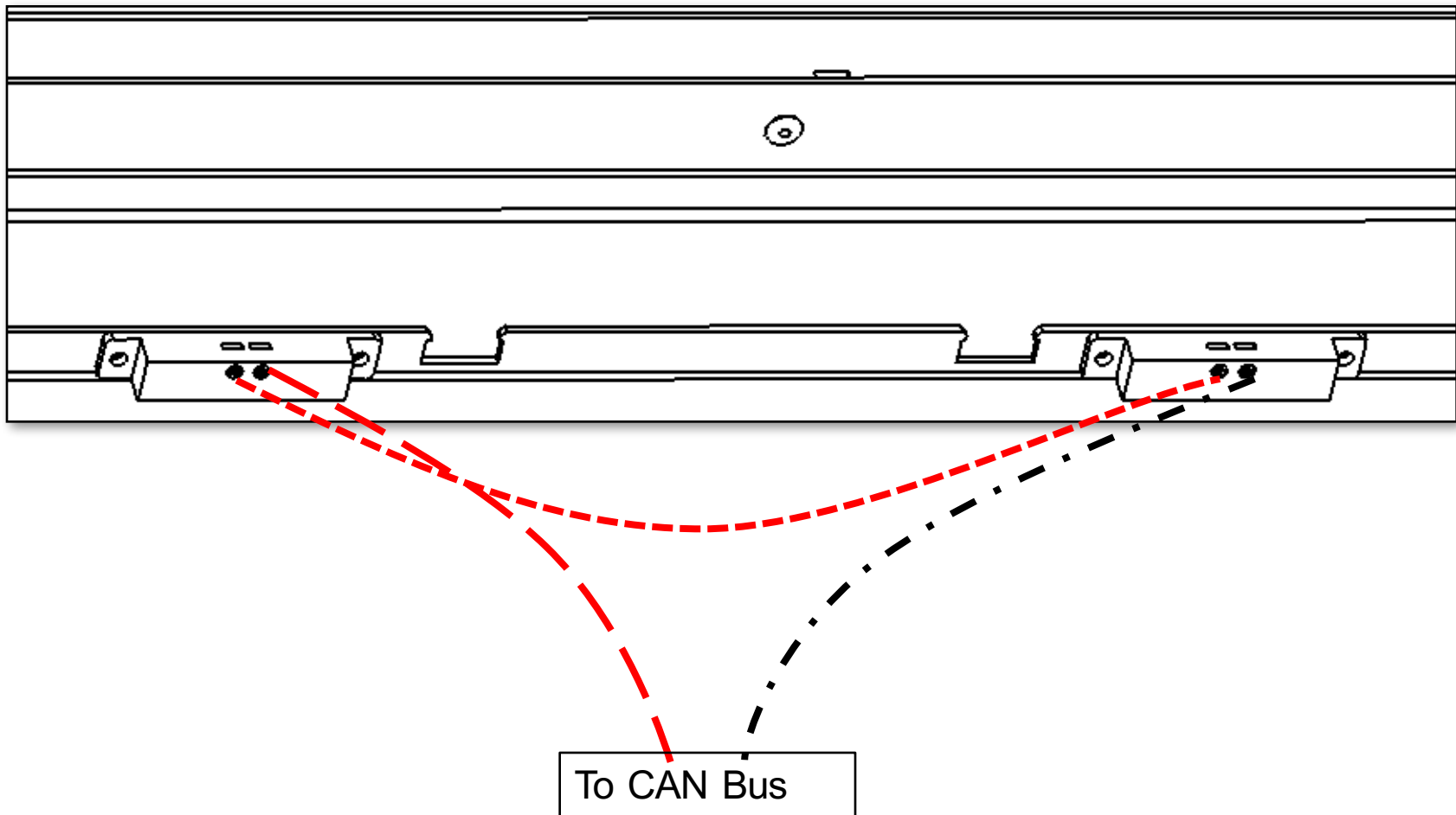

Installation Instructions

eConnect Electronic Access Control – Double-Sided Perforated Door

7. ROUTE WIRES BETWEEN CAN BUS MODULE & PDU

1. Plug cable into PDU side of CAN Bus Module
2. Route the cable through grommets
3. Plug into PDU
 1. Aux 1 is for the rear door switch/latch
 2. Aux 2 is for the front door switch/latch

GROMMET
(ROUTE WIRE
FROM CAN BUS
MODULE TO PDU)

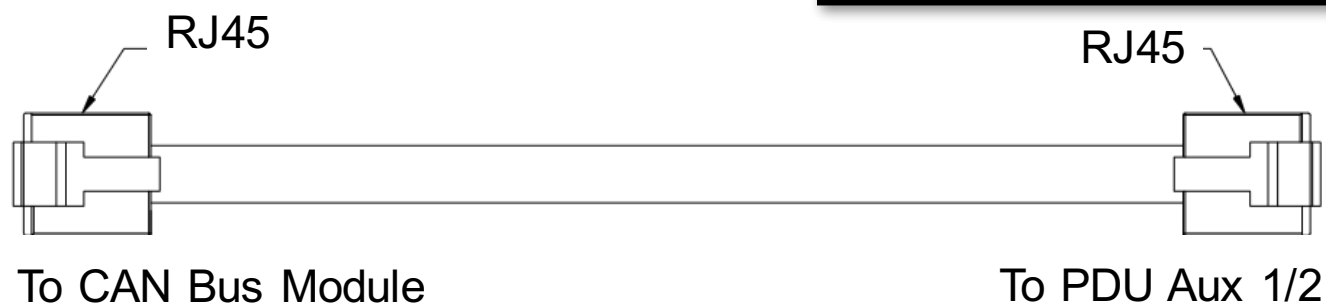
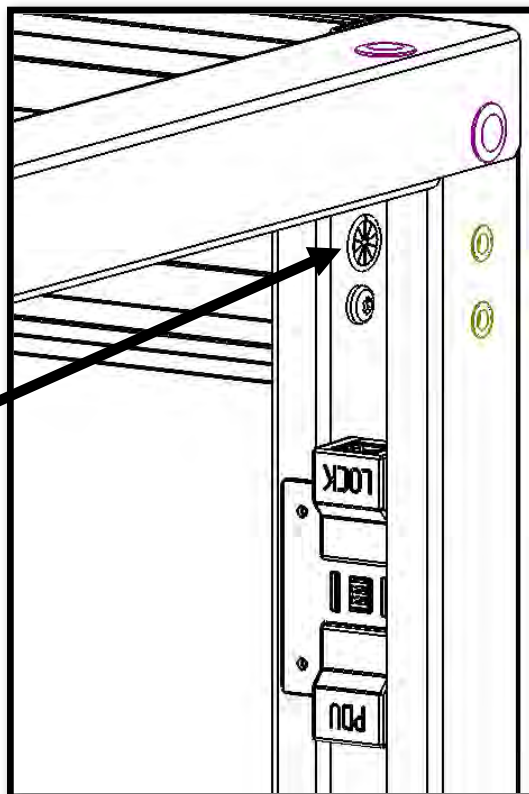

Installation Instructions

eConnect Electronic Access Control – Single, Solid Door with Gaskets

Includes:

025-907002-006	CLIP,CBL,ADH,BK
025-908040-009	BUSH,.437ID MAX,.125 PNL
020-736643-001	SNAP,EXTRUSION,BK
020-736644-X01	BRKT,DOOR SW,MNTG
025-907011-137	LATCH ASSEMBLY,5V
025-907011-138	CAN BUS MODULE ASSEMBLY,5V
025-907011-139	Y-HARNESS,24 GAUGE,2 METERS,BLACK
025-907011-141	PATCH CABLE,3 METERS,BLACK
025-907011-143	DOOR SWITCH KIT,BLACK
025-907011-154	PROX CARD,ELS,CPI,20 PK

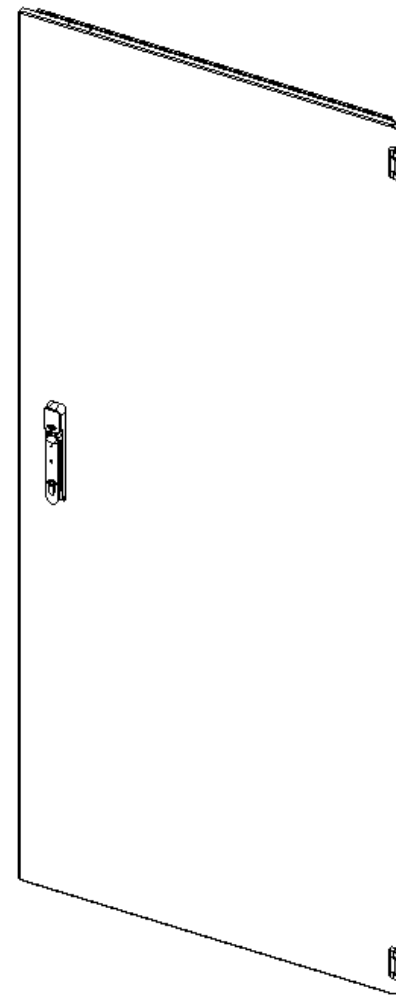
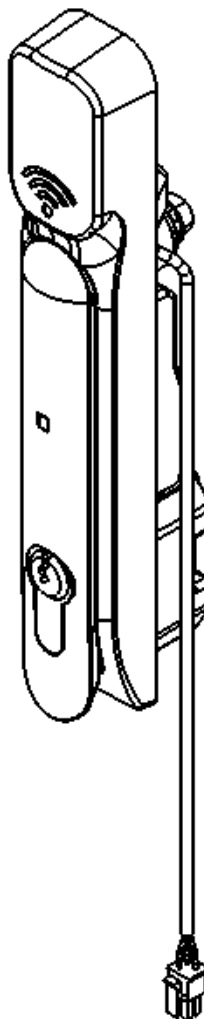

CHATSWORTH PRODUCTS, INC.

IIS-736650, 02/22/17, Rev. 1, CPI/RBF

800-834-4969 (USA & Canada) • www.chatsworth.com • techsupport@chatsworth.com

For international phonenumbers, see our website or contact CPI Tech Support.

This drawing contains proprietary and confidential information and is protected by U.S. and international law. Unauthorized reproduction, disclosure or use of the drawing or the information therein is expressly forbidden except as agreed to in writing by Chatsworth Products, Inc.

Installation Instructions

eConnect Electronic Access Control – Single, Solid Door with Gaskets

ASSEMBLY SEQUENCE

1. Mount latch to door
2. Mount magnet to door
3. Mount CAN bus module to frame/door
4. Mount switch to frame
5. Route wires between latch and CAN bus module
6. Route wires between switch and CAN bus module
7. Route wires between CAN bus and PDU

1. MOUNT LATCH TO DOOR

1. Remove existing latch and latch components.
(the locking components must be reassembled onto the EAC latch)
1. Insert EAC latch into door.
2. Place the top mounting bracket (1) and the bottom mounting bracket (6) over the latch.

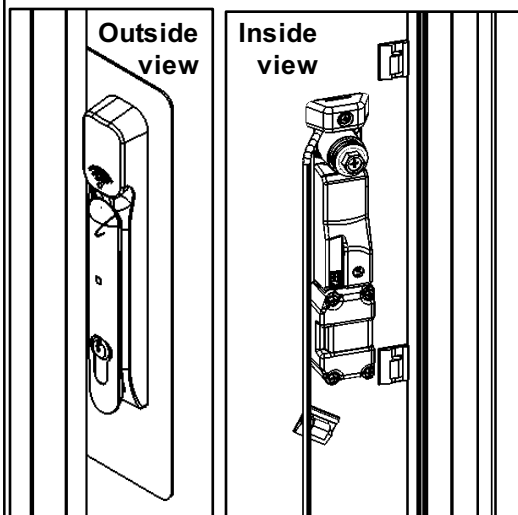
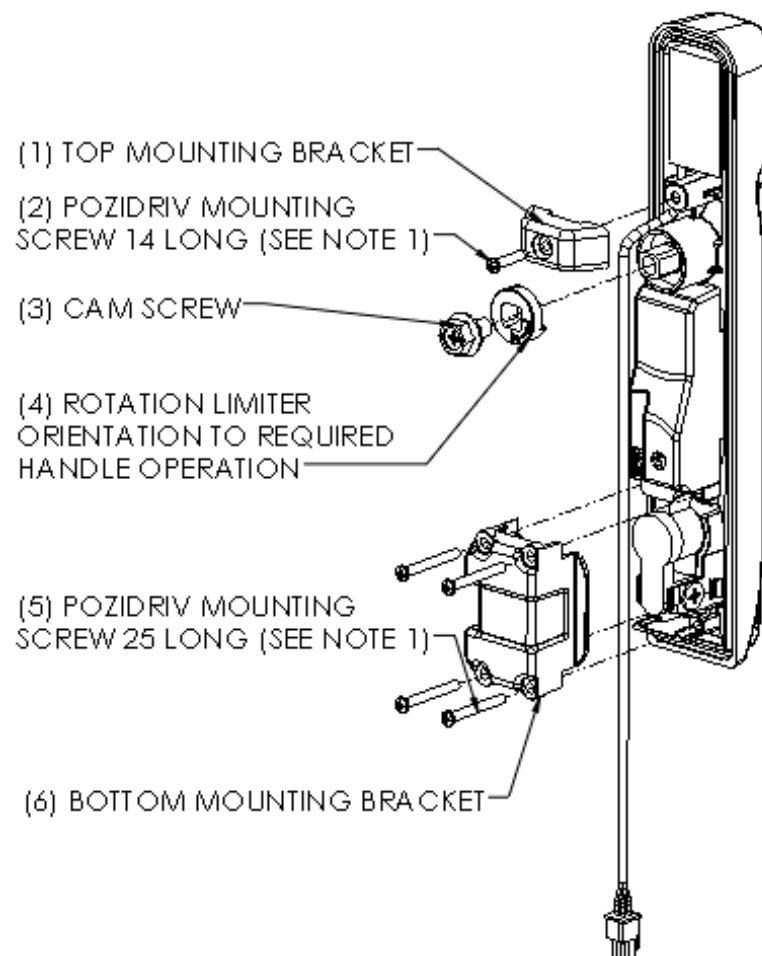

1. USE #1 POZIDRIV DRIVER WHEN INSTALLING MOUNTING SCREWS

Installation Instructions

eConnect Electronic Access Control – Single, Solid Door with Gaskets

1. MOUNT LATCH TO DOOR

4. Orient the rotation limiter (4) and bottom mounting bracket (6) as needed.

OPTION 1 FOR INSTALLATION
OF ROTATION LIMITER
- VIEWED FROM BACK -

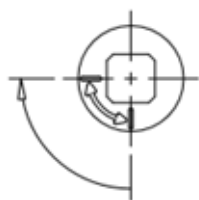

LEFT HAND MOUNTING
TO OPEN: TURN HANDLE 90°
COUNTER CLOCKWISE IF VIEWED
FROM FRONT

OPTION 2 FOR INSTALLATION
OF ROTATION LIMITER
- VIEWED FROM BACK -

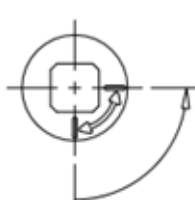

RIGHT HAND MOUNTING
TO OPEN: TURN HANDLE 90°
CLOCKWISE IF VIEWED
FROM FRONT

INSTALLATION OF BOTTOM MOUNTING BRACKET

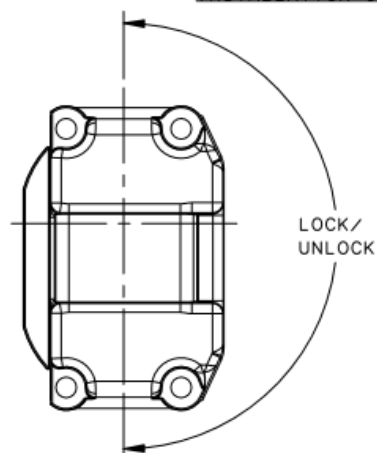

OPERATION OF LOCK PLUG CORRESPONDS WITH
ORIENTATION OF BOTTOM MOUNTING BRACKET
LEFT HAND MOUNT

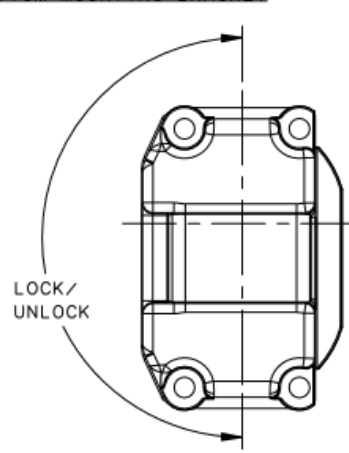

RIGHT HAND MOUNT

(1) TOP MOUNTING BRACKET

(2) POZIDRIV MOUNTING
SCREW 14 LONG (SEE NOTE 1)

(3) CAM SCREW

(4) ROTATION LIMITER
ORIENTATION TO REQUIRED
HANDLE OPERATION

(5) POZIDRIV MOUNTING
SCREW 25 LONG (SEE NOTE 1)

(6) BOTTOM MOUNTING BRACKET

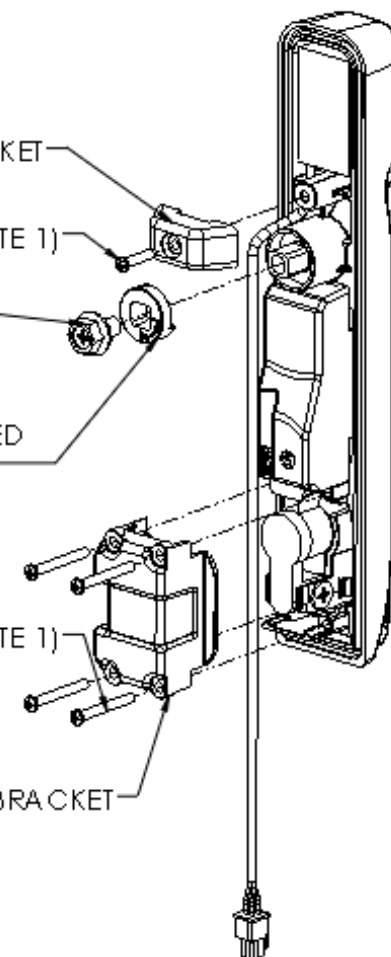

1. USE #1 POZIDRIV DRIVER WHEN
INSTALLING MOUNTING SCREWS

Installation Instructions

eConnect Electronic Access Control – Single, Solid Door with Gaskets

1. MOUNT LATCH TO DOOR

5. Secure top mounting bracket with pozidriv screw (2)
6. Secure bottom mounting bracket with pozidriv screws (5)
7. Re-attach locking components in the same orientation

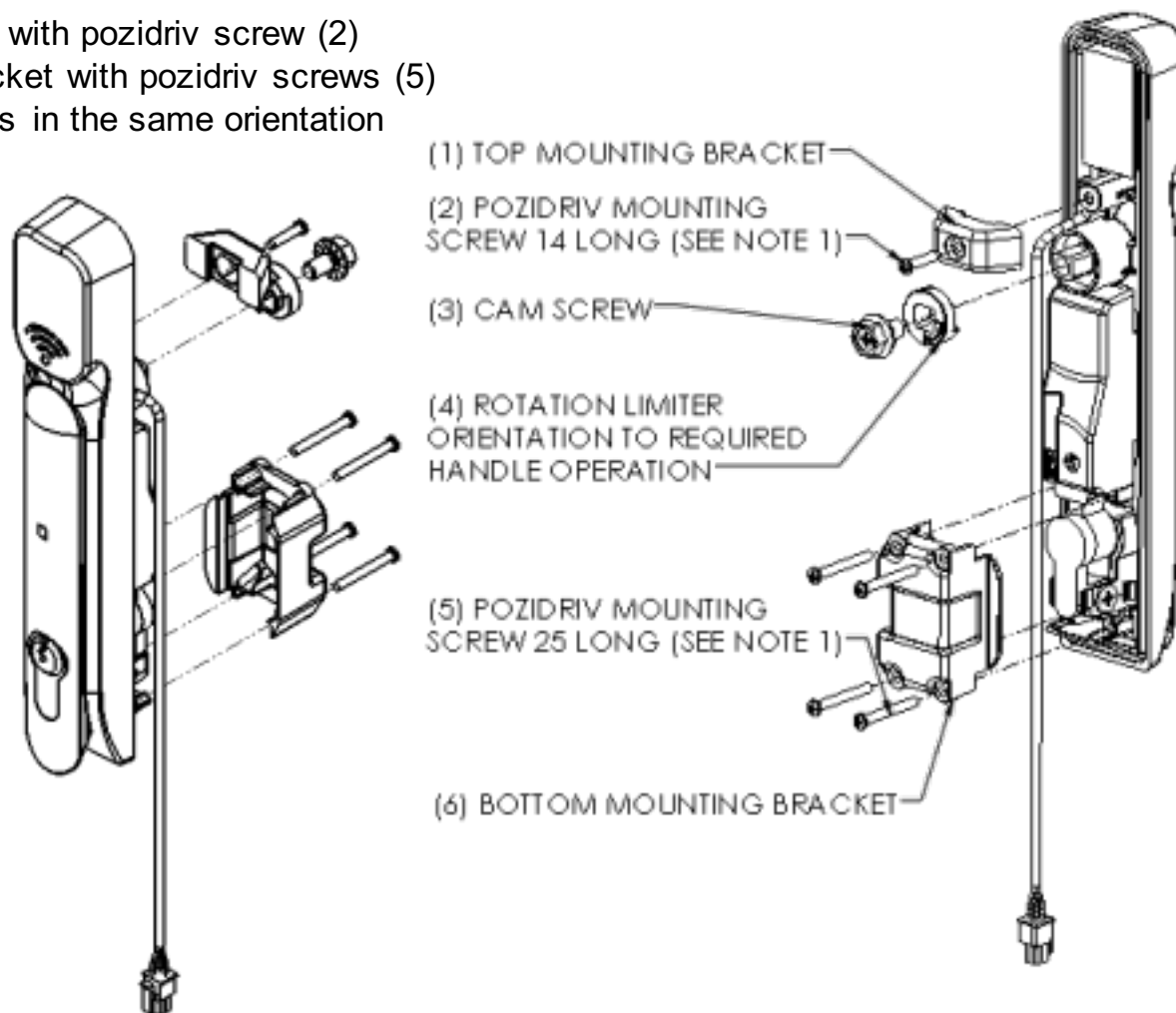
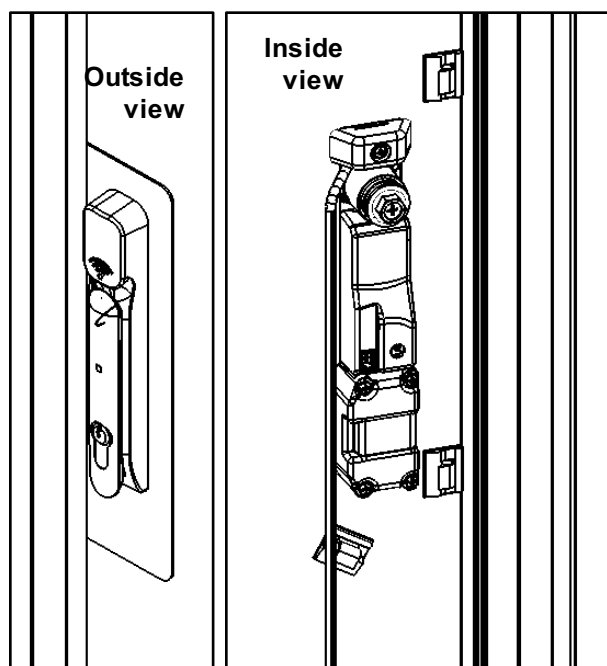

1. USE #1 POZIDRIV DRIVER WHEN INSTALLING MOUNTING SCREWS

Installation Instructions

eConnect Electronic Access Control – Single, Solid Door with Gaskets

2. MOUNT MAGNET TO DOOR

1. Identify differences between sensor parts



MAGNET

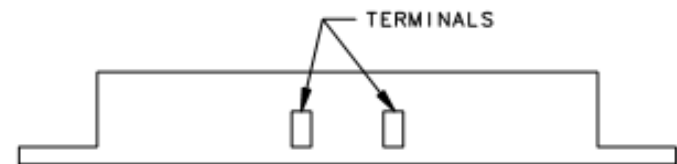

SWITCH



Installation Instructions

eConnect Electronic Access Control – Single, Solid Door with Gaskets

2. MOUNT MAGNET TO DOOR

2. Attach bracket to door, latch side, with #4 Taptite screws, in position shown. Peel back door gasket, place bracket underneath and re-seal gasket to door
3. Attach sensor magnet to bracket with #2 Taptite screws and adhesive (not shown).
 1. Insert first screw
 2. Peel back cover to expose adhesive
 3. Insert second screw

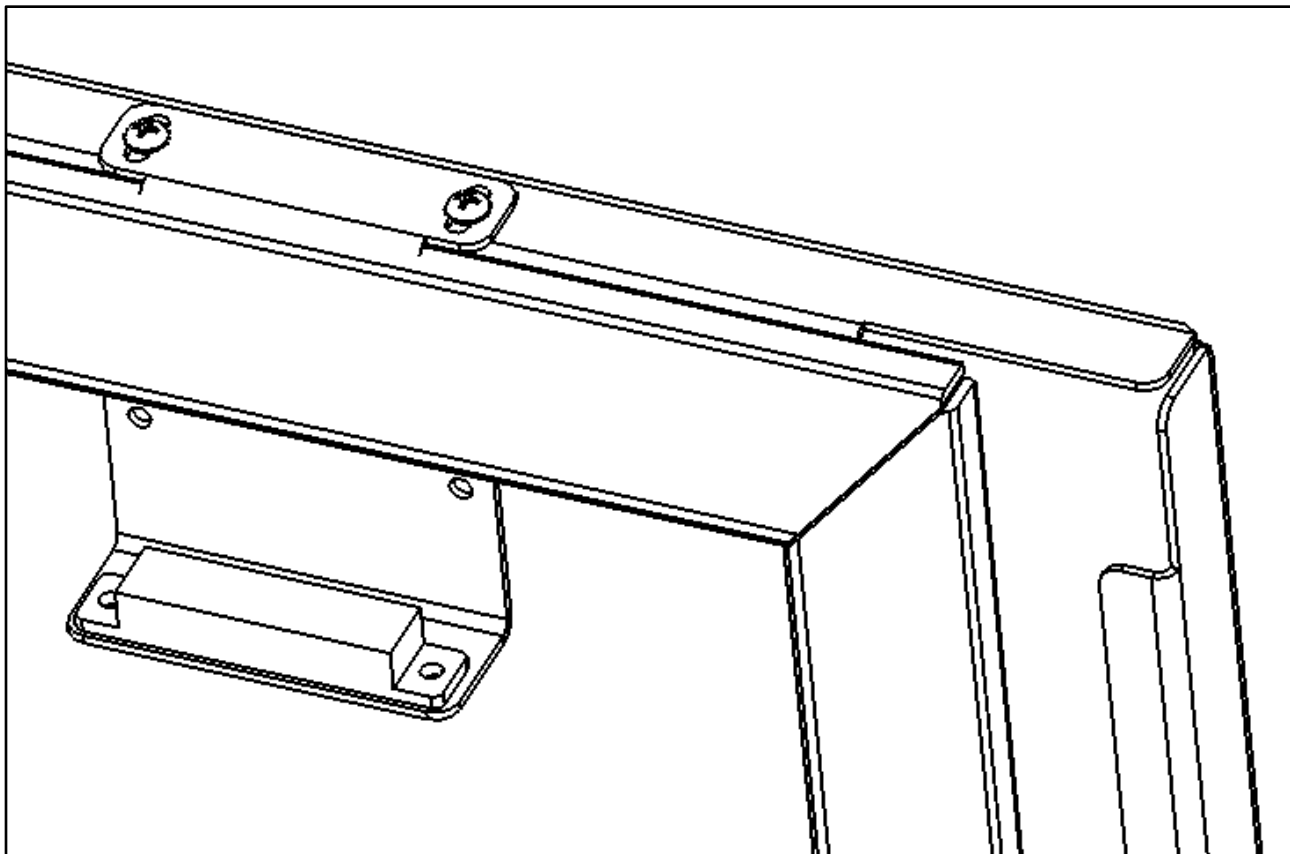

Installation Instructions

eConnect Electronic Access Control – Single, Solid Door with Gaskets

3. MOUNT CAN BUS TO FRAME

1. Line the mounting bracket over the pre-drilled holes on the cabinet frame
2. Attach the bracket to the frame, using the #4 screws
3. Place the module behind the bracket
4. Push together until it snaps into place

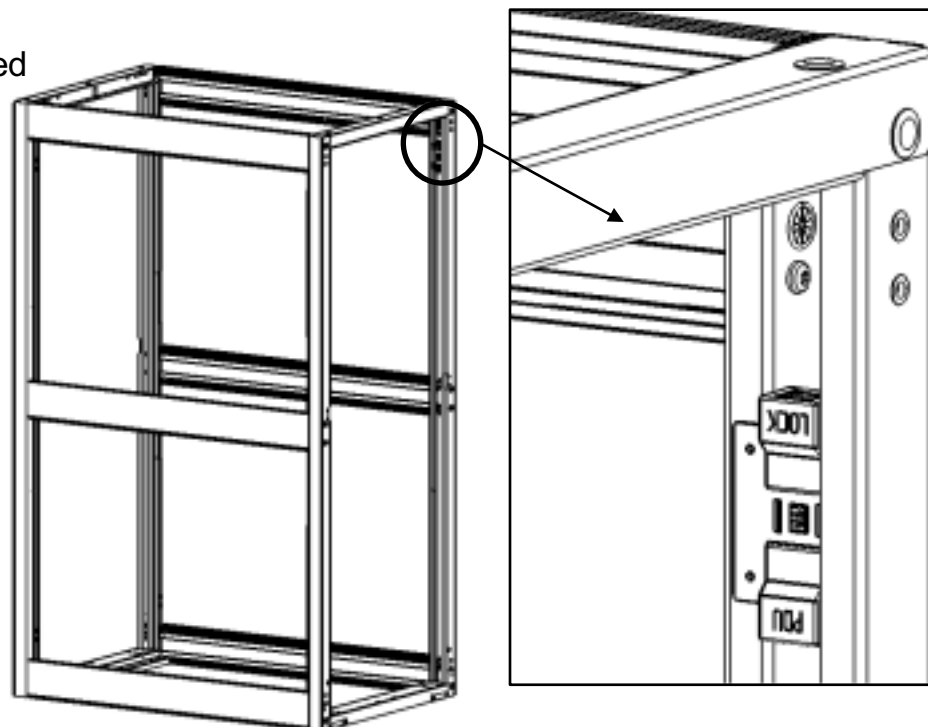
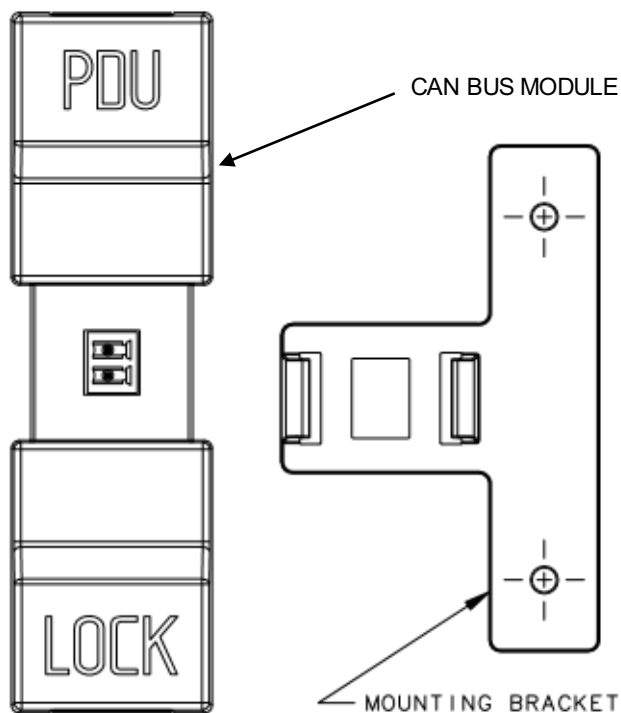

Installation Instructions

eConnect Electronic Access Control – Single, Solid Door with Gaskets

4. MOUNT SWITCH TO FRAME

1. Attach sensor switches to frame on latch side, with #2 Taptite screws and adhesive (not shown).
 1. Insert first screw into pre-drilled hole
 2. Peel back cover to expose adhesive
 3. Insert second screw into pre-drilled hole

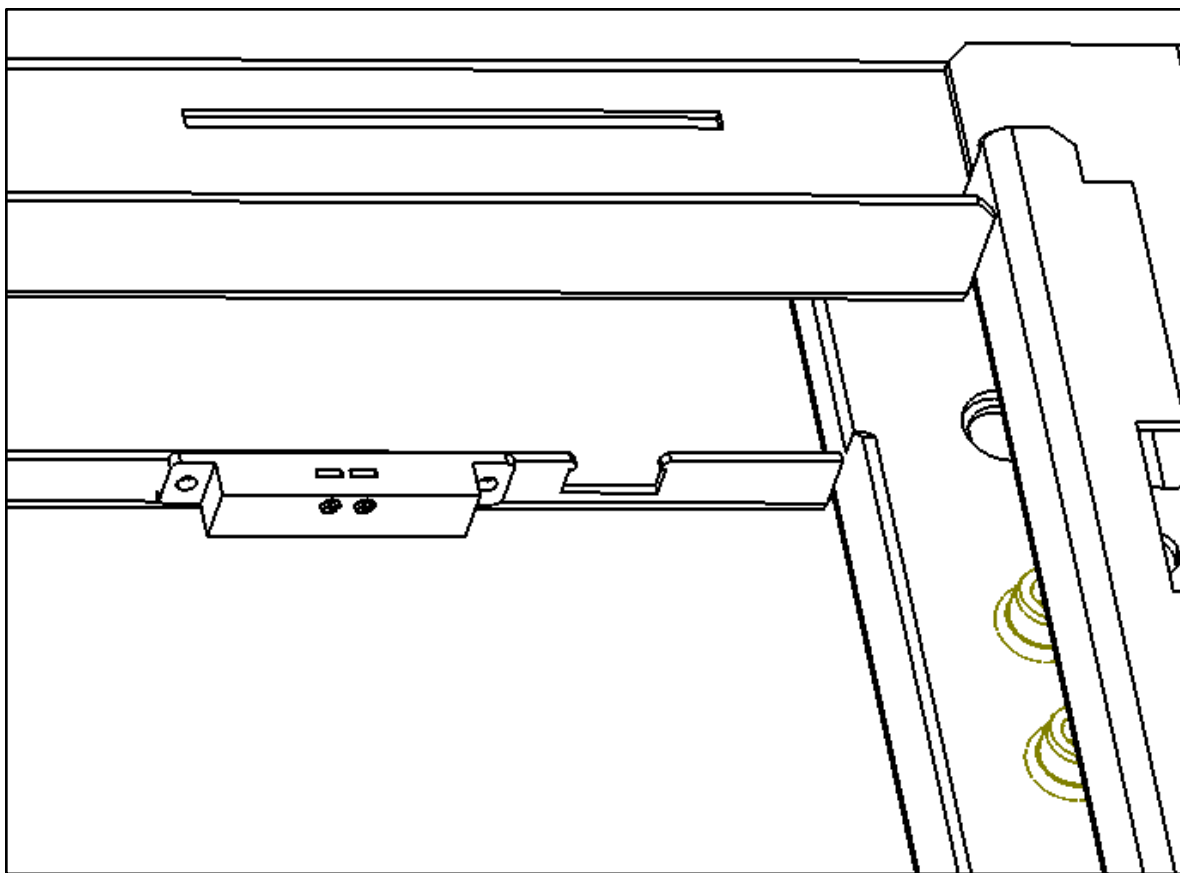

Installation Instructions

eConnect Electronic Access Control – Single, Solid Door with Gaskets

5. ROUTE WIRES BETWEEN LATCH & CAN BUS

1. Route cable along perimeter of door with wire clips
2. Use wire clips to run cable below the latch and toward the top of the door
3. Direct cable along the top of the door toward the hinge

WIRE CLIP W/
ADHESIVE

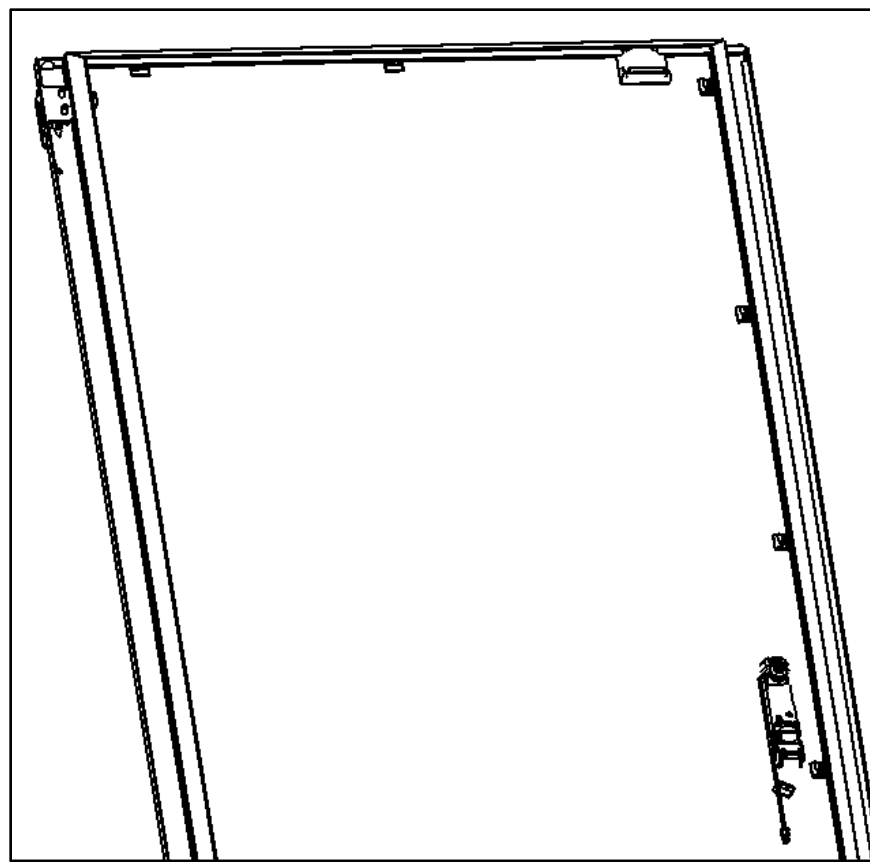
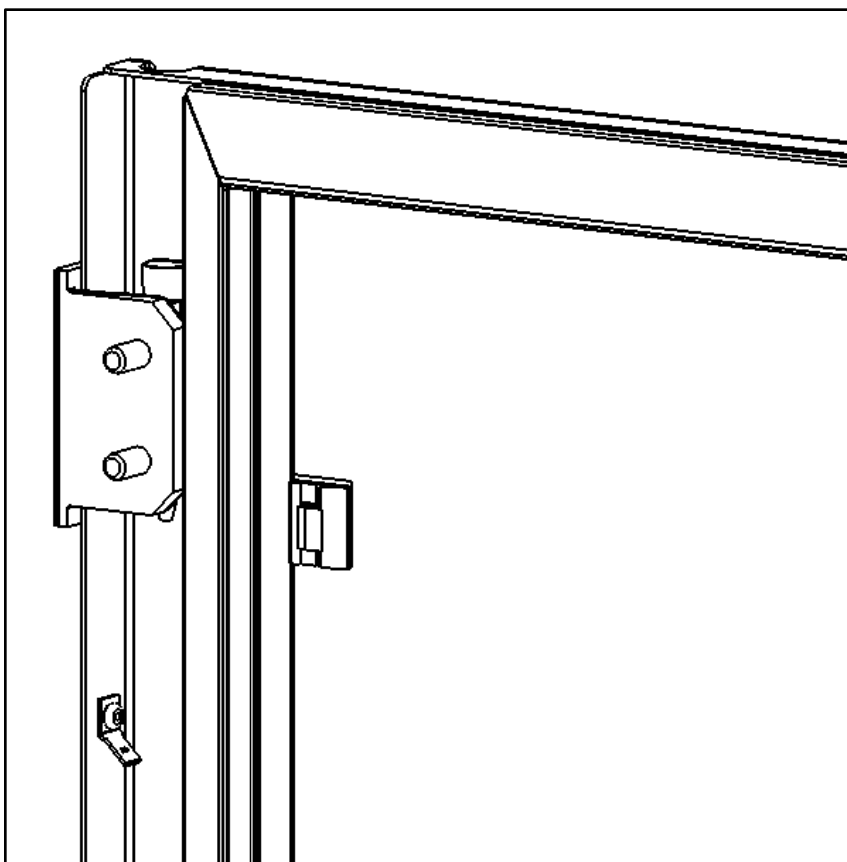
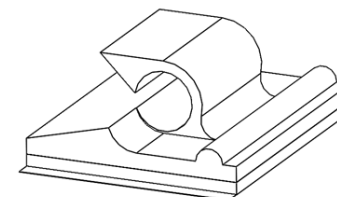

Installation Instructions

eConnect Electronic Access Control – Single, Solid Door with Gaskets

5. ROUTE WIRES BETWEEN LATCH & CAN BUS

4. Plug the lock cable into the “Lock” side of the CAN Bus Module
5. Use wire clips to guide cable around frame, avoiding pinch points
6. Check and confirm that there is enough slack to allow the door to fully open and close

To Latch

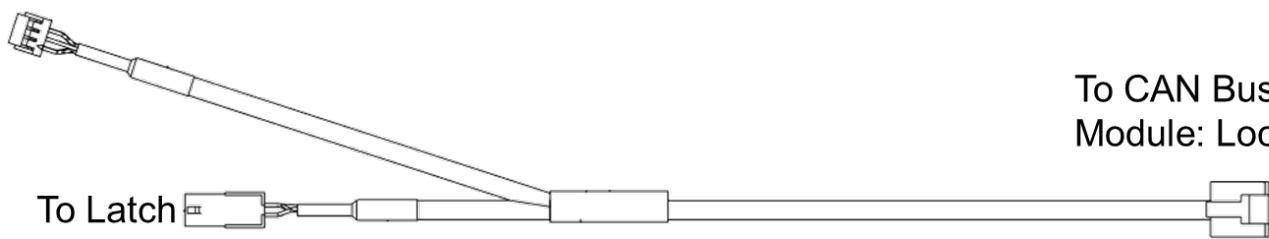

To CAN Bus
Module: Lock Side

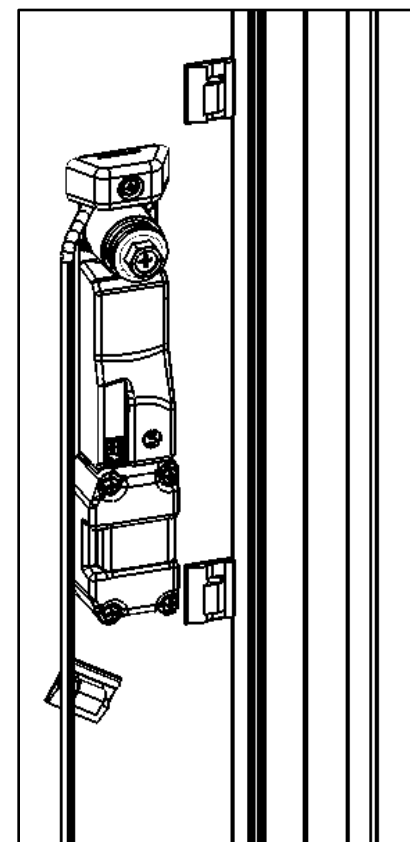

Installation Instructions

eConnect Electronic Access Control – Single, Solid Door with Gaskets

6. ROUTE WIRES BETWEEN SWITCH & CAN BUS

1. Insert wires into sensor switch
2. Route wire inside door frame using wire clips
3. Plug other end into CAN Bus Module –
(Check and confirm that there is enough slack to allow the door to fully open and close.)



SWITCH WITH WIRES
CONNECTED



SWITCH WIRE CONNECTOR

WIRE CLIP W/
ADHESIVE

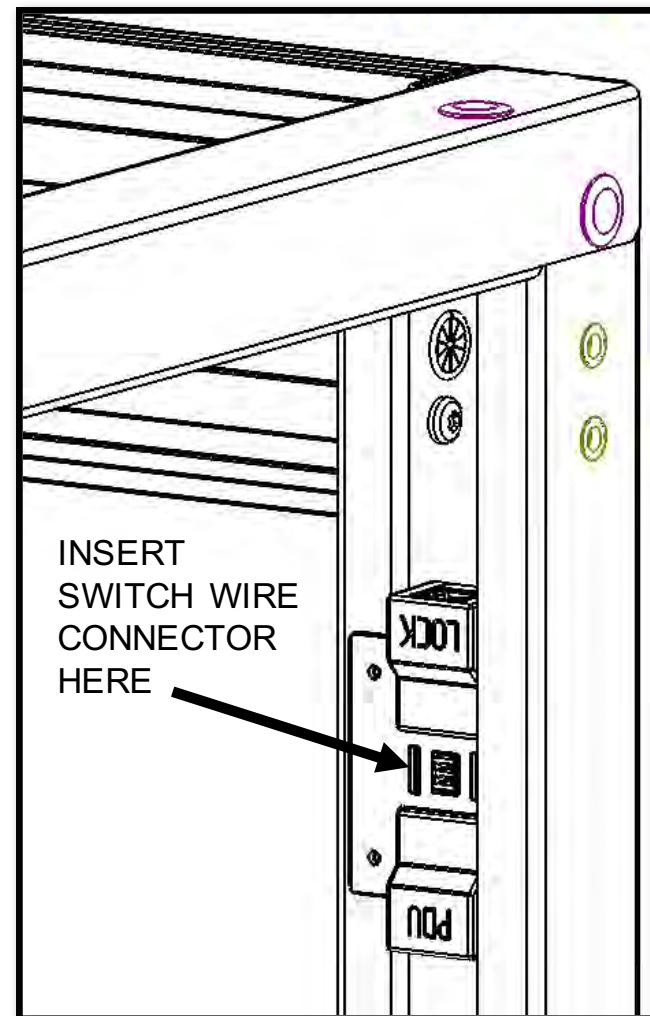
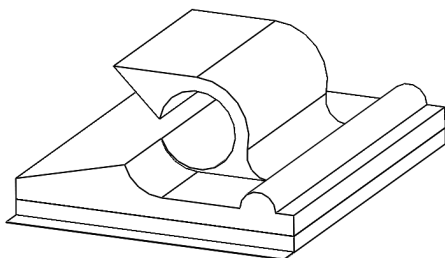

Installation Instructions

eConnect Electronic Access Control – Single, Solid Door with Gaskets

7. ROUTE WIRES BETWEEN CAN BUS MODULE & PDU

1. Plug cable into PDU side of CAN Bus Module
2. Route the cable through grommets
3. Plug into PDU
 1. Aux 1 is for the rear door switch/latch
 2. Aux 2 is for the front door switch/latch

GROMMET
(ROUTE WIRE
FROM CAN BUS
MODULE TO PDU)

