

Product Cut Sheet

AISLE CONTAINMENT CABINET TO FLOOR SEAL KIT FOR GF-SERIES GLOBALFRAME® GEN 1 CABINET

Aisle Containment Cabinet To Floor Seal Kits are used at the bottom of cabinets to seal the space between the bottom of the cabinet and the floor when leveling feet or casters are in use. Eliminating this source of bypass airflow is essential due to the high pressure typically experienced in this area.

- Compatible with GF-Series GlobalFrame® Gen 1 Cabinets (On GF-Series GlobalFrame Gen 1 Cabinets the leveling feet attach to a threshold under the door, and the top panel has cable knockouts and round grommets.)
- Blocks bypass airflow underneath cabinets to prevent leakage from the contained aisle
- Fits snug against cabinets and the floor
- Includes sheet steel covers
- Front and Side Seals are ordered separately
- Use one front seal kit on each cabinet; select to match the overall width of the cabinet
- Use one side seal kit on each cabinet row; select to match the depth of the cabinet/frame

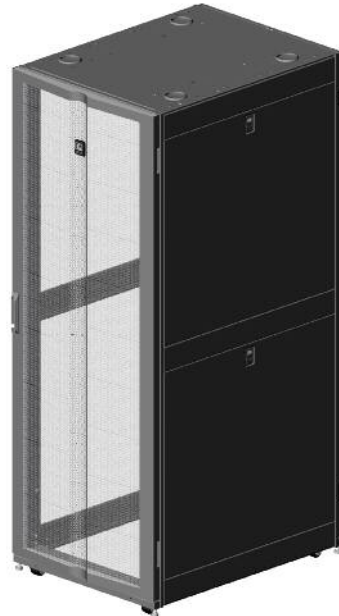

GF-Series GlobalFrame Gen 1 Cabinet

Cabinet To Floor Seal Kit For GF-Series GlobalFrame® Cabinet			
Part Number & Finish		Description	Shipping Weight lb (kg)
Black	Glacier White		
Front Seal Kits			
32810-700	32810-E00	For a 23.6"W (600 mm) Cabinet	3 (1.4)
32810-701	32810-E01	For a 29.5"W (750 mm) Cabinet	4 (1.8)
32810-702	32810-E02	For a 31.5"W (800 mm) Cabinet	4 (1.8)
Side Seal Kits			
32811-700	32811-E00	For a 31.5"D (800 mm) Cabinet Frame	5 (2.3)
32811-701	32811-E01	For a 39.4"D (1000 mm) Cabinet Frame	6 (2.7)
32811-702	32811-E02	For a 41.3"D (1050 mm) Cabinet Frame	6 (2.7)
32811-703	32811-E03	For a 47.2"D (1200 mm) Cabinet Frame	6 (2.7)

Note: Order Front and Side Seal Kits separately to match cabinet size. For Side Seal Kits, cabinet frame depth is the depth at the base of the cabinet. Overall cabinet depth (door to door) is approximately 1" (25 mm) deeper.

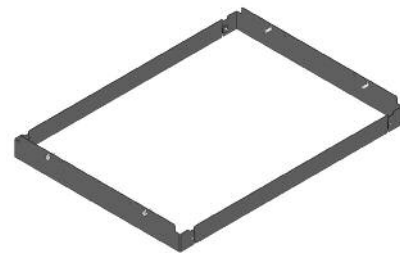

GF-Series GlobalFrame Gen 1 Cabinet
To Floor Seal Kits

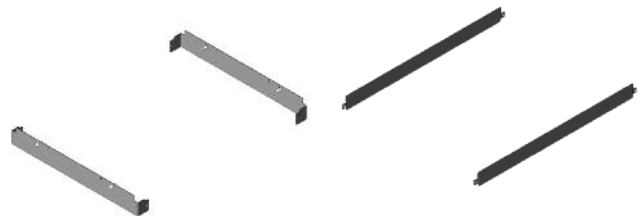

Front Seal Kit

Side Seal Kit

800-834-4969 in US & Canada • www.chatsworth.com



CHATSWORTH PRODUCTS

©2013 Chatsworth Products, Inc. All rights reserved. CPI, CPI Passive Cooling, GlobalFrame, MegaFrame, Saf-T-Grip, Seismic Frame, SlimFrame, TeraFrame, Cube-IT Plus, Evolution, OnTrac, Velocity and QuadraRack are federally registered trademarks of Chatsworth Products. eConnect and Simply Efficient are trademarks of Chatsworth Products. All other trademarks belong to their respective companies.