

# Installation Instructions

## GT-Series GlobalFrame Gen 2 Side Panels

### Intended Use

Install this rack only in a restricted service environment, such as a data center. Use indoors only, in environmentally controlled areas; do not use outdoors, in harsh environments or in air-handling spaces. Use this rack for computer equipment, including servers and peripherals. Allow only qualified service personnel to use this rack.

### Assembly Sequence

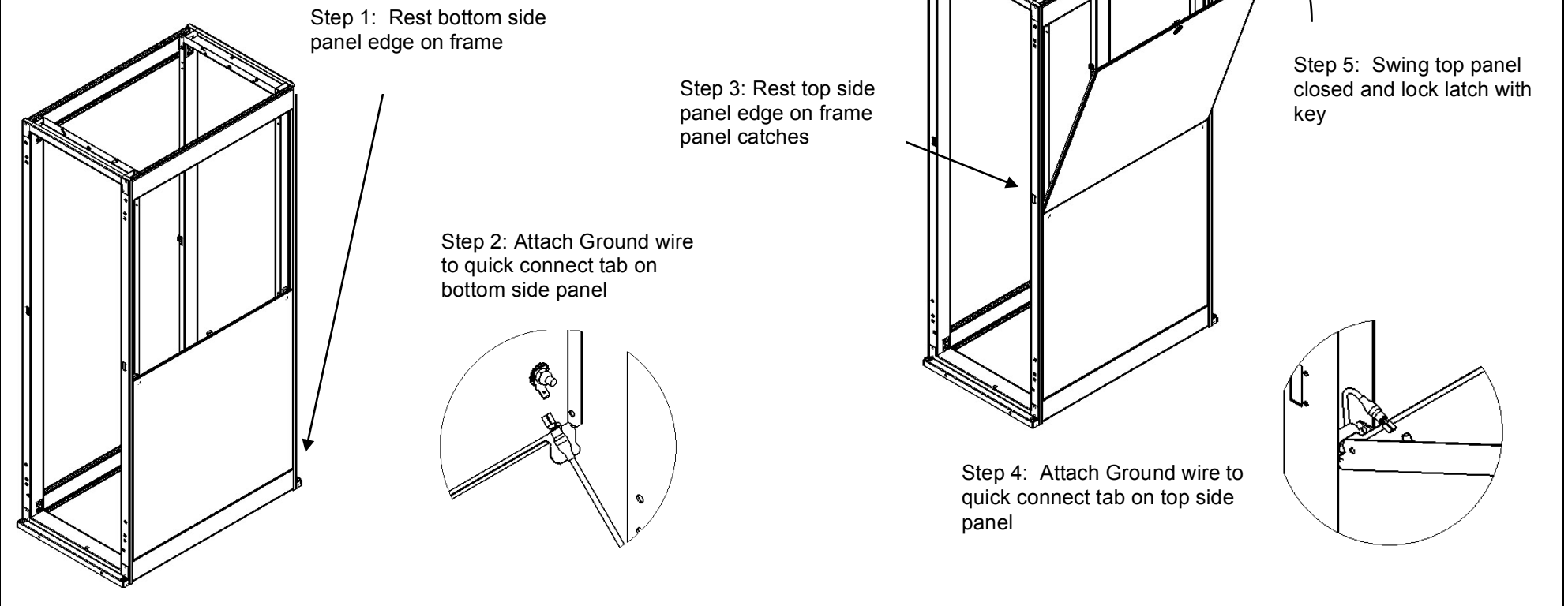

IIS-726330, 5/5/16, Rev. 1, CPI/MZ/JL  
800-834-4969 (USA & Canada) • [www.chatsworth.com](http://www.chatsworth.com) •  
[techsupport@chatsworth.com](mailto:techsupport@chatsworth.com)  
For international phone numbers, see our website or contact CPI Tech Support.

*This drawing contains proprietary and confidential information and is protected by U.S. and international law. Unauthorized reproduction, disclosure or use of the drawing or the information therein is expressly forbidden except as agreed to in writing by Chatsworth Products, Inc.*