

Installation Instructions

Cable Runway Mounting Bracket for Wireless Access Points

Safety Information



WARNING: Follow manufacturer's instructions for hand or power tools. Always use safety glasses. Failure to do so may result in injury and/or product damage.



WARNING: Use caution when working at elevated heights. Follow manufacturer's instructions for ladders and/or scaffolding. Failure to do so may result in injury or death.



WARNING: The bracket must be securely fastened to the cable runway and the access point must be securely fastened to the bracket. If the access point falls it may cause damage or injury.

Intended Use

Install this bracket only in a restricted service environment, such as a telecommunications closet or data center. Use indoors only, in environmentally controlled areas; do not use outdoors, in harsh environments or in air-handling spaces. Use this bracket to support a wireless access point only. Allow only qualified service personnel to use this bracket.

Included Hardware

- (1) Cable Runway Attachment Bracket
- (1) Right-Angle Access Point Bracket
- (1) T-Bar Bracket
- (4) #6-32 x 5/16" Screws (for attaching T-bar or other bracket)
- (2) M4 x 8 mm Screws (for attaching an Aruba Access Point)
- (1) Cable Tie (for securing network cables)

Tools Required

#2 Philips Head Screwdriver (to attach Access Point to right-angle bracket)

Assembly Sequence

The image at right shows assembly of the Cable Runway Mounting Bracket. Page 2 shows install on Cable Runway and attachment of the Access Point.

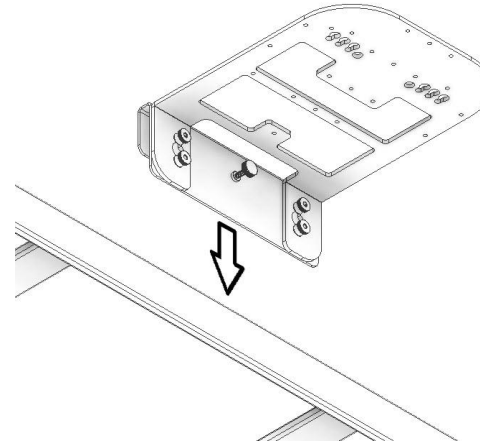

Assemble the bracket as shown and slip over the side stringer of the cable runway.

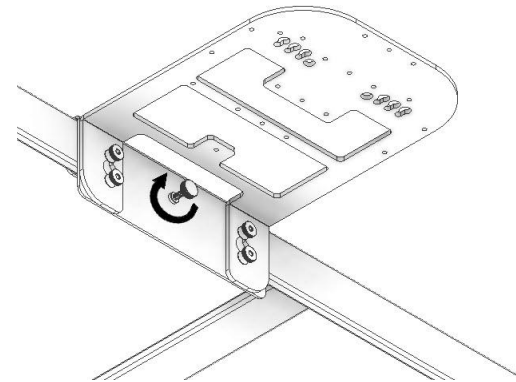

Turn the thumbscrew to secure the bracket on the cable runway. The right-angle bracket can be oriented as shown or flipped so it is slightly below the runway.



IIS-714350, 01/01/24, Rev. 1, CPI/Conklin/Knapp
800-834-4969 (USA & Canada) • www.chatsworth.com • techsupport@chatsworth.com
For international phone numbers, see our website or contact CPI Tech Support.

This drawing contains proprietary and confidential information and is protected by U.S. and international law. Unauthorized reproduction, disclosure or use of the drawing or the information therein is expressly forbidden except as agreed to in writing by Chatsworth Products, Inc.

Installation Instructions

Cable Runway Mounting Bracket for Wireless Access Points

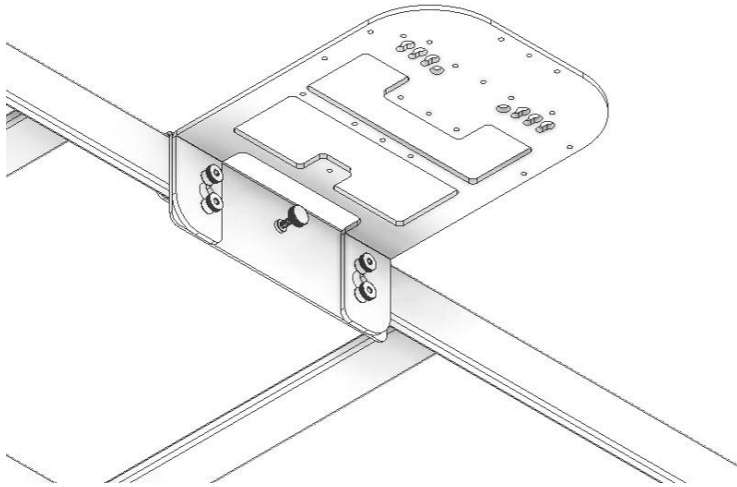

The right-angle bracket can be oriented as shown or flipped so that it is slightly below the cable runway. Loosen the four thumbscrews to remove and/or flip the bracket.

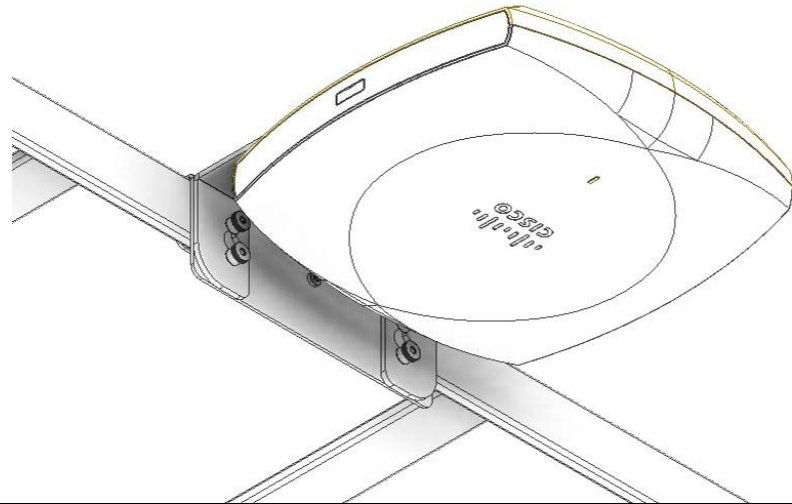

Install the access point (AP) using one of the methods below. The bracket has several mounting locations for various AP mounting brackets shown in the legend below.

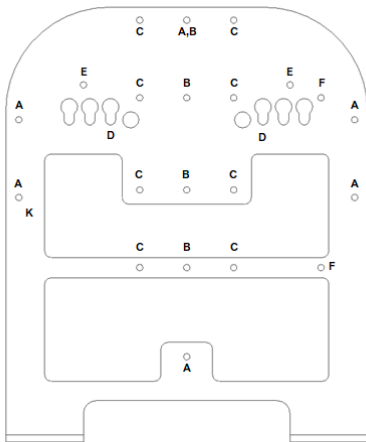

- A T-Bar Bracket
- B Single Gang Outlet Box
- C Double Gang Outlet Box
- D Aruba AP Direct Mounting
- E Meraki Mounting Plate
- F Single Gang Outlet Box for Meraki MA-MNT-MR-14 Mounting Plate

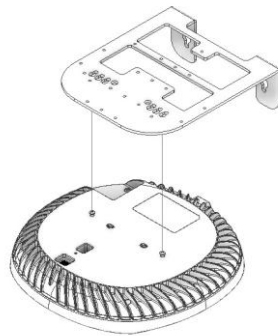

Attach HPE Aruba 5xx, 6xx and 7xx series Access Points directly to the right-angle bracket using the included M4 screws aligned to the correct group of keyholes at the front of the bracket.

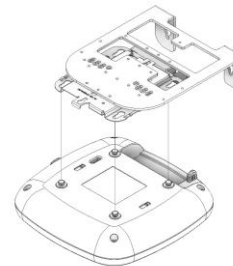

Attach Cisco 91xx series Access Points using the mounting bracket included with the Cisco AP. Use the included #6 screws to attach the Cisco bracket to the bottom of the right-angle bracket. Then snap the Cisco AP in place.

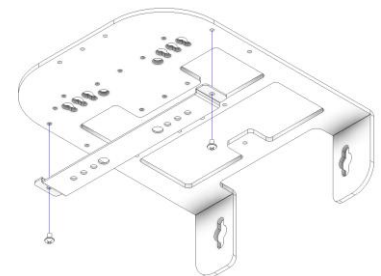

For other Access Points, attach the included T-bar bracket to the right-angle bracket using the included #6 screws. Use the T-bar bracket that is included with the AP to attach the AP to the T-bar and right-angle bracket.